

DOOR SCHEDULE

○ THESE SIZES MAY VARY SLIGHTLY, TOO TO VERIFY ACTUAL SIZES WITH MANUFACTURER PRIOR TO CONSTRUCTION.

EXTERIOR DOORS

SYM	SIZE	HARDWARE	TYPE	QTY.	REMARKS
1	6'-0" x 6'-8"	SET 1	FIBER	2	EXTERIOR/DOUBLE IMPACT RESIST.
2	3'-0" x 6'-8"	SET 1	FIBER	2	EXTERIOR/SINGLE IMPACT RESIST.

INTERIOR DOORS

SYM	SIZE	HARDWARE	TYPE	QTY.	REMARKS
3	3'-0" x 6'-8"	SET 2	WOOD	26	INTERIOR/PREHUNG

*USE IN COORDINATION WITH DOOR HARDWARE SCHEDULE
*ALL EXTERIOR DOORS TO BE 160 MPH IMPACT RATED

WINDOW SCHEDULE

○ THESE SIZES MAY VARY SLIGHTLY, GENERAL CONTRACTOR TO VERIFY ACTUAL SIZES WITH MANUFACTURER PRIOR TO CONSTRUCTION.

SYM	SIZE	TYPE	GLASS	QTY.	REMARKS
A	3'-0" x 5'-0"	A	MARBLE	20	VINYL AWNING.
B	5'-0" x 5'-0"	A	MARBLE	20	VINYL AWNING.

*ALL WINDOWS TO BE DELTA PANEL, LOWE AND 160 MPH IMPACT RESISTANT

DOOR HARDWARE SCHEDULE

SET 1	SET 2
(3) BUTT HINGES - N.R.P. (1) DOUBLE CYLINDER LOCK (1) THERMALLY BROKEN THRESHOLD (1) EXTERIOR SWEEP EXTERIOR HARDWARE TO BE STAINLESS STEEL	(3) BUTT HINGES - N.R.P. (1) PRIVACY SET W/ LEVER HANDLE (1) SCHLAGE JUPITER POLISHED CHROME (1) WALL STOP (1) CLOSER

*USE THIS TABLE IN COORDINATION WITH DOOR SCHEDULE
*NSP INDICATES NON-REMOVABLE PIN

WALL LEGEND

- 8" CMU BLOCK WALL W/ 1/2" GYP. INT., STUCCO EXT. INSTALL #5 REBAR VERTICAL FROM FOUNDATION TO HORIZONTAL TIE BEAM AT 6" O.C. @ 1 STORY, 4" O.C. @ 2 STORY TYPICAL AT ALL CORNERS, EACH SIDE OF OPENINGS, AND BELOW GIRDER TRUSSES
- 2X4 FRAME INT WALL W/ 1/2" GYP. EA, SIDE
- 2X6 FRAME FIREWALL W/ 1/2" GYP. EA, SIDE TYP.
- 16" SQ. CMU COLUMN W/ (4) #5 VERT. REBAR, FILL CELLS W/ GROUT, (COL 1)

*ALL FINISHES BY OWNER (STYLE, TYPE, COLOR)

GENERAL NOTES

- ALL FURNITURE, FIXTURES, AND EQUIPMENT (F/T/E) TO BE PROVIDED BY OWNER.
- CONTRACTOR TO INSTALL ALL F.P.F.
- WALL AND CEILING MATERIALS SHALL NOT EXCEED THE FLAME SPREAD CLASSIFICATIONS.
- PERMITS AND MEMBERSHIP PENETRATION FIRE STOPS IN ACCORDANCE WITH IBC SECTION 714.
- LATCHING OR LOCKING DOORS IN A PATH OF TRAVEL ARE OPERATED WITH A SINGLE EFFORT BY LEVER TYPE HARDWARE, PUSH OR PULL AND LEVER TYPE BARS OR OTHER HARDWARE DESIGNED TO PROVIDE PASSAGE WITHOUT REQUIRING THE ABILITY TO GRASP THE OPENING HARDWARE, PER 11B-404.2.1.
- MAXIMUM EFFORT TO OPERATE DOORS SHALL NOT EXCEED 5 POUNDS, WITH SUCH PUSH OR PULL EFFORT BEING APPLIED AT RIGHT ANGLES TO HINGED DOORS AND AT THE CENTER PLANE OF SLIDING OR ROLLING DOORS. FIRE DOORS SHALL NOT EXCEED 15 POUNDS, SECTION 11B-404.2.2.
- LOWER 1/2 OF ALL DOORS SHALL COMPLY WITH SECTION 11B-404.2.10 AS FOLLOWS:
A) TO BE SMOOTH AND UNINTERRUPTED, TO ALLOW THE DOOR TO BE OPENED BY A WHEELCHAIR FOOTREST WITHOUT CREATING A TRAP OR HAZARDOUS CONDITION.
B) NARROW FRAME DOORS MAY USE A 1" HIGH SMOOTH PANEL ON THE PUSH SIDE OF THE DOOR.
- TOP OF DINING TABLES AND WORK STATIONS TO BE AT 32" A.F.F.

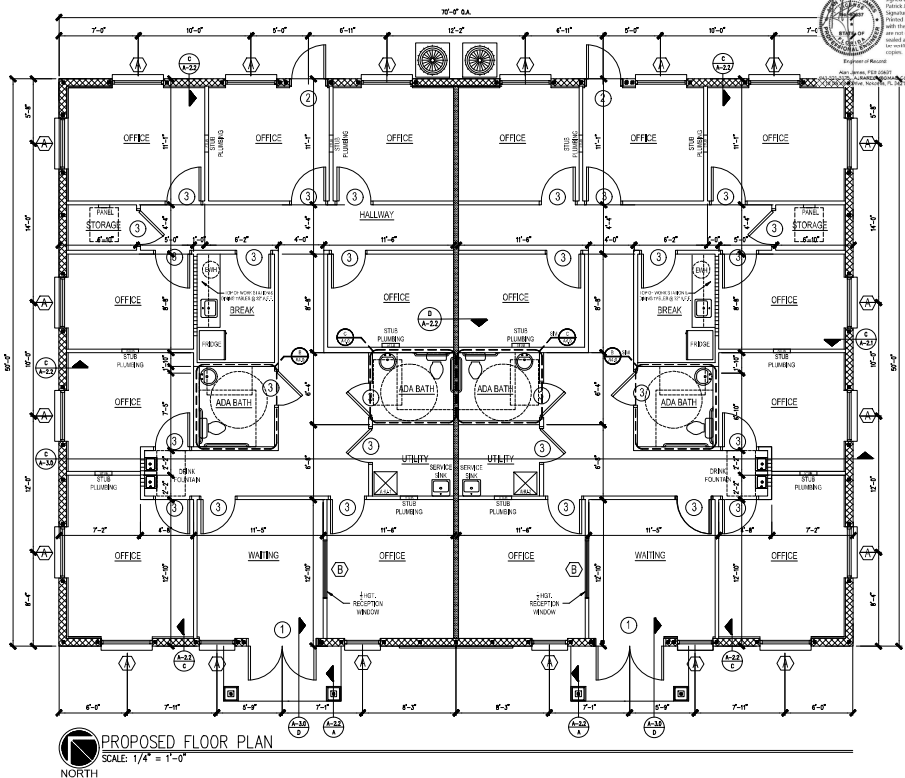

FLOOR PLAN NOTES

- INSTALL NEW TANKLESS WATER HEATER UNDER SINK IN BREAK ROOM FOR BOTH TENANT SPACES - TYP.
- INSTALL (2) NEW 100A 120/240V SINGLE PHASE PANELS - ONE PER TENANT SPACE - TYP.
- INSTALL NEW WASH/DRYER AS INDICATED.
- INSTALL NEW FIREWALL BETWEEN TENANT SPACES - SEE DETAIL 'D' ON SHEET A-0.1.
- ALL BATHROOM FIXTURES AND PARTS TO HAVE REQUIRED ADA CLEARANCES, SEE CHANGED BATHROOM PLANS ON SHEET A-0.2.
- PROVIDE ADA ACCESSIBLE SERVICE SINK AND DRINKING FOUNTAINS WITH REQUIRED CLEARANCES IN BOTH TENANT SPACES.
- PROVIDE REQUIRED CLEARANCES AT AIR HANDLERS AND ELECTRICAL PANELS.
- AIR HANDLER IS TO BE MOUNTED ABOVE CEILING IN TENANT SPACE.

This floor plan has been electronically signed and sealed by Alan James PE. Printed copies of this document are not considered signed and sealed and the digital version on mySeal.com is the only valid version.

Engineer of Record

Alan James PE, P.E.

ALAN JAMES PE
State of Florida #83637
(941) 321-3775
Nokomis, Florida 34275
ajames64@gmail.com



NEW COMMERCIAL OFFICE BUILDING
COLLIER #13
23104 TABAK LANE
LAND O' LAKES, FL 34639

APPROVAL

APPROVED PROJECT TO:

☐ SEB/DEVELOPMENT

☐ CONSTRUCTION DOCUMENTS

Date:

Approved Signature:

Printed Name:

CONSULTANTS:

DRAWINGS
CONSTRUCTION
DOCUMENTS

Revisions:

No. Date Description

SCALE
AS NOTED

DRAWN BY: ALJH

CHECKED BY: KJT

SHEET DATE: FEB 01, 2025

SHEET TITLE:
PROPOSED FLOOR PLAN

SHEET NUMBER

A1.0