

15301 – 15311 W. MCNICHOLS RD.  
DETROIT, MICHIGAN



**SIGNATURE  
ASSOCIATES**  
KNOW SIGNATURE | KNOW RESULTS

MEDICAL FOR SALE  
4,804 Square Feet Available



## PROPERTY FEATURES

- 4,804 square feet available
- Existing dental office
- Modern facility with many updates
- Zoned B2
- Sale Price: \$250,000 (\$52.04/sq. ft.)

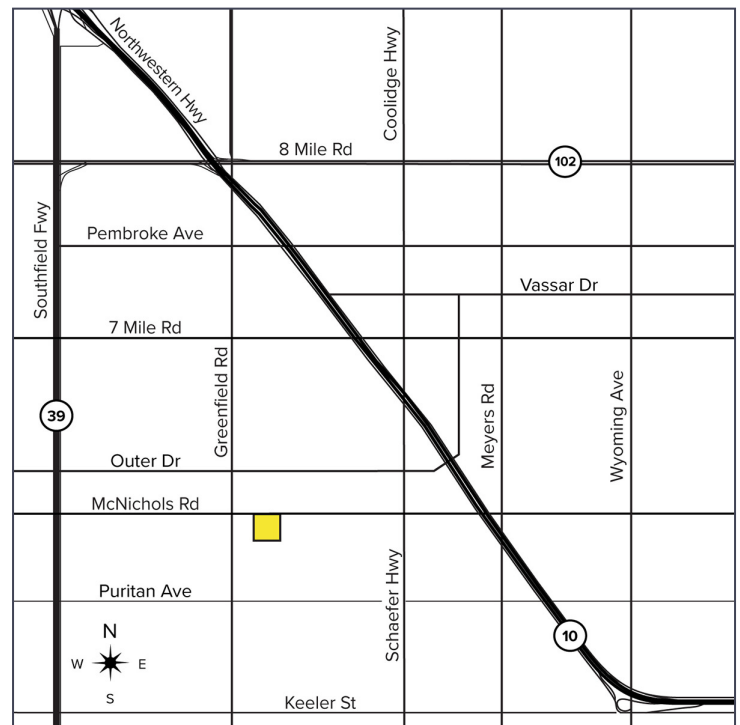

For more information, please contact:

**JOE STACK**  
(248) 359 0615  
jstack@signatureassociates.com

**CHRIS MONSOUR**  
(248) 948 0107  
cmonsour@signatureassociates.com

**SIGNATURE ASSOCIATES**  
One Towne Square, Suite 1200  
Southfield, MI 48076  
www.signatureassociates.com

# 15301 – 15311 W. McNichols Rd. – Detroit, Michigan

## Medical For Sale

4,804  
Square Feet  
AVAILABLE

### Site Plan

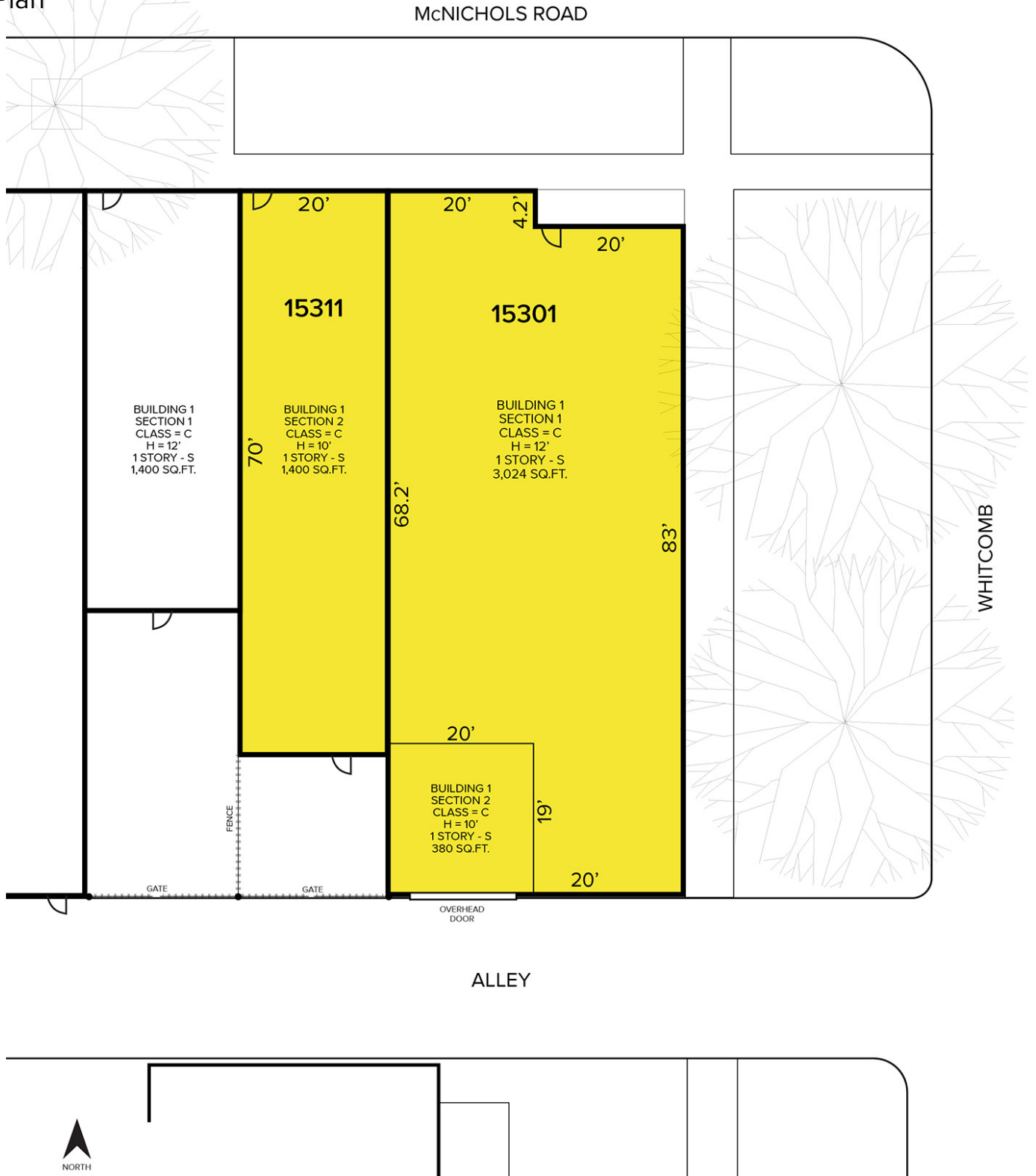

For more information, please contact:

**JOE STACK**  
(248) 359 0615  
jstack@signatureassociates.com

**CHRIS MONSOUR**  
(248) 948 0107  
cmonsour@signatureassociates.com

**SIGNATURE ASSOCIATES**  
One Towne Square, Suite 1200  
Southfield, MI 48076  
www.signatureassociates.com

# 15301 – 15311 W. McNichols Rd. – Detroit, Michigan

Medical For Sale

4,804  
Square Feet  
AVAILABLE

Aerial

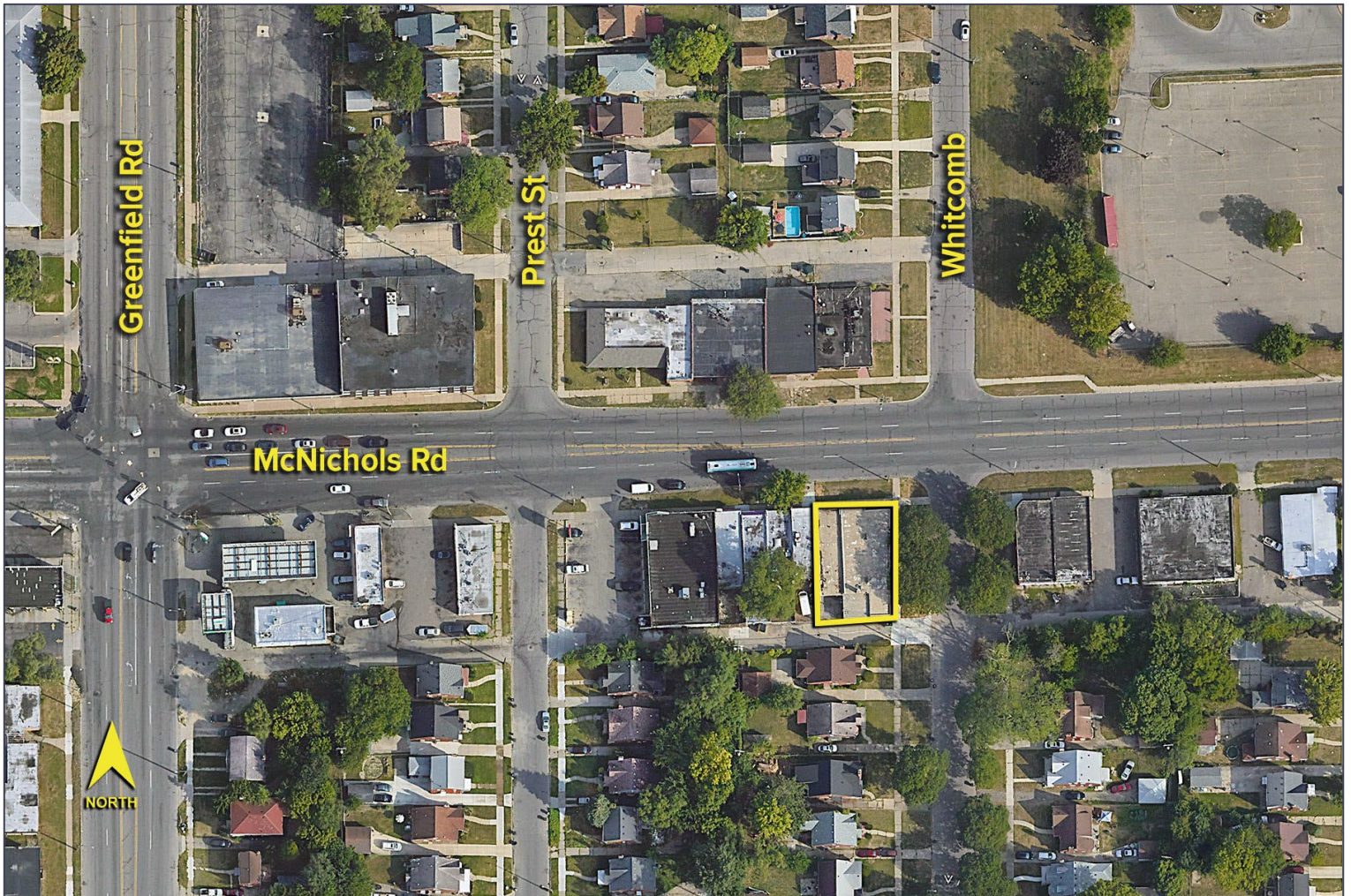

For more information, please contact:

**JOE STACK**  
(248) 359 0615  
jstack@signatureassociates.com

**CHRIS MONSOUR**  
(248) 948 0107  
cmonsour@signatureassociates.com

**SIGNATURE ASSOCIATES**  
One Towne Square, Suite 1200  
Southfield, MI 48076  
www.signatureassociates.com