

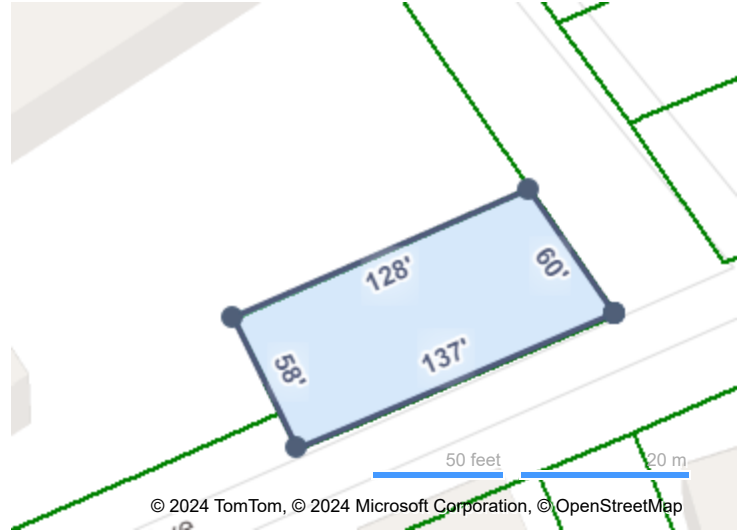



Next



LOCATION

Property Address	603 Unaka St Knoxville, TN 37921	
Subdivision	Clotworthy & Kinzel Resub	
County	Knox County, TN	

GENERAL PARCEL INFORMATION

Parcel ID/Tax ID	094KV013
Alternate Parcel ID	86164
Account Number	
District/Ward	City Of Knoxville
2020 Census Trct/Bik	70/2
Assessor Roll Year	2023

PROPERTY SUMMARY

Property Type	Open Space
Land Use	Unused Land
Improvement Type	
Square Feet	

CURRENT OWNER

Name	Mdt Construction LLC
Mailing Address	9753 Brentwood Brentwood, TN 37027

SCHOOL ZONE INFORMATION

Maynard Elementary School	0.3 mi
Elementary: K to 5	Distance
Bearden Middle School	5.6 mi
Middle: 6 to 8	Distance
West High School	2.3 mi
High: 9 to 12	Distance

SALES HISTORY THROUGH 04/19/2024

Date	Amount	Buyer/Owners	Seller	Instrument	No. Parcels	Book/Page Or Document#
7/22/2022		Mdt Construction	Al Sisi Construction Inc	Quit Claim Deed		202208020007640
12/20/2017	\$22,000	Al Sisi Constructions Inc	Delius Robert	Warranty Deed		201712220038578
2/1/2001		Delius Robert	Delius Earl	Quit Claim Deed		200102010049923
5/17/2000		Delius Earl	Thomas Geneva	Quit Claim Deed		200005170033169
2/15/1991		Thomas Geneva	Thomas Geneva	Warranty Deed		2031/1061
7/5/1989		Thomas Geneva	Thomas Geneva	Warranty Deed		1981/1085
8/10/1945		Thomas Geneva	Thomas Geneva	Warranty Deed		694/286

TAX ASSESSMENT

Appraisal	Amount	Assessment	Amount	Jurisdiction	Rate
Appraisal Year	2023	Assessment Year	2023	City Of Knoxville	2.1556
Appraised Land	\$42,600	Assessed Land		Knox County	1.554
Appraised Improvements		Assessed Improvements			

Total Tax Appraisal	\$42,600	Total Assessment	\$17,040
		Exempt Amount	
		Exempt Reason	

TAXES

Tax Year	City Taxes	County Taxes	Total Taxes
2023	\$367.31	\$264.80	\$632.11
2022	\$367.31	\$264.80	\$632.11
2021	\$76.38	\$65.72	\$142.10
2020	\$76.38	\$66.00	\$142.38
2019	\$76.38	\$66.00	\$142.38
2018	\$76.38	\$66.00	\$142.38
2017	\$76.38	\$66.00	\$142.38
2016	\$84.50	\$72.00	\$156.50
2015	\$84.50	\$72.00	\$156.50
2014	\$84.50	\$71.92	\$156.42
2013	\$73.96	\$71.92	\$145.88

MORTGAGE HISTORY

Date	Loan Amount	Borrower	Lender	Book/Page or Document#
07/22/2022	\$990,000	Mdt Construction LLC	Builtwell Bank	202208020007641
03/19/2001	\$30,000	Delius Robert M	Bankfirst	200103190061249

PROPERTY CHARACTERISTICS: BUILDING

No Buildings were found for this parcel.

PROPERTY CHARACTERISTICS: EXTRA FEATURES

No extra features were found for this parcel.

PROPERTY CHARACTERISTICS: LOT

Land Use	Unused Land	Lot Dimensions	59.81 X 136.64 X IRR
Block/Lot	/35R	Lot Square Feet	7,797
Latitude/Longitude	35.965297°/-83.939277°	Acreage	0.179

PROPERTY CHARACTERISTICS: UTILITIES/AREA

Gas Source	Gas	Road Type	
Electric Source		Topography	
Water Source	Water	District Trend	
Sewer Source	Sewer	Special School District 1	
Zoning Code	C-G-1	Special School District 2	
Owner Type			

LEGAL DESCRIPTION

Subdivision	Clotworthy & Kinzel Resub	Plat Book/Page	20220503/83454
Block/Lot	/35R	District/Ward	City Of Knoxville
Description	Subdivisionname Clotworthy & Kinzel Pts 34,35 & 36 Mapplatb 3 Mapplatp 129 Dimensions 59.81 X 136.64 X Irr		

FEMA FLOOD ZONES

Zone Code	Flood Risk	BFE	Description	FIRM Panel ID	FIRM Panel Eff. Date
X	Minimal		Area of minimal flood hazard, usually depicted on FIRMs as above the 500-year flood level.	47093C0279G	08/05/2013