

8606-8622
ARGENT STREET

SANTEE, CA 92071

FOR LEASE | ARGENT BUSINESS PARK
±803 SF TO ±1,482 SF WAREHOUSE / OFFICE SUITES



Nick Mane | Lic. 01939391
Associate Vice President
(760) 840-7140
Nick@PacificCoastCommercial.com

Jasmine Golia | Lic. 02131001
Sales & Leasing Associate
(858) 337-7311
Jasmine@PacificCoastCommercial.com

Pacific Coast Commercial | Lic. 01209930
(619) 469-3600
10721 Treena Street, Ste 200
San Diego, CA 92131
www.PacificCoastCommercial.com

**PACIFIC COAST
COMMERCIAL**
SALES - MANAGEMENT - LEASING

The information contained herein has been given to us by the owner of the property or other sources we deem reliable, we have no reason to doubt its accuracy, but we do not guarantee it. All information, including zoning and use, should be verified prior to transaction.

ARGENT BUSINESS PARK

SUITE B

AVAILABILITY

8606 Argent, Suite B
± 1,171 Square Feet

- Warehouse (2), Office(s), Private Restroom and 1 Roll-Up Door
- Lease Rate: \$2,500- \$2,300/Month (Including Base Rent + NNN)

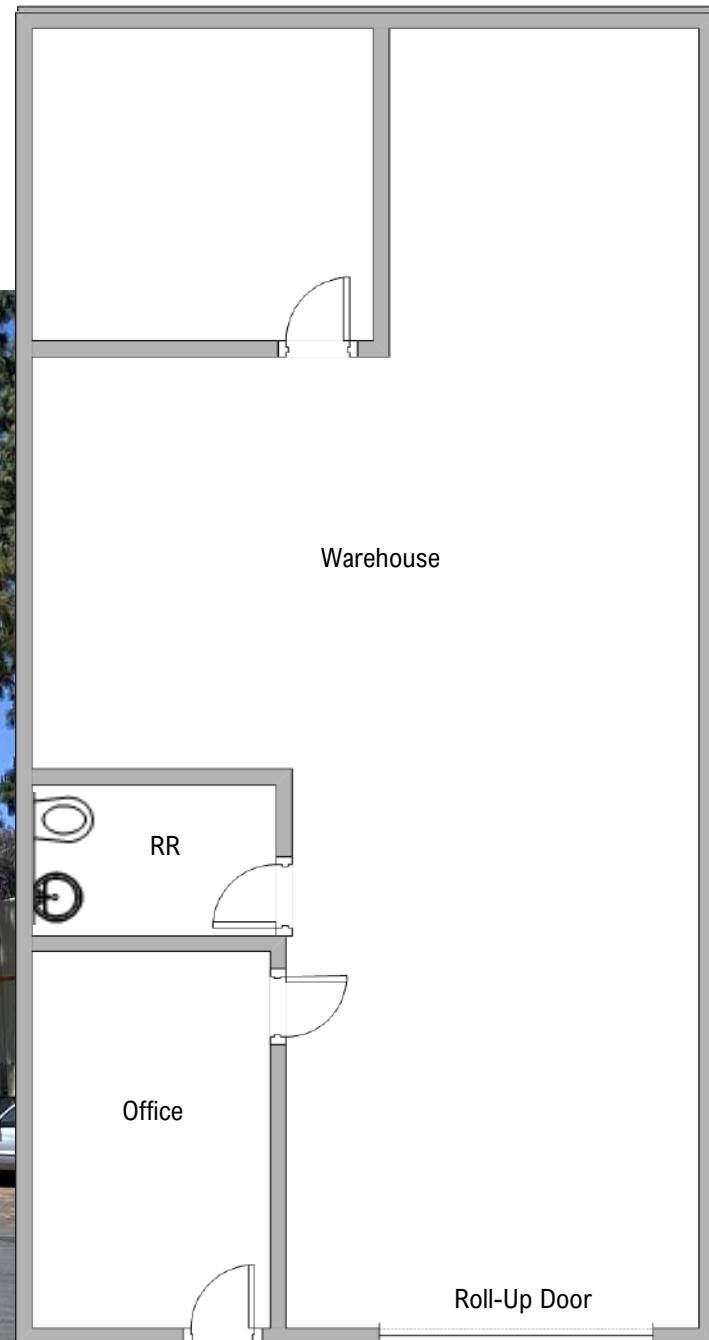

Floor Plan Not Fit to Scale; for Reference Purposes Only.

ARGENT BUSINESS PARK

SUITE D

AVAILABILITY

8606 Argent, Suite D
± 1,152 Square Feet

- Office / Reception Area, Private Restroom, Warehouse and 1 Roll-Up Door
- Lease Rate: \$2,300/Month
(Including Base Rent + NNN)

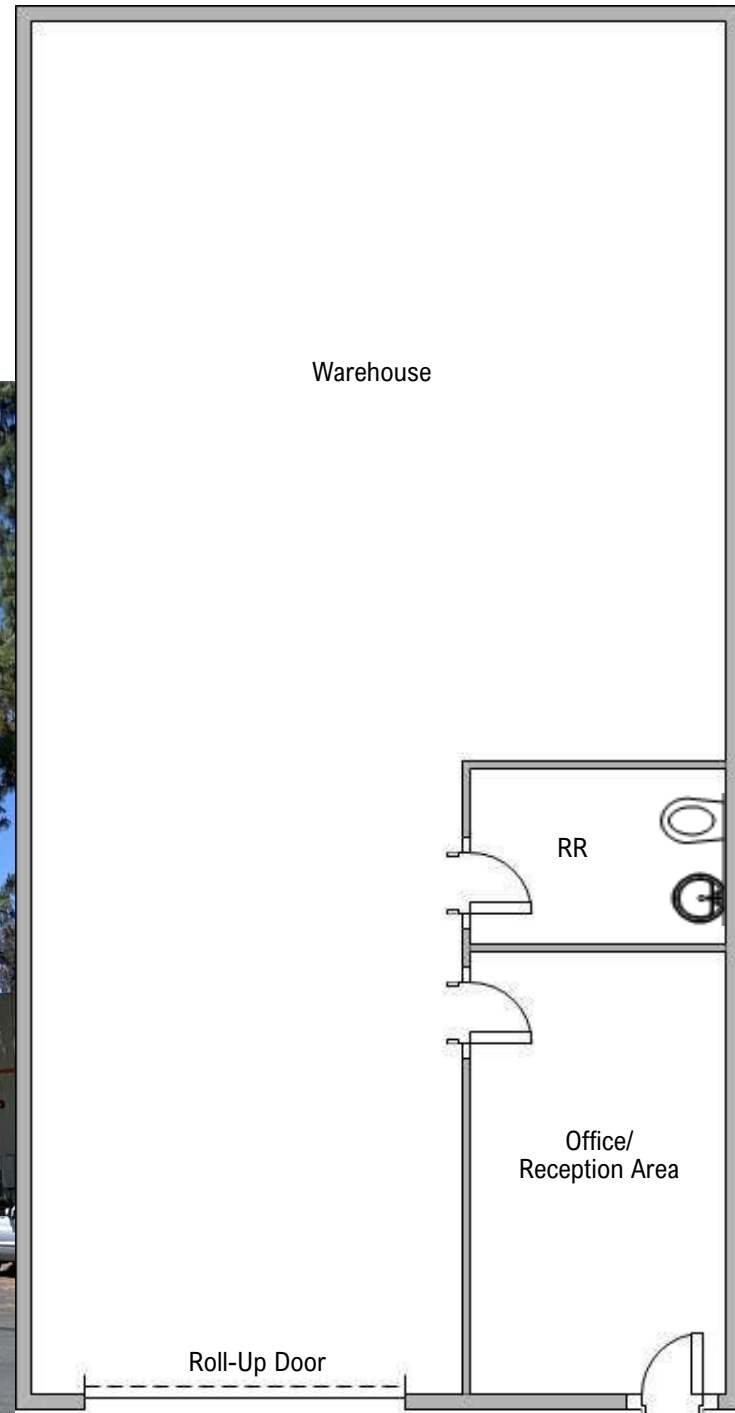

Floor Plan Not Fit to Scale; for Reference Purposes Only.

ARGENT BUSINESS PARK

SUITE A

AVAILABILITY

8614 Argent, Suite A
± 803 Square Feet

- 1 Private Office, Warehouse, Private Restroom and 1 Front Loading Roll-Up Door
- Lease Rate: \$1,700- \$1,600/Month (Including Base Rent + NNN)
- Available January 1, 2025

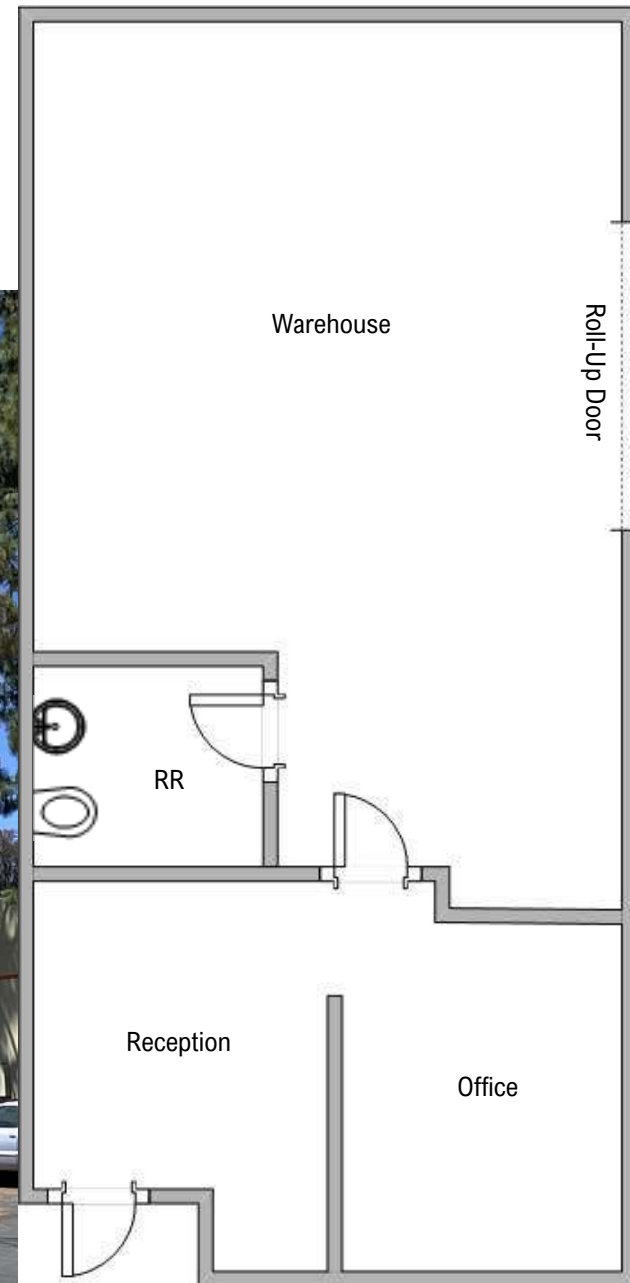

ARGENT BUSINESS PARK

SUITE A

AVAILABILITY

8622 Argent, Suite A
± 1,482 Square Feet

- 1 Private Office, Warehouse, Private Restroom and 1 Roll-Up Door
- Lease Rate: \$2,850/Month
(Including Base Rent + NNN)

