

95 INIP DRIVE

INWOOD LOGISTICS CENTER @ JFK AIRPORT
INWOOD, NY



95 INIP DRIVE
89,305 SF AVAILABLE

95 INIP DRIVE
LEASED

PROPERTY SPECIFICATIONS

95 INIP DRIVE

BUILDING SIZE:	137,390 SF
AVAILABLE SF:	89,305 SF (Divisible)
LOADING DOCKS:	5 Docks
DRIVE-IN DOORS:	1 Drive-in
COLUMN SPACING:	30' x 25'
POWER:	800 Amps
OCCUPANCY DATE:	Immediate

SUITES CAN BE COMBINED OR LEASED SEPARATELY

AVAILABLE SUITE C SF:	25,868 SF
CEILING HEIGHT:	15'5"
LOADING DOCKS:	2 Docks
AVAILABLE SUITE D SF:	63,437 SF
CEILING HEIGHT:	15'5" - 24'
LOADING DOCKS:	3 Docks
DRIVE-IN DOORS:	1 Drive-In



Flexibility and
Optionality



Previously Bonded
Warehouse Facility



Upgraded Lighting
and Interior Paint



Corporate Image
Within Planned
Industrial Park



Access to 9.7M
Residents Within 15 mi



Prime Long Island
Location, JFK
Adjacent

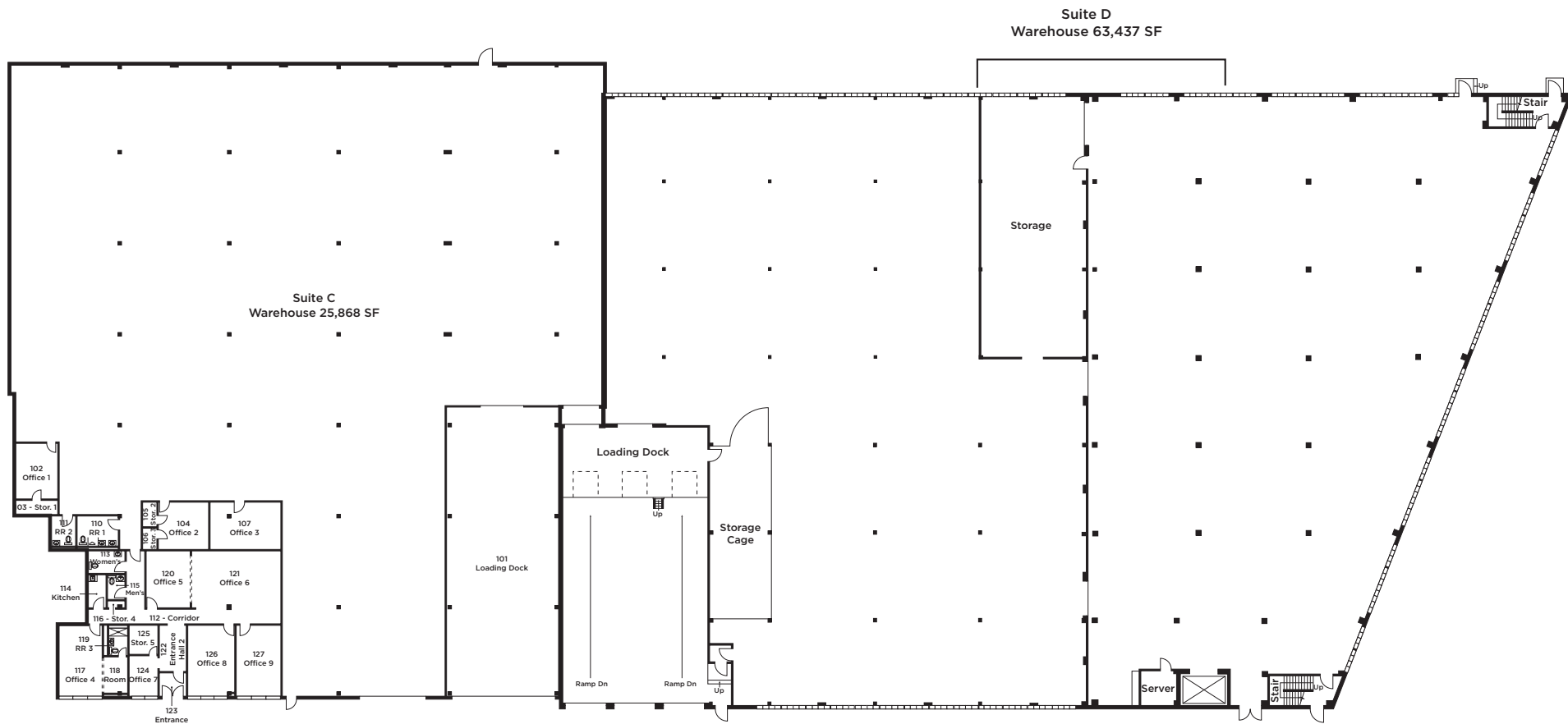

FLOORPLANS

FOR MORE INFORMATION,
CONTACT:

HELEN M. PAUL
 +1 212 841 7575
 helen.paul@cushwake.com

RICO T. MURTHA
 +1 212 390 1368
 rico.murtha@cushwake.com

THOMAS DELUCA
 +1 631 425 1237
 thomas.deluca@cushwake.com

SONNY SINGH
 +1 718 275 5478
 sonny.singh@cushwake.com

JOE HENTZE JR.
 +1 718 512 2100
 joe.hentze@cushwake.com

JOHN GIANNUZZI
 +1 631 425 1228
 john.giannuzzi@cushwake.com

DAVID FRATTAROLI
 +1 516 859 6396
 david.frattaroli@cushwake.com



VIEW PROPERTY
 WEBSITE [HERE](#)

