

6116 Executive Blvd

Rockville MD, 20852

4,737 RSF available for sublease

Term through January 31, 2028



Amanda Davis

Senior Managing Director

+1 909 467 6857

amanda.davis@jll.com

jll.com



BUILDING KEY PLAN

Suite 125
4,737 RSF

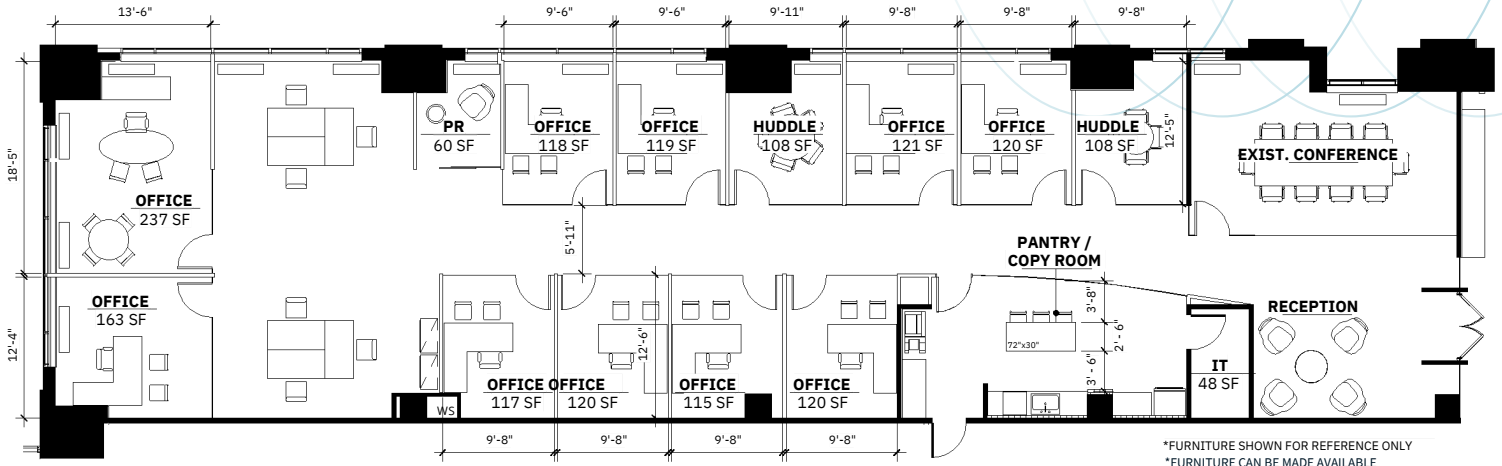

*FURNITURE SHOWN FOR REFERENCE ONLY
*FURNITURE CAN BE MADE AVAILABLE



FIRST-CLASS ON SITE AMENITIES INCLUDING:

Conference Facility

- 3 Meeting Spaces for 15, 38, and 65 Guests
- Wi-Fi Connectivity
- Multiple USB Charging Stations
- Catering Pantry
- Private Telephone Booth
- Smart TVs with HDMI Ports
- Breakout, Lounge, and Meeting Spaces are All Reservable

The spacious, business-ready Conference Center features Wi-Fi throughout, as well as a Coffee Bar and Catering Pantry.



Fitness Center

- Peloton Bikes, Treadmills, and Weightlifting Equipment
- Yoga Studio
- Virtual Classes on Touch Screen TV
- Locker Rooms
- Private Showers
- Secure, 24-hour Key Card Access
- Separate Exterior Entrance

Our state-of-the-art Wellness Center feels like a retreat — but it's located right in the building, steps away from your office

Tenant-Only Terrace

- Easily converts to One Large INdoor/Outdoor Space
- Climate Controlled, Three Season Comfort
- Wet Bar and Kitchen
- Smart TV with HDMI Ports
- Wi-Fi Connectivity and Multiple USB Ports
- Exclusively for Tenants
- Reservable for Tenant Events

Catch an inning, a game, or the day's headlines — or a bit of sunshine and fresh air — while enjoying the Terrace.





Amanda Davis
Senior Managing Director
+1 909 467 6857
amanda.davis@jll.com