

MATANKY
REALTY GROUP

7.3 ACRE PARCEL, I-57/I-294

FOR SALE OR BULD TO SUIT
OFF OF I-57
14710 DIXIE HWY - HARVEY, IL 60469



105,000 VPD

147th St.

34,000 VPD

18,000 VPD

Dixie Hwy.

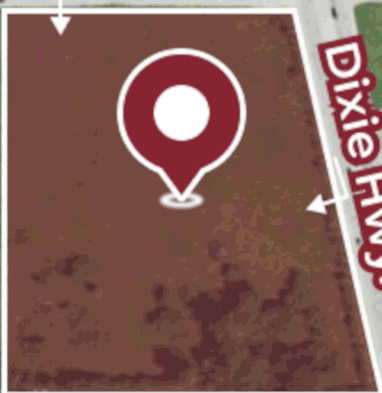

CAR
WASH



CONTACT US

TERRI COX
312-337-1001
TCOX@MATANKY.COM

MATANKY REALTY GROUP
200 N. LASALLE ST., ST 2350
312-337-1001
MATANKY.COM

An extraordinary 7.3-acre parcel located at the intersection of four municipalities: Harvey, Markham, Posen, and Dixmoor. This premium site offers remarkable visibility from I-57, capturing the attention of 105,000 vehicles passing daily, and benefits from convenient access via Dixie Highway.

Only 1.5 miles from the new Amazon center, which employs 2,000 people, the parcel also neighbors the Castle Car Wash project, a major development initiated in the spring of 2023. A bustling commercial hub complements the location, with significant co-tenants including McDonald's, BP, ALDI, Domino's, Cricket Wireless, Family Dollar, Dunkin' Donuts, Thorntons, Dollar General, O'Reilly Auto Parts, Wendy's, and Checkers.

Prospective owners can negotiate city incentives, and concept site plans are available. Make your business ambitions a reality at this strategically located and highly potential land parcel.

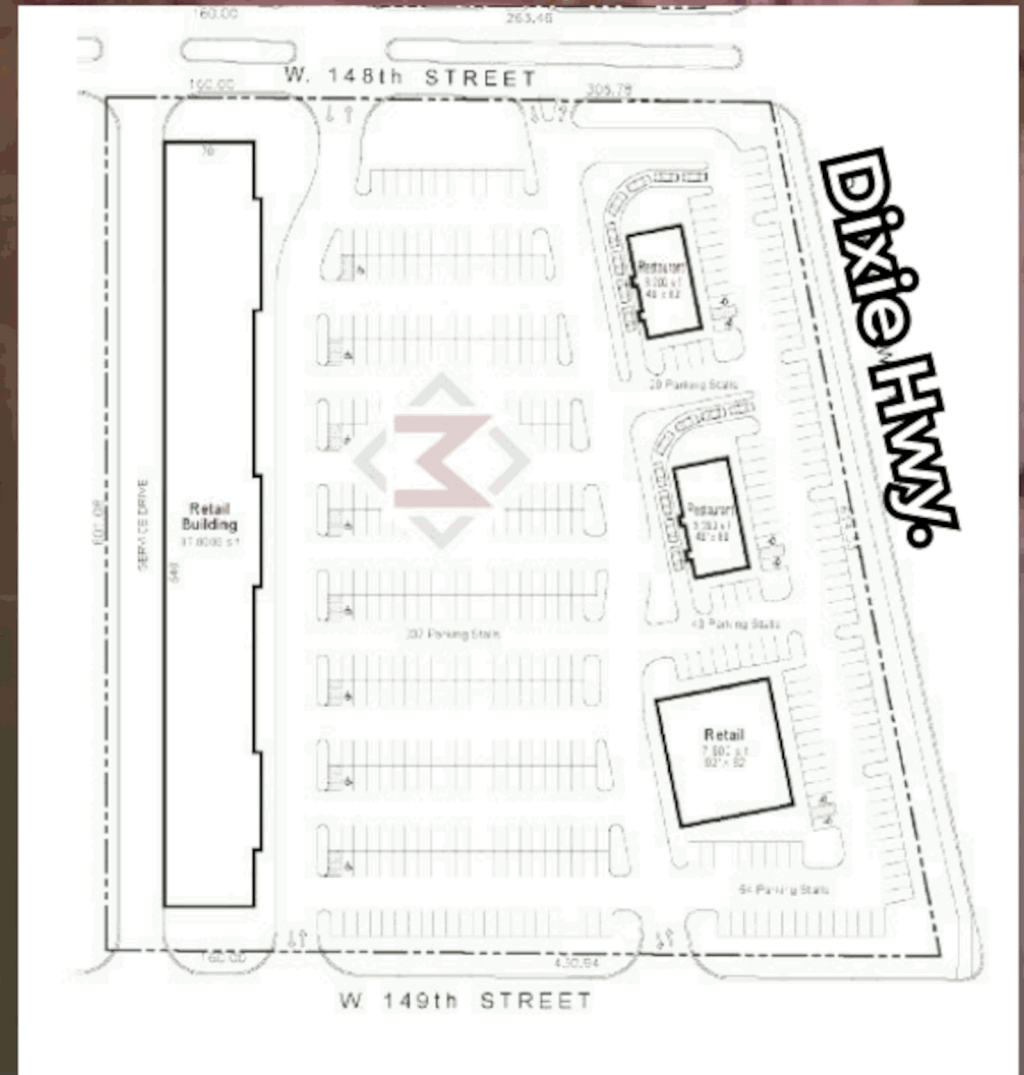

CONTACT US

TERRI COX
312-337-1001
TCOX@MATANKY.COM

MATANKY REALTY GROUP
200 N. LASALLE ST., ST 2350
312-337-1001
MATANKY.COM



DEMOGRAPHICS

1 MILE

2 MILE

3 MILE

PROPERTY FEATURES

POPULATION

12,110

94,842

282,959

PRICE

\$2,150,000

OF HOUSEHOLDS

3,750

31,196

100,178

LOCATION

SWC OF DIXIE HIGHWAY AND 148TH ST.

AVERAGE HH INCOME

\$51,310

\$58,436

\$69,763

CONTACT US

TERRI COX
312-337-1001
TCOX@MATANKY.COM

MATANKY REALTY GROUP
200 N. LASALLE ST., ST 2350
312-337-1001
MATANKY.COM