



FOR LEASE/SALE/BTS

72,213 SF INDUSTRIAL BUILDING ON 4.68 AC

NEC 19TH AVE & ALAMEDA RD

PROPERTY HIGHLIGHTS

- Prime Deer Valley Location
- A-1 Zoning
- 19th Ave frontage with great visibility
- Close proximity to TSMC and Deer Valley Airport
- APN 210-07-006A & 210-07-032A
- 4.68 Acres

FOR MORE INFORMATION PLEASE CONTACT:

BOB LUNDSTEDT

First Vice President

O: 602.957.7300

E: RLundstedt@daumcommercial.com

CHASE HEINEMANN

Vice President

O: 602.575.2333 | C: 602.689.4071

E: cheinemann@daumcommercial.com

SKIP CORLEY

Executive Vice President

O: 602.575.2303

E: scorley@daumcommercial.com

Although all information is furnished regarding for sale, rental or financing is from sources deemed reliable, such information has not been verified and no express representation is made nor is any to be implied as to the accuracy thereof, and it is submitted subject to errors, omissions, changes of price, rental or other conditions, prior sale, lease or financing, or withdrawal without notice. All Maps provided courtesy of Google Maps, Bing Maps, and Google Earth. D/AQ Corp. # 01129558

DAUM
COMMERCIAL REAL ESTATE SERVICES

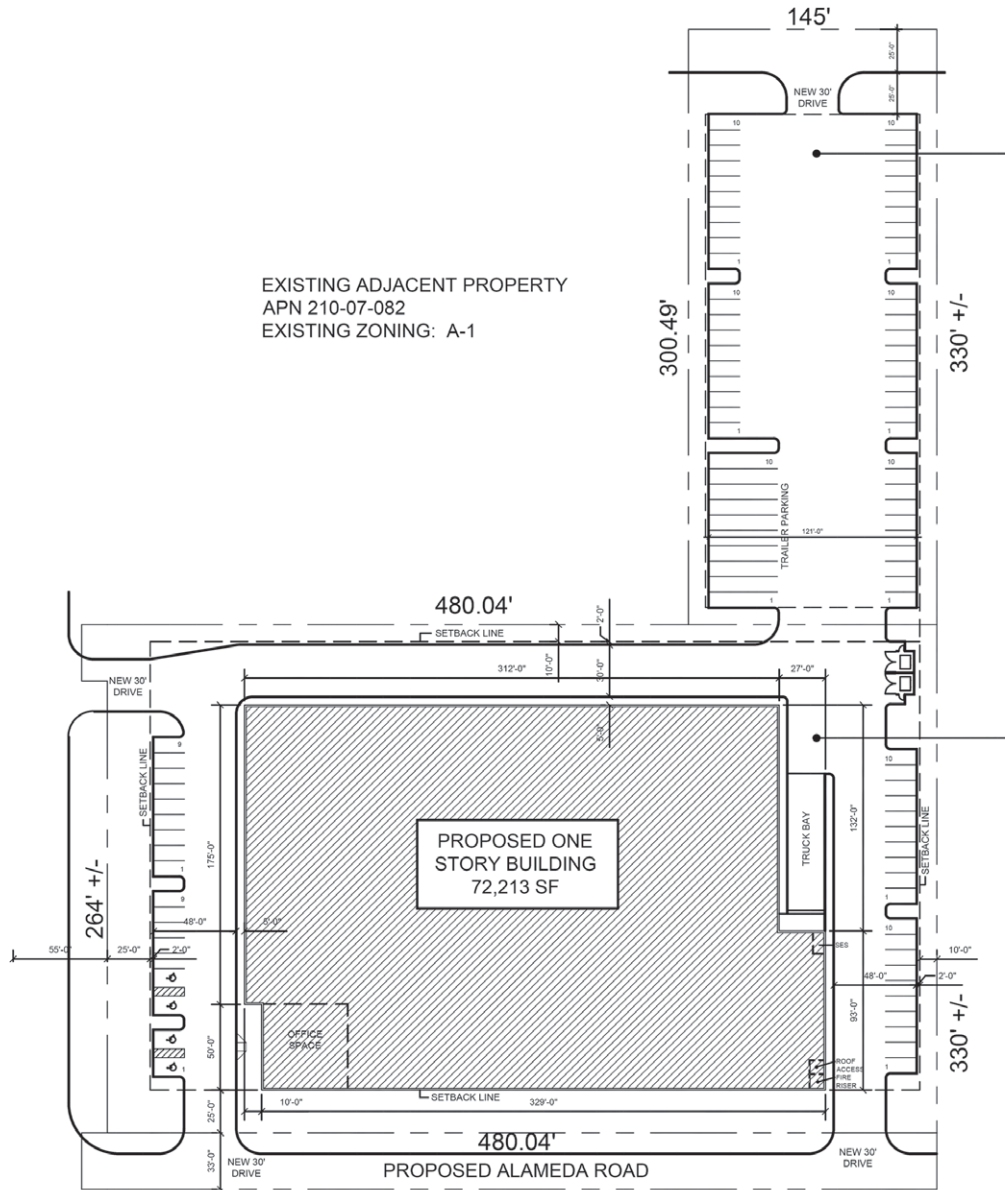

FOR LEASE/SALE/BTS

72,213 SF INDUSTRIAL BUILDING ON 4.68 AC

NEC 19TH AVE & ALAMEDA RD

FOR MORE INFORMATION PLEASE CONTACT:

BOB LUNDSTEDT

First Vice President

O: 602.957.7300

E: RLundstedt@daumcommercial.com

CHASE HEINEMANN

Vice President

O: 602.575.2333 | C: 602.689.4071

E: cheinemann@daumcommercial.com

SKIP CORLEY

Executive Vice President

O: 602.575.2303

E: scorley@daumcommercial.com

Although all information is furnished regarding for sale, rental or financing is from sources deemed reliable, such information has not been verified and no express representation is made nor is any to be implied as to the accuracy thereof, and it is submitted subject to errors, omissions, changes of price, rental or other conditions, prior sale, lease or financing, or withdrawal without notice. All Maps provided courtesy of Google Maps, Bing Maps, and Google Earth. D/AQ Corp. # 01129558





SUBJECT PROPERTY

W. PARK VIEW LN

N 19TH AVE.



Google

FOR LEASE/SALE/BTS

72,213 SF INDUSTRIAL BUILDING ON 4.68 AC

NEC 19TH AVE & ALAMEDA RD

FOR MORE INFORMATION PLEASE CONTACT:

BOB LUNDSTEDT
First Vice President
O: 602.957.7300
E: RLundstedt@daumcommercial.com

CHASE HEINEMANN
Vice President
O: 602.575.2333 | C: 602.689.4071
E: cheinemann@daumcommercial.com

SKIP CORLEY
Executive Vice President
O: 602.575.2303
E: scorley@daumcommercial.com

Although all information is furnished regarding for sale, rental or financing is from sources deemed reliable, such information has not been verified and no express representation is made nor is any to be implied as to the accuracy thereof, and it is submitted subject to errors, omissions, changes of price, rental or other conditions, prior sale, lease or financing, or withdrawal without notice. All Maps provided courtesy of Google Maps, Bing Maps, and Google Earth. D/AQ Corp. # 01129558



INSIDE TSMC, THE TAIWANESE CHIPMAKING GIANT THAT'S BUILDING A NEW PLANT IN PHOENIX



Taiwan Semiconductor Manufacturing Co. (TSMC) is building the massive chip-making facility on a large 1129 acres of land, with an even larger \$12 billion investment. TSMC's new facility is near Interstate 17 and Loop 303, which the Taiwanese giant purchased back in December 2020.

The new facility in Arizona should be operational by 2024. "Structural construction of the fabrication facility, called the fab, is nearing completion, and the office building has about half of its glasswork completed., there are currently 38 cranes working on the massive site".

TSMC is training around 500 employees from Arizona, over in Taiwan right now where TSMC has its feet firmly planted. But in 2023, TSMC is expected to have over 2000 people working in the Arizona plant.

Another positive for the US is that the existing semiconductor industry in Arizona has pulled the attention of other semiconductor industry companies to focus on Arizona, ever since TSMC announced its plans for the plant in Arizona.



FOR LEASE/SALE/BTS 72,213 SF INDUSTRIAL BUILDING ON 4.68 AC NEC 19TH AVE & ALAMEDA RD

FOR MORE INFORMATION PLEASE CONTACT:

BOB LUNDSTEDT

First Vice President

O: 602.957.7300

E: RLundstedt@daumcommercial.com

CHASE HEINEMANN

Vice President

O: 602.575.2333 | C: 602.689.4071

E: cheinemann@daumcommercial.com

SKIP CORLEY

Executive Vice President

O: 602.575.2303

E: scorley@daumcommercial.com

Although all information is furnished regarding for sale, rental or financing is from sources deemed reliable, such information has not been verified and no express representation is made nor is any to be implied as to the accuracy thereof, and it is submitted subject to errors, omissions, changes of price, rental or other conditions, prior sale, lease or financing, or withdrawal without notice. All Maps provided courtesy of Google Maps, Bing Maps, and Google Earth. D/AQ Corp. # 01129558

