

11-41 E Hintz Road, Wheeling, IL

Available: +/- 5,010 SF



Immediate Availability

## FOR SUBLEASE: Industrial Facility with High-End Finishes

AVAILABLE: +/- 5,010 SF

OFFICE: Varies

CAR PARKING: Ample

LOADING: 1 Exterior Dock

CLEAR HEIGHT: 18'

ZONING: I-2 (Limited Industrial)

SPRINKLER: YES

POWER: (5) 200 Amps / 220 Volts

RE TAXES: \$2.55 PSF (Paid in 2023)

LEASE RATE: \$14.00 PSF MG

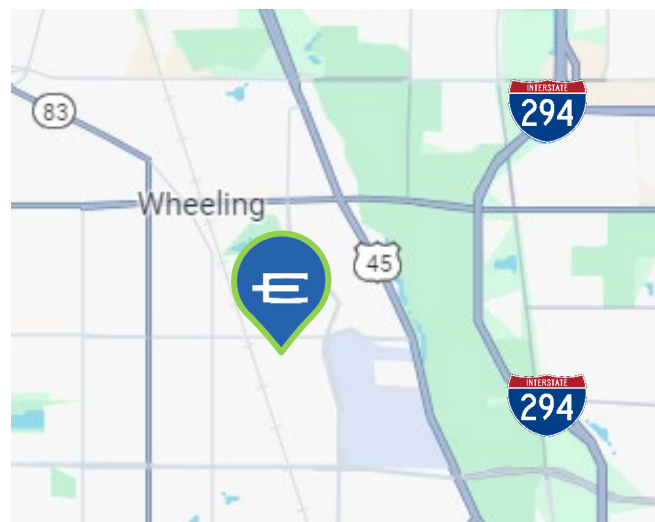

SCAN FOR LISTING



**ENTRE**  
Commercial Realty LLC

Denise Stein Chaimovitz  
847-804-8566  
[denise@entreccommercial.com](mailto:denise@entreccommercial.com)

Elisabeth Lazzara  
847-310-4209  
[elazzara@entreccommercial.com](mailto:elazzara@entreccommercial.com)

The information contained herein is from sources deemed reliable but is submitted subject to errors, omissions and to change of price or terms without notice.

# Building Layout

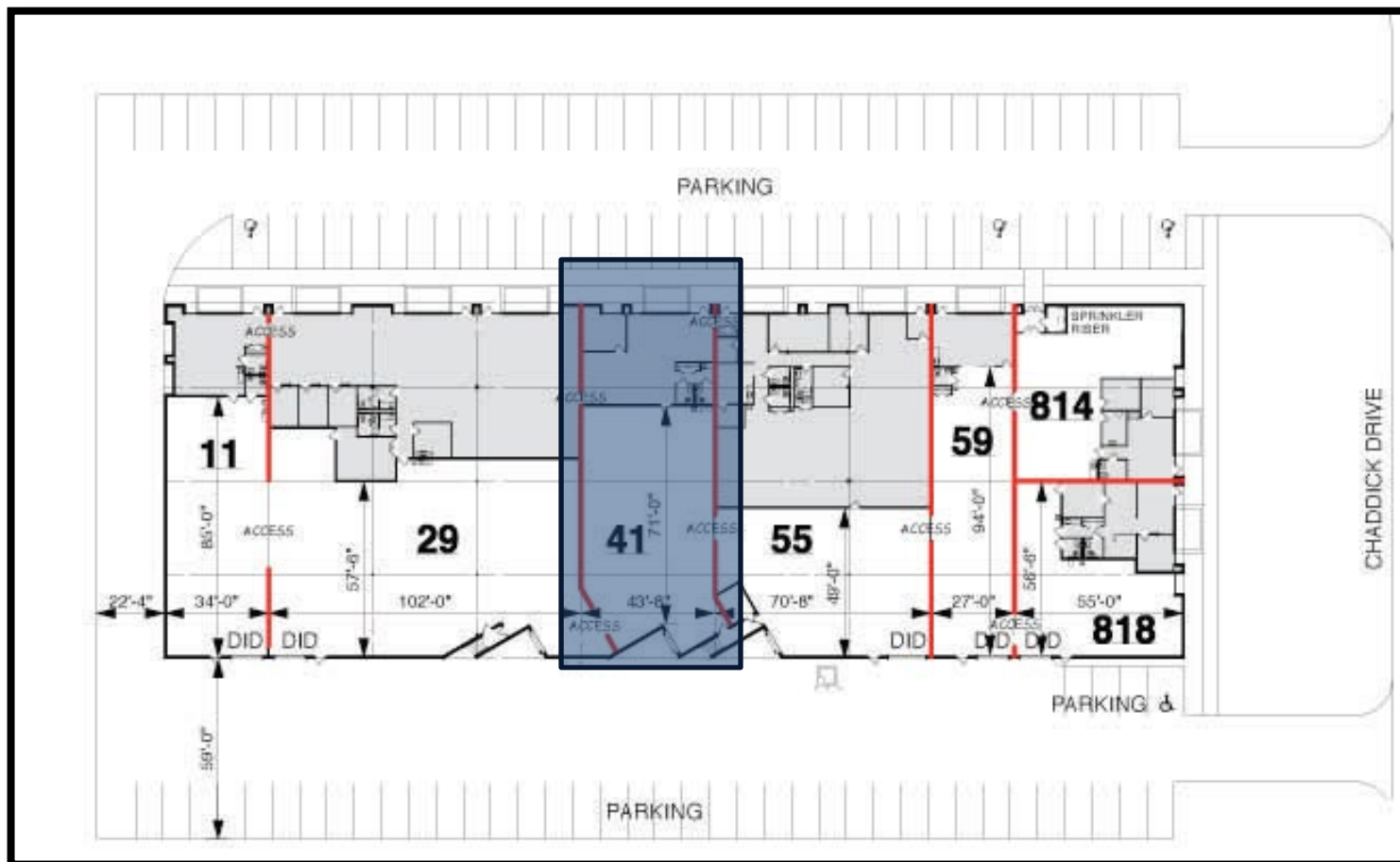

## Facility Highlights



**WAREHOUSE/DISTRIBUTION/MANUFACTURING/FLEX FACILITY**



**VPD: 17,457**



**NEWLY RENOVATED OFFICES**



**PRIVATE LOADING DOCK & 2 DRIVE-IN DOORS**

**ENTRE**  
Commercial Realty LLC

Denise Stein Chaimovitz  
847-804-8566  
[denise@entreccommercial.com](mailto:denise@entreccommercial.com)

Elisabeth Lazzara  
847-310-4209  
[elazzara@entreccommercial.com](mailto:elazzara@entreccommercial.com)



# LOCATION



SCAN FOR MAP VIEW

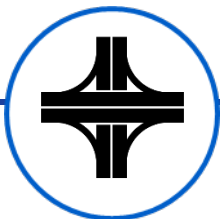

**3 MILES TO I-294/  
WILLOW ROAD  
INTERCHANGE**



**LOCATED WITHIN A CORPORATE  
BUSINESS PARK SETTING**



**STRONG LABOR  
POOL**

**ENTRE**  
Commercial Realty LLC

Denise Stein Chaimovitz  
847-804-8566  
[denise@entreccommercial.com](mailto:denise@entreccommercial.com)

Elisabeth Lazzara  
847-310-4209  
[elazzara@entreccommercial.com](mailto:elazzara@entreccommercial.com)