



2110 Main Street, Santa Monica, CA 90405

**Second Floor Office Space
3,055 sq ft - DIVISIBLE**

Designed by the renowned architectural firm Lomax/Rock in 1987, this contemporary building offers creative offices with high bow truss ceilings, lightweight concrete floors, operable windows, & lots of natural light with modern amenities such as controlled entry, garage parking, and an elevator.

Located on Main Street, Santa Monica, in close proximity to numerous restaurants, cafes, and boutique shops.

P E R L O F F | W E B S T E R

(310) 396-3688

mayra@perloffwebster.com

**321
Hampton Drive
Venice
California
90291**



OFFICE SPACES DIVISABLE



SUITE 207 - 3,055 SQ FT

OPTION 1

1,729 SQ FT

- Two Executive Offices
- Conference Room
- Kitchen
- A Private Balcony

OPTION 2

681 SQ FT

OPTION 3

645 SQ FT



All Spaces Include

- Exposed Bow Truss Ceilings
- Operable Windows
- Lightweight Concrete Floors
- Shared Restroom, Shower, & Laundry Facilities
- Controlled HVAC



P E R L O F F | W E B S T E R

(310) 396-3688

mayra@perloffwebster.com

**321
Hampton Drive
Venice
California
90291**

FLOOR PLANS

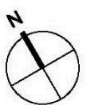
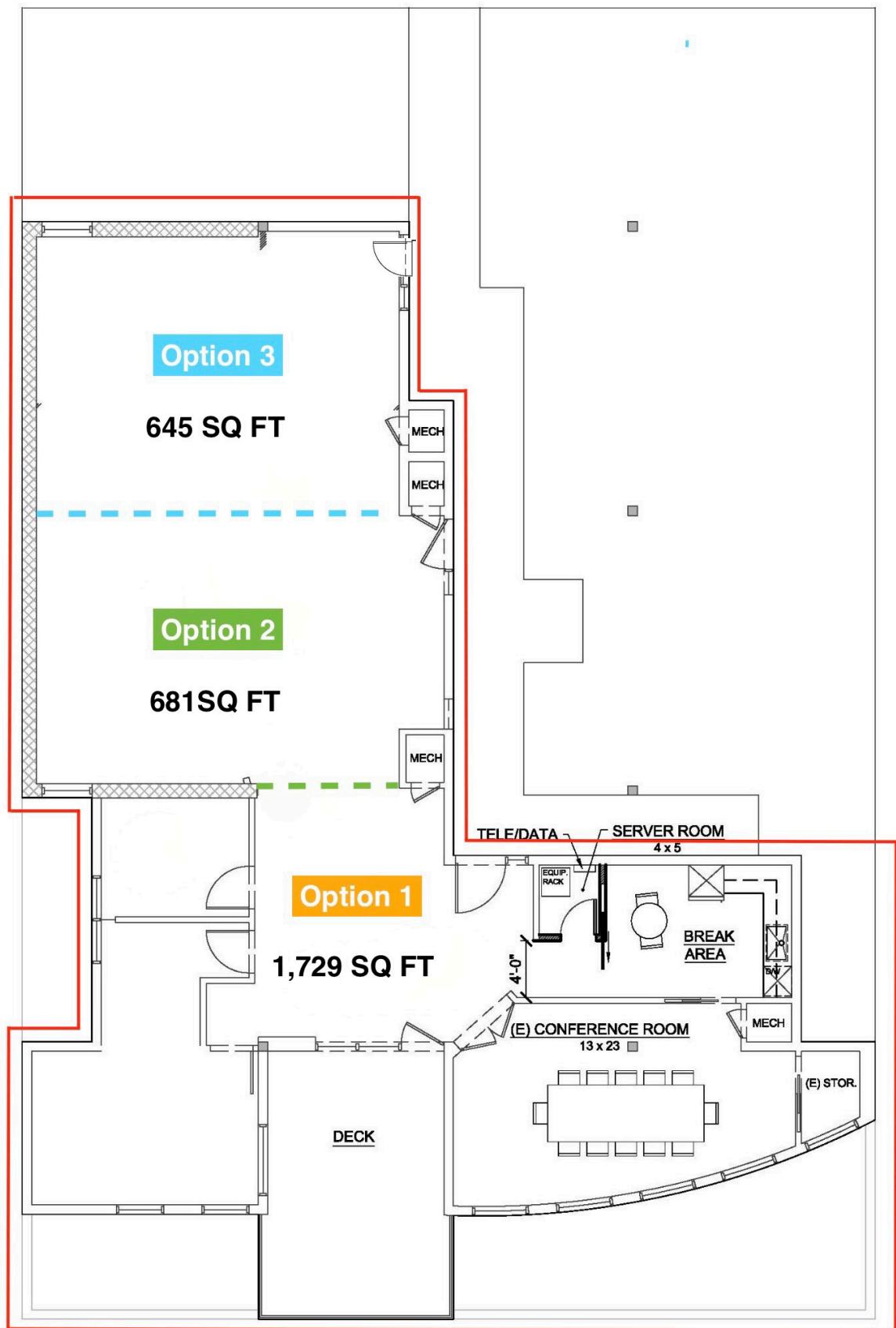

PERLOFF WEBSTER

(310) 396-3688

mayra@perloffwebster.com

321
Hampton Drive
Venice
California
90291

