



CUSTOM SPEC SUITES AVAILABLE FOR LEASE

UNDER NEW OWNERSHIP & MANAGEMENT BY
TOP HEALTHCARE REAL ESTATE OWNER

1800 & 1900 Hollister Drive

Libertyville, Illinois 60048

One Oakbrook Terrace
Suite 400
Oakbrook Terrace, Illinois 60181
+1 630 932 1234

hiffman.com

PROPERTY HIGHLIGHTS

Two building Medical Office Campus with Class A Space available for lease. Located within close proximity to Advocate Condell Medical Center and top retail destinations, such as Hawthorn Mall and Mellody Farm.



COMPLETELY NEW
RENOVATED COMMON
AREAS & TENANT
AMENITIES



SYNERGISTIC MIX OF MEDICAL
CO-TENANTS PRIMARY CARE,
NEUROLOGY, PULMONOLOGY, ENT,
OPHTHALMOLOGY, PEDIATRICS



COVERED PARKING



UNDER NEW OWNERSHIP
& MANAGEMENT



CLOSE PROXIMITY TO
ADVOCATE CONDELL
MEDICAL CENTER



OFFICE VIEWS OF
FOREST PRESERVE &
WALKING TRAILS

Contact

Sarah Walker
+1 630 389 8911
swalker@hiffman.com

Jason Wurtz
+1 630 693 0692
jwurtz@hiffman.com

NO WARRANTY OR REPRESENTATION, EXPRESS OR IMPLIED, IS MADE AS TO THE ACCURACY OF THE INFORMATION CONTAINED HEREIN, AND THE SAME IS SUBMITTED SUBJECT TO ERRORS, OMISSIONS, CHANGE OF PRICE, RENTAL OR OTHER CONDITIONS, PRIOR SALE, LEASE OR FINANCING, OR WITHDRAWAL WITHOUT NOTICE, AND OF ANY SPECIAL LISTING CONDITIONS IMPOSED BY OUR PRINCIPALS NO WARRANTIES OR REPRESENTATIONS ARE MADE AS TO THE CONDITION OF THE PROPERTY OR ANY HAZARDS CONTAINED THEREIN ARE ANY TO BE IMPLIED.

1800 HOLLISTER



SPACE AVAILABLE

Suite G10	1,788 - 4,982 SF
Suite G18	3,194 - 4,982 SF

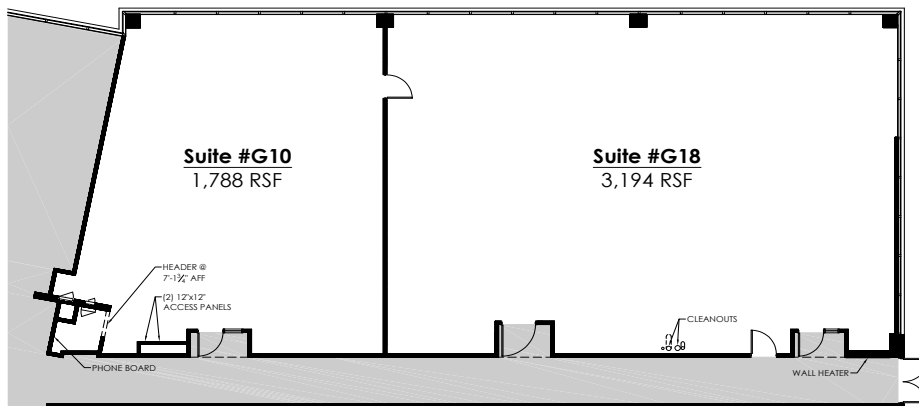
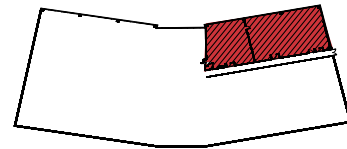

1900 HOLLISTER

AVAILABLE SUITES

Suite 100	1,265 - 2,246 SF
Suite 120	1,429 SF
Suite 130	981 - 2,246 SF
Suite 230	1,700 SF
Suite 260	1,095 SF
Suite 300	1,552 SF
Suite 330	2,259 - 5,815 SF
Suite 350	359 - 5,815 SF
Suite 380	2,048 SF
Suite 390	3,197 - 5,815 SF

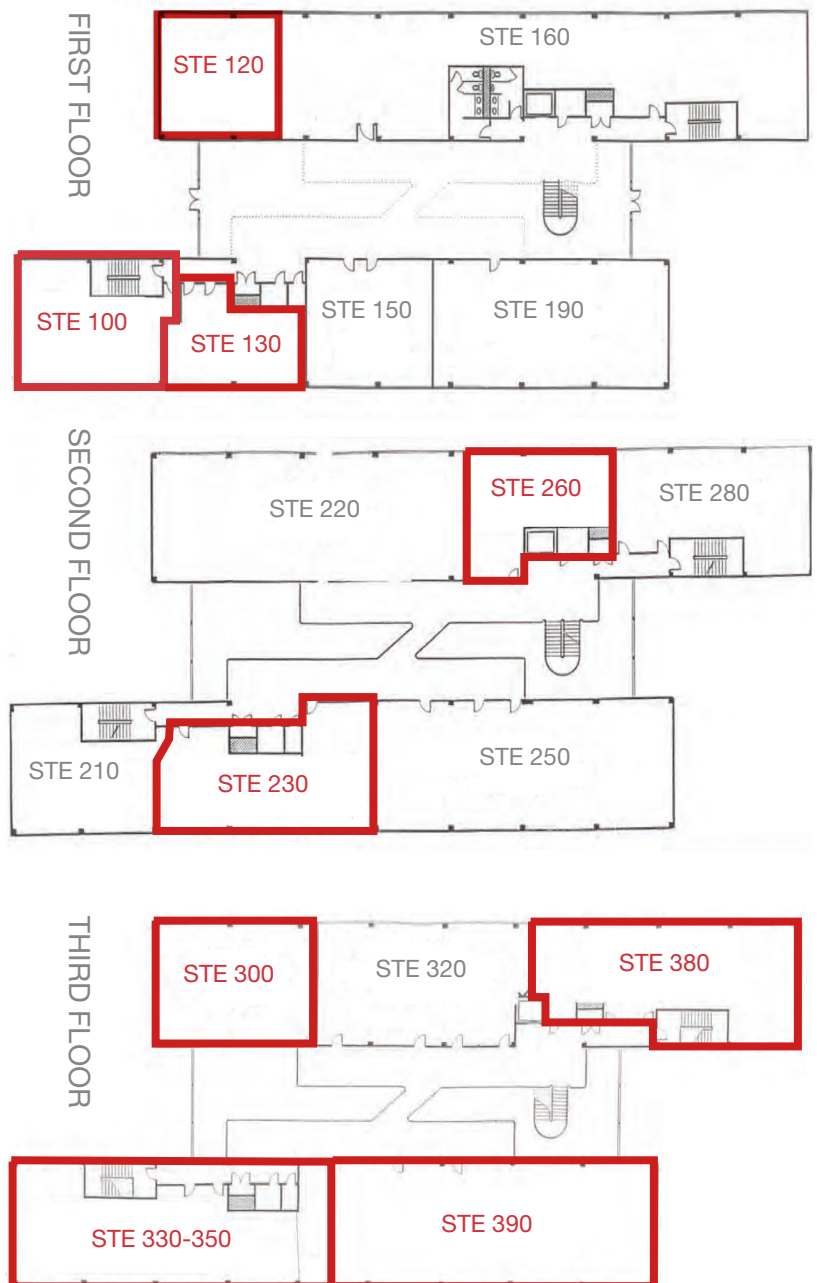



Contact

Sarah Walker
 +1 630 389 8911
 swalker@hiffman.com

Jason Wurtz
 +1 630 693 0692
 jwurtz@hiffman.com



One Oakbrook Terrace
 Suite 400
 Oakbrook Terrace, Illinois 60181
 +1 630 932 1234

hiffman.com