

For Sublease

CBRE

PDX Flatiron Building

3303 N Mississippi Ave,
Suite 300, Portland, OR 97227
www.cbre.com



3303 N Mississippi Ave,
Suite 300, Portland | OR 97227

For Sublease

Property Photos



Floor Plan

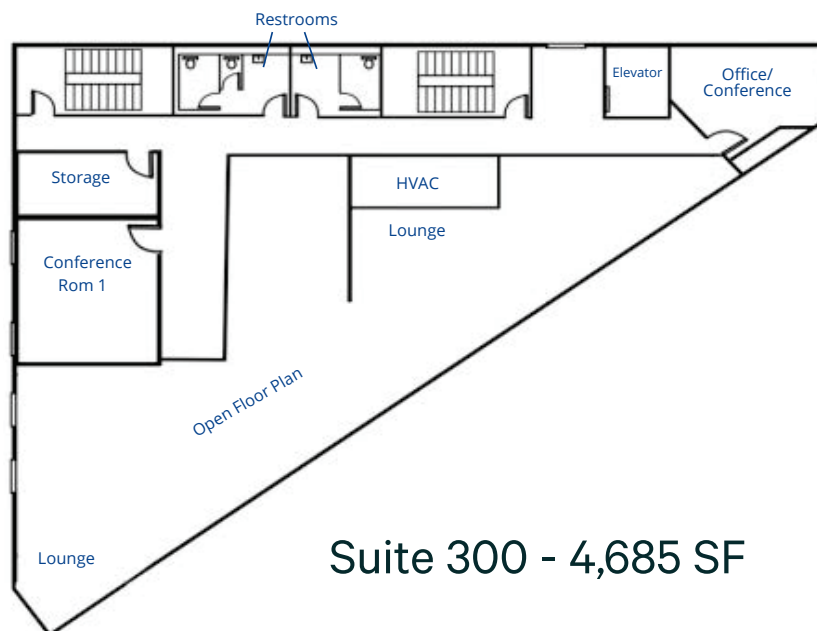

Suite Highlights

The PDX Flatiron located at 3303 N Mississippi, is a Class A building at the head of the historic Mississippi Avenue. This stretch offers dozens of restaurants, shops, bars, and music options for lunch, dinner or happy hour. The third floor is move-in ready with optional furniture and on-site, secured parking stalls available. Make this unique and modern building your new office!

- Sublease term through June 30, 2027
- \$25 Full Service Gross
- Move-in ready with furniture available
- On-site secured parking available
- Access to shared kitchen
- Access to podcast studio and green screen

Contact Us

Al Kennedy
Senior Vice President
+1 503 545 5616
al.kennedy@colliers.com

© 2025 CBRE, Inc. All rights reserved. This information has been obtained from sources believed reliable, but has not been verified for accuracy or completeness. You should conduct a careful, independent investigation of the property and verify all information. Any reliance on this information is solely at your own risk. CBRE and the CBRE logo are service marks of CBRE, Inc. All other marks displayed on this document are the property of their respective owners, and the use of such logos does not imply any affiliation with or endorsement of CBRE. Photos herein are the property of their respective owners. Use of these images without the express written consent of the owner is prohibited.