

ONE

JANE STREET



ONE

JANE STREET

CORNER OF GREENWICH AVENUE
WEST VILLAGE

SIZE: Ground Floor - 414 SF

FRONTAGE: 15'

POSSESSION: Immediate

TRANSPORTATION: 1 2 3 A C E L

HIGHLIGHTS:

- Former smoke shop
- Inline space in dense high income area
- 1 block away from Jackson Square
- Steps from the 14th Street station
- Neighbors include: *Longchamp, Alexis Bittar, Starbucks, OTTE, A Salt & Battery, Gray & Davis, Tea & Sympathy, Odin, KOSAKA, Jack & Charles, PlantShed, Don Angie, Equinox, TD Bank, Northwell Health*

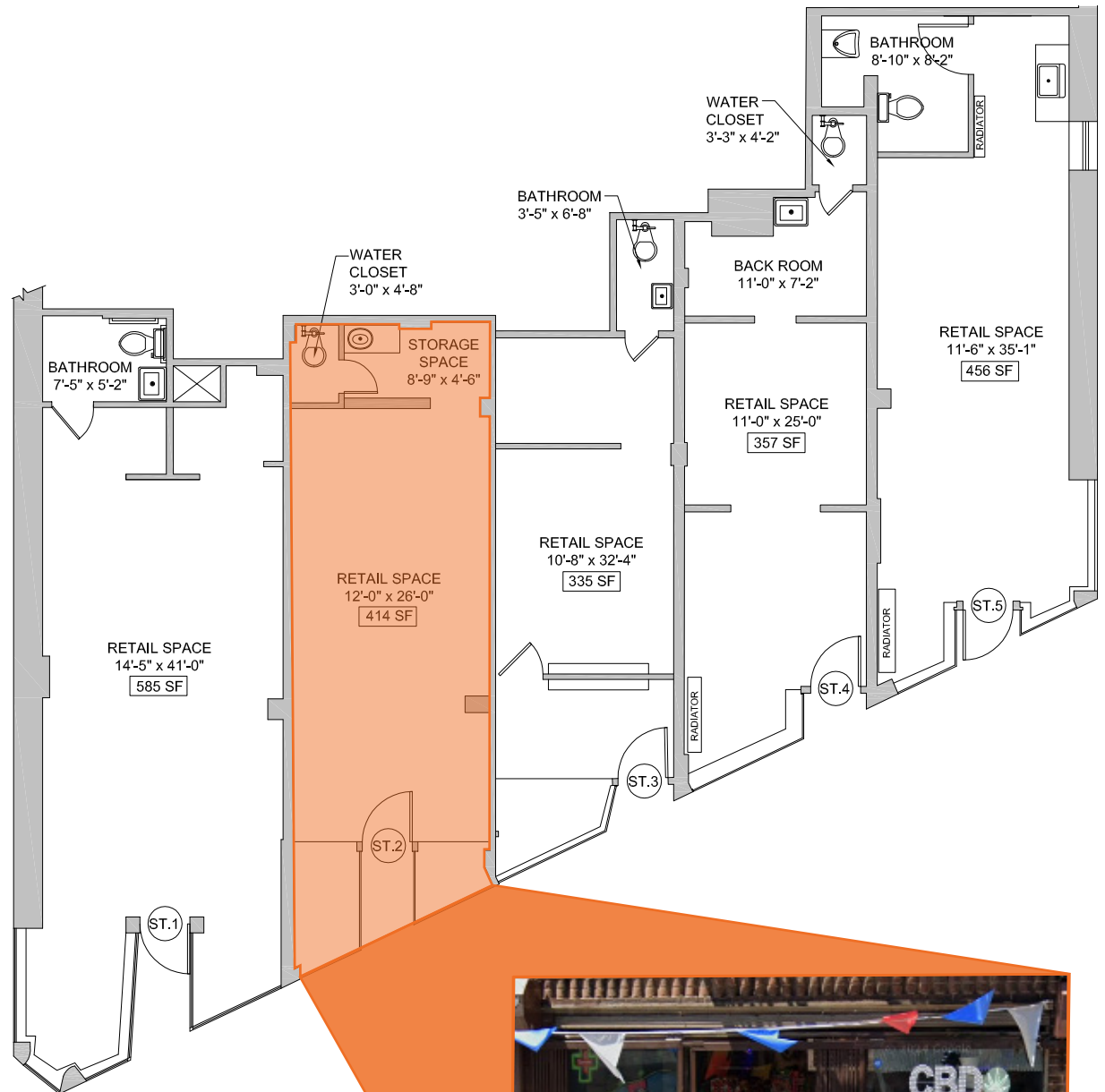

All information supplied in this marketing presentation and/or flyer is from sources deemed reliable and is furnished subject to errors, omissions, modifications, removal of listings from sale/lease and to any listing condition. Any square footage, dimensions, floor plans and/or technical data set forth are approximations and are subject to further elaboration/confirmation.

ONE

JANE STREET



All information supplied in this marketing presentation and/or flyer is from sources deemed reliable and is furnished subject to errors, omissions, modifications, removal of listings from sale/lease and to any listing condition. Any square footage, dimensions, floor plans and/or technical data set forth are approximations and are subject to further elaboration/confirmation.



CORNER OF GREENWICH AVENUE
WEST VILLAGE

FOR MORE INFORMATION,
PLEASE CONTACT:

MARC SITT

917.757.8863 | MSitt@ksrny.com

ALBERT MANOPLA

212.380.8369 | AManopla@ksrny.com

