

N. JACKSON AVENUE: 30,485 ADT

REGIONAL MEDICAL CENTER
2,000+ EMPLOYEES

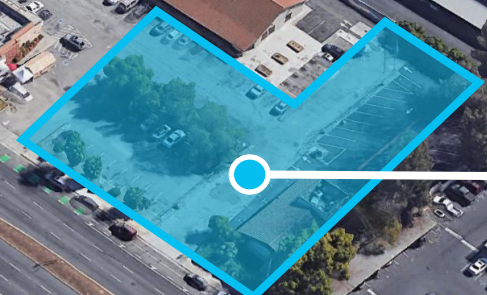

MCKEE ROAD: 25,037 ADT



SITE

2102 & 2122 MCKEE ROAD
SAN JOSE, CA | RETAIL AVAILABLE FOR LEASE



PROPERTY PROFILE

PROPERTY HIGHLIGHTS

● LOCATION:

- 2102 & 2122 McKee Road
San Jose, CA

● AVAILABLE SF:

- ± 1,800 SF (Existing
Restaurant)
- Drive-Thru Pad Available
(Ground Lease)

● LEASE PRICE:

- Please Inquire W/ Broker

- Restaurant Ready Space Available

- Signalized Intersection

- Adjacent to Regional Medical Center
with over 2,000 Employees

- Fronting High Traffic East/West Arterial

- Underserved Trade Area

SITE PLAN

**DRIVE-THRU
PAD AVAILABLE
(APPROVED PLANS)**

KEY TO SHADING

- LANDSCAPED AREAS
- HARDSCAPE AREAS

**AVAILABLE
1,800 SF
FORMER TACO BELL
(RESTAURANT READY)**

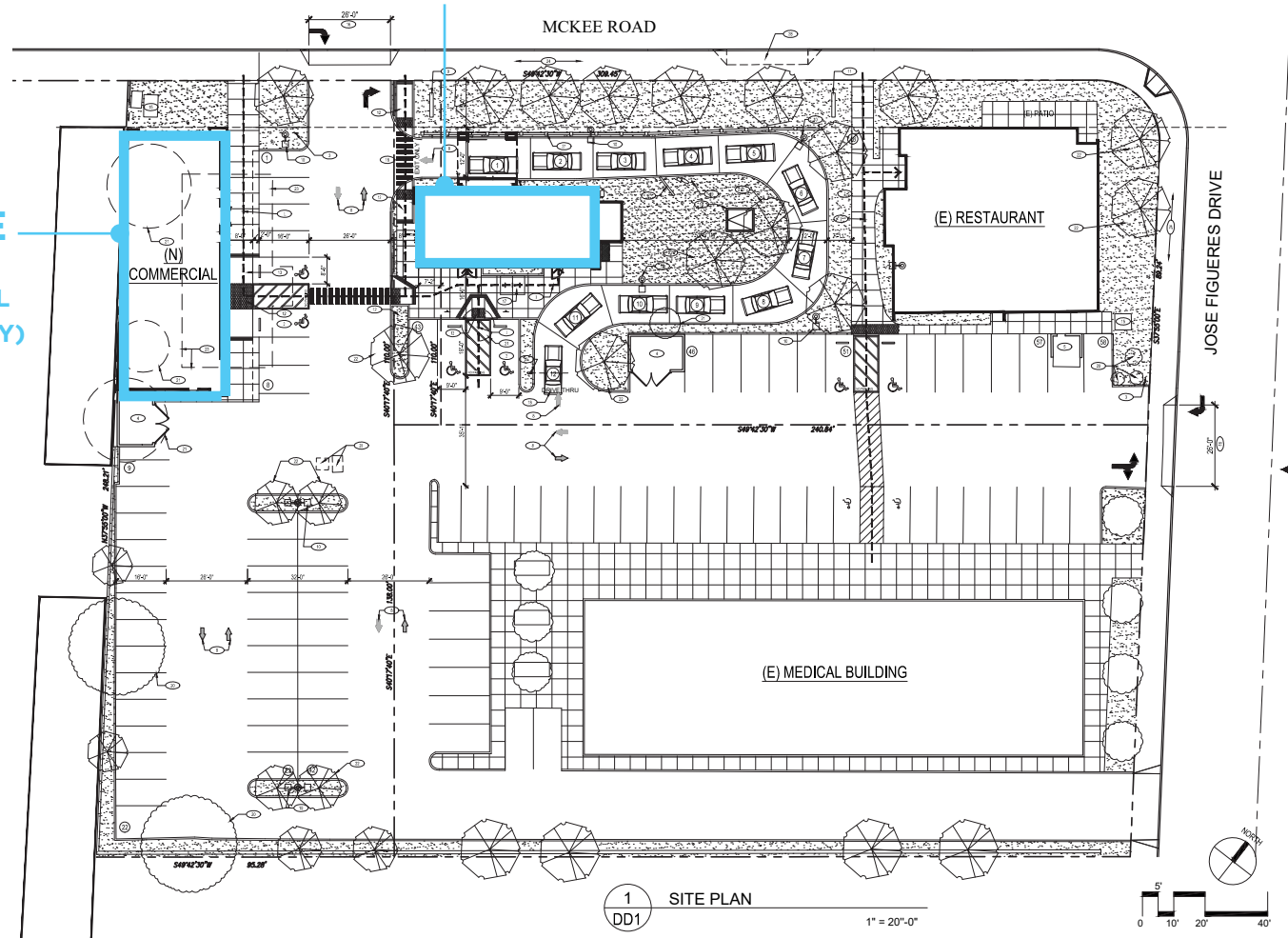

DEMOGRAPHICS



POPULATION

1 MILE | 40,733
2 MILES | 153,864
3 MILES | 295,268



DAYTIME POPULATION

1 MILE | 10,000
2 MILES | 32,873
3 MILES | 108,302



AVERAGE HHI

1 MILE | \$69,613
2 MILES | \$82,164
3 MILES | \$87,800

TRAFFIC COUNTS

- Mckee Road 25,037 ADT
- N Jackson Avenue 30,485 ADT

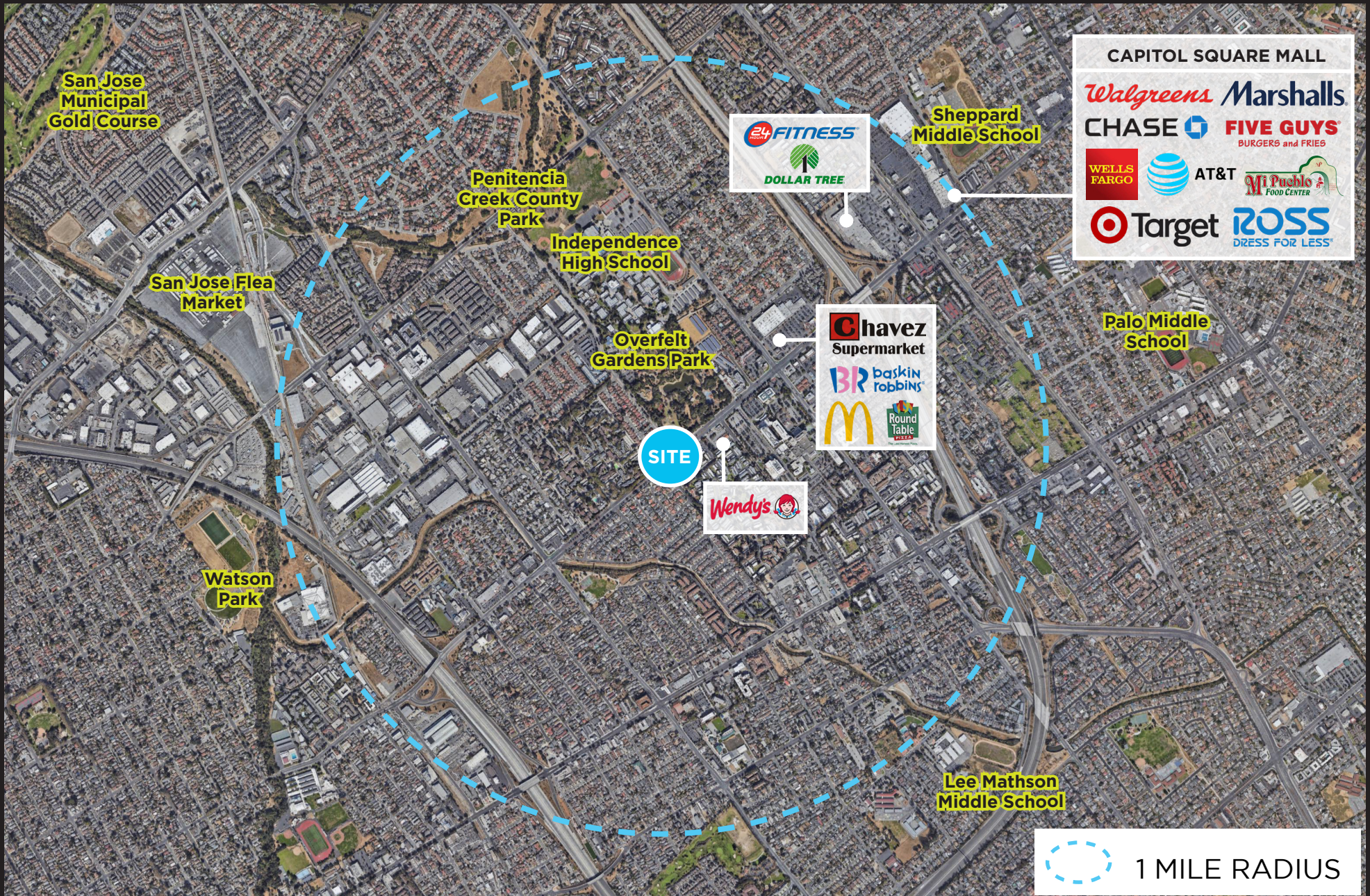

AERIAL MAP



the econic company®

JAMES CHUNG

Founder & Principal

jchung@theeconiccompany.com

(408) 400-7017

CaIDRE LIC #01408190

MIKE CONROY

Director

mconroy@theeconiccompany.com

(408) 400-7061

CaIDRE LIC# 02046912

The Econic Company Copyright 2021. No warranty or representation, express or implied, is made to the accuracy or completeness of the information contained herein, and same is submitted subject to errors, omissions, change of price, rental or other conditions, withdrawal without notice, and to any special listing conditions imposed by the property owner(s). As applicable, we make no representation as to the condition of the property (or properties) in question.