



15,260 sf + 3 outparcels
 Drive-thru development opportunities
 6540-6550 Hampton Roads Parkway
 Harborview, North Suffolk, Virginia 23435
 JCF 757-623-1062 ext. 213 (tel)
 Attn: Lawrence / LAKEBARB4@aol.com





PARCEL 2
284564 SQ.FT.
6.533 AC.

PARCEL 1
26450 SQ.FT.
4.739 AC.

RETAIL SHOP
RETAIL SHOP

CENTERLINE OF
15' PRIVATE
DRAINAGE
EASEMENT

DRAINAGE AND
IMPOUNDMENT
EASEMENT

15' VIRGINIA POWER
EASEMENT
D.B. 366, PG. 536
(HATCHED AREA)

RESPASS BEACH ROAD (VARIABLE WIDTH R/W)
VIRGINIA ROUTE 623

ACCESS, UTILITY AND
DRAINAGE EASEMENT

CENTERLINE OF
15' PRIVATE
DRAINAGE
EASEMENT

CENTERLINE OF
15' PRIVATE
DRAINAGE
EASEMENT

CENTERLINE OF
10' PRIVATE
UTILITY EASEMENT

CENTERLINE OF
25' PRIVATE
UTILITY EASEMENT

CENTERLINE OF
15' PRIVATE
DRAINAGE
EASEMENT

ACCESS, UTILITY AND
DRAINAGE EASEMENT

OUTPARCEL 2
36043 SQ.FT.
0.827 AC.

OUTPARCEL 1
52459 SQ.FT.
1.204 AC.

OUTPARCEL 3
43554 SQ.FT.
0.999 AC.

APPROXIMATE
LOCATION OF
VIRGINIA POWER
EASEMENT
D.B. 366, PG. 541

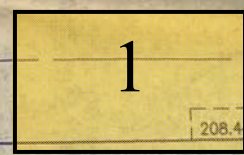

HAMPTON ROADS PARKWAY - STATE ROUTE 658
(VARIABLE WIDTH R/W)
(SPECIAL CORRIDOR OVERLAY DISTRICT)



15,260 sf
w/2 dock level
doors

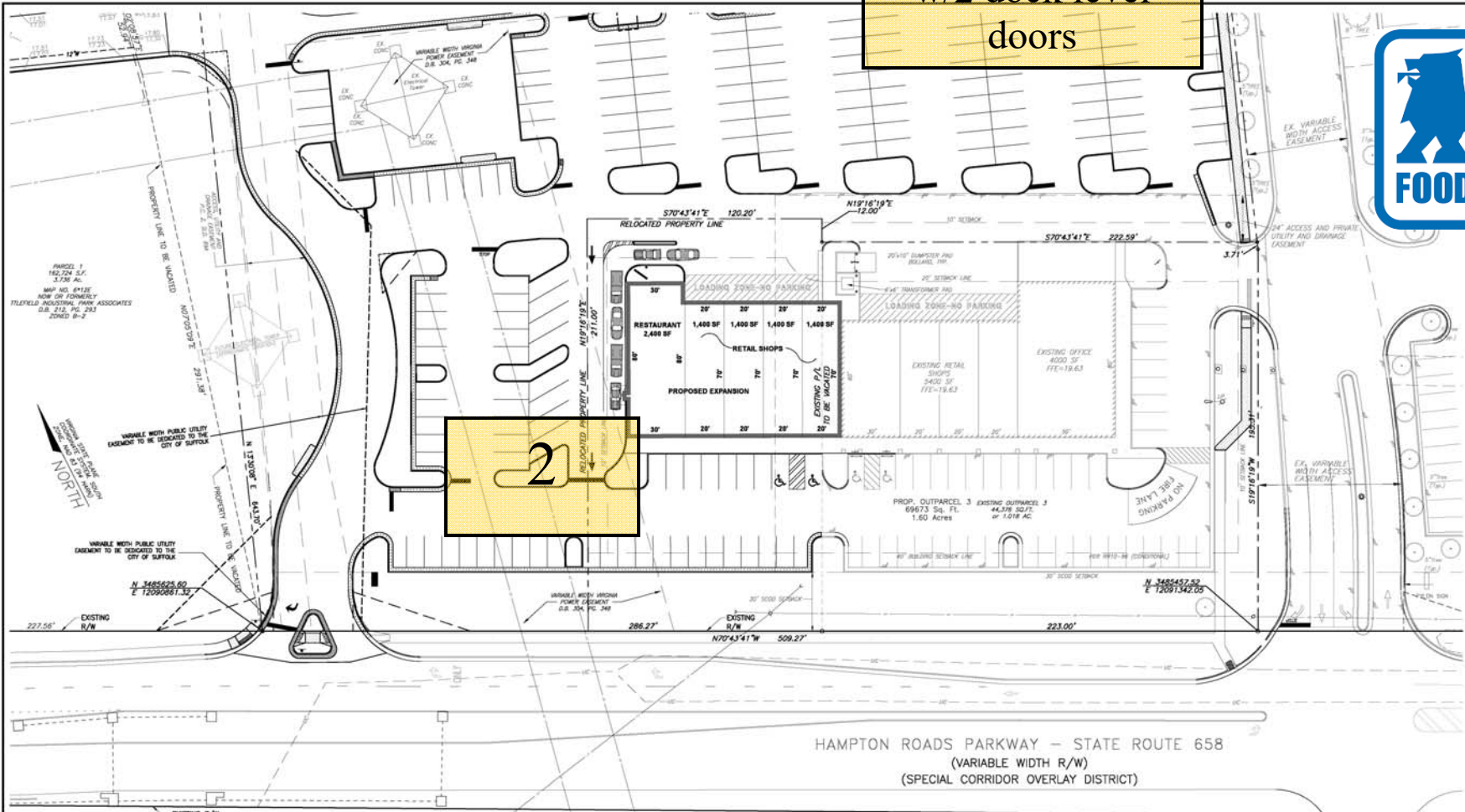

HOGGARD-EURE ASSOCIATES, P.C.
Engineers Surveyors Planners
301 ParCentre Parkway, Suite 3
Parramont, Virginia 22081
Phone: (703) 484-3470

APPROVAL DATE:

CONCEPT PLAN "A"
FOR RETAIL SHOP EXPANSION
MARKETCENTER AT HARBOR VIEW
SUFFOLK, VIRGINIA
TAX MAP NO. 8*13A*3 & 8*13A*3A

DATE: 10/21/2019
SCALE: 1"=25'
ENGR.: CLS
DESIGN: GDC
DRAWN: GDC

SHEET NO.
1
OF 1

CAD FILE: CONCEPT PLAN
10-21-2019.DWG
DWG No: 1346.07

HAMPTON ROADS PARKWAY - STATE ROUTE 658
(VARIABLE WIDTH R/W)
(SPECIAL CORRIDOR OVERLAY DISTRICT)

MAP NO. 6*13C
NOW OR FORMERLY
HAMPTON ROADS CROSSING ASSOCIATES
D.B. 423 PG. 13
ZONED B-2





NO BUILD AREA
Space Remains Green
Pylon Sign can be close to stop light

PARCEL 7A

WAWA SIGN LOCATION



PARCEL 1A

PARCEL 2A

PARCEL 1A

SIGN LOCATION

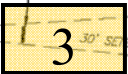

15,260 sf
w/2 dock level
doors



RETAIL SHOPS



TO I-664

COLLEGE DRIVE

BURBAGE DRIVE

BURBAGE DRIVE



HAMPTON ROADS PARKWAY

