

**FOR LEASE**

*From 2,110 Sq. Ft. to 6,189 Sq. Ft.*

**Industrial / Office Units**



5600-5760 Ayala Avenue • Irwindale, California

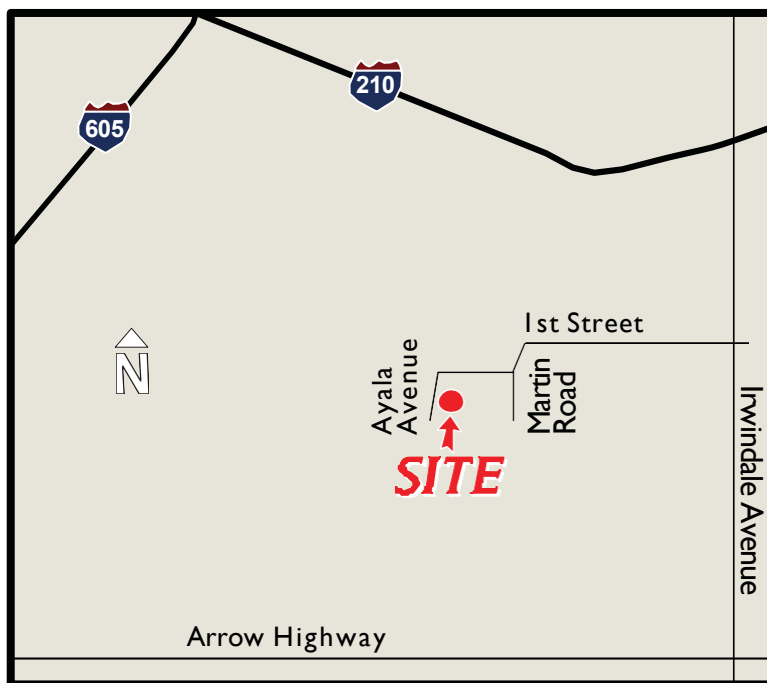

## Features

- Professional Business Park Environment
- Flexible Unit Sizes form 2,110 to 6,189 Sq. Ft. Allows for expansion
- All vacant units fully refurbished and move-in ready
- Central Irwindale location – adjacent to the 605, 210 and I-10 freeways

**Mitch Ashwill**

626.363.7868

[mitch@ashwill.com](mailto:mitch@ashwill.com)

Lic# 00970525

**Sean Casey**

626.363.7855

[seankc@ashwill.com](mailto:seankc@ashwill.com)

Lic# 01887121

**Ashwill  
Associates**

COMMERCIAL REAL ESTATE

[www.ashwill.com](http://www.ashwill.com)

The information contained herein has been obtained from sources we deem reliable. While we have no reason to doubt it's accuracy, we do not guarantee it. The prospective buyer or lessee should carefully verify all information contained herein. All measurements are approximate.

**FOR LEASE**

*From 2,110 Sq. Ft to 6,189 Sq Ft*

**Industrial / Office Units**

**5600-5760 Ayala Avenue | Irwindale, CA**

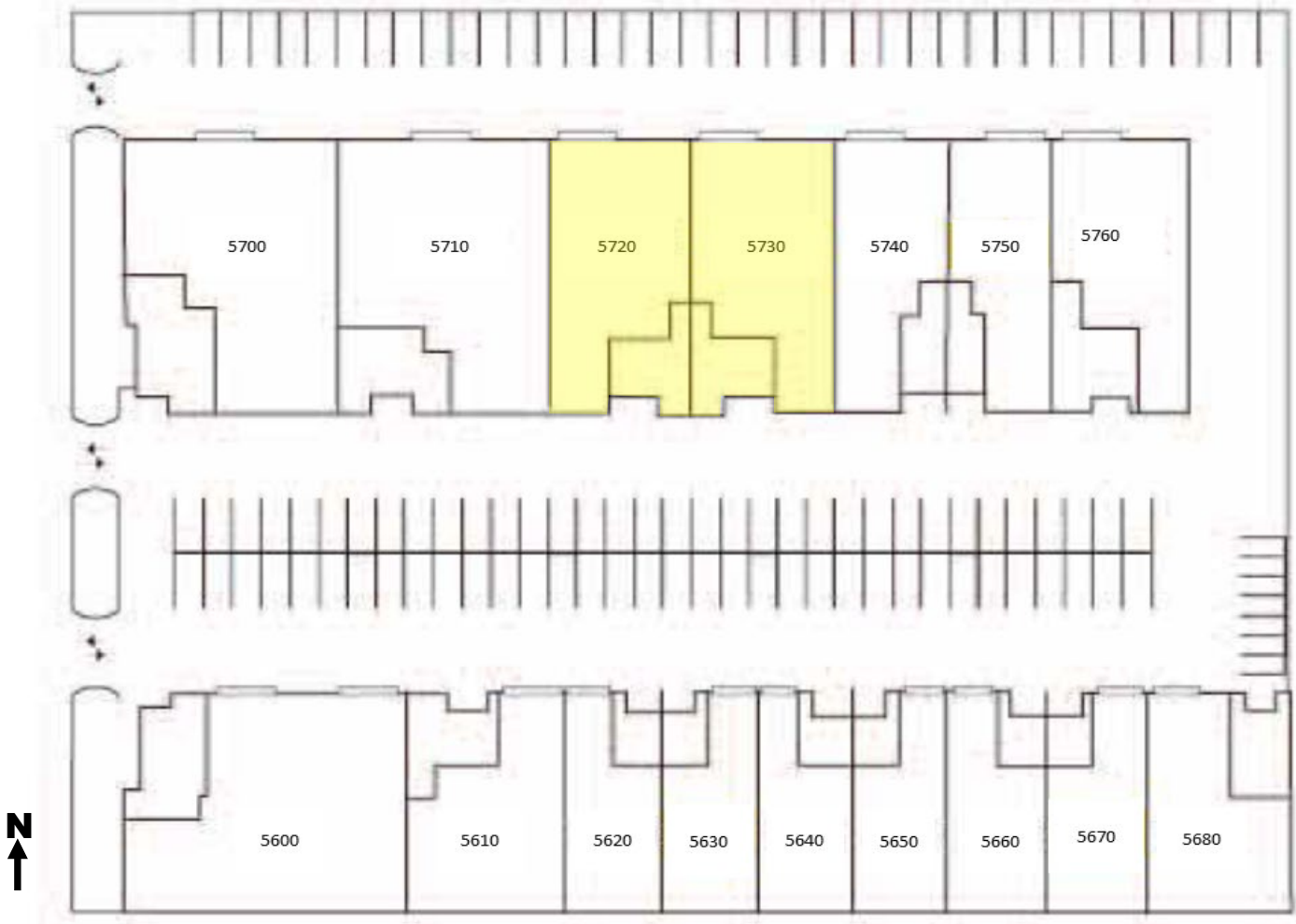

**AVAILABLE SPACE**

ADDRESS	SQ. FT.	OFFICE BUILDOUT	CLEARANCE	RENTAL RATE	COMMENTS
5720 Ayala Avenue	±3,910 SF	20% Office	16' Clear	\$1.73	Rear Loading
5730 Ayala Avenue	±4,018 SF	20% Office	16' Clear	\$1.73	Can Be Combined With Adjacent Unit For Combined Total ±7,928 SF

**Mitch Ashwill**  
626.363.7868  
[mitch@ashwill.com](mailto:mitch@ashwill.com)  
Lic# 00970525

**Sean Casey**  
626.363.7855  
[sean.kc@ashwill.com](mailto:sean.kc@ashwill.com)  
Lic# 01887121

**Ashwill Associates**  
COMMERCIAL REAL ESTATE

[www.ashwill.com](http://www.ashwill.com)

The information contained herein has been obtained from sources we deem reliable. While we have no reason to doubt its accuracy, we do not guarantee it. The prospective buyer or lessee should carefully verify all information contained herein. All measurements are approximate.