

FOR LEASE

2501 McPhillips Street

WINNIPEG, MB



~ Prominent Retail Opportunity on McPhillips Street ~



*Concept Rendering

2501 McPhillips Street

Property Details

AREA AVAILABLE (+/-) 1,400 - 5,600 sq. ft.

NET RENT Starting at \$32.00 per sq. ft.

ADDITIONAL RENT (est. 2023) \$5.60 per sq. ft. plus mgmt. fee

PYLON SIGN RENTAL \$125-\$250/month (subject to availability)

AVAILABILITY Summer 2024

HIGHLIGHTS

- Join Shapes Fitness and Hub Insurance
- High traffic centre with pylon signage opportunity along McPhillips Street
- Ample on-site parking



2501 McPhillips Street

Site Plan

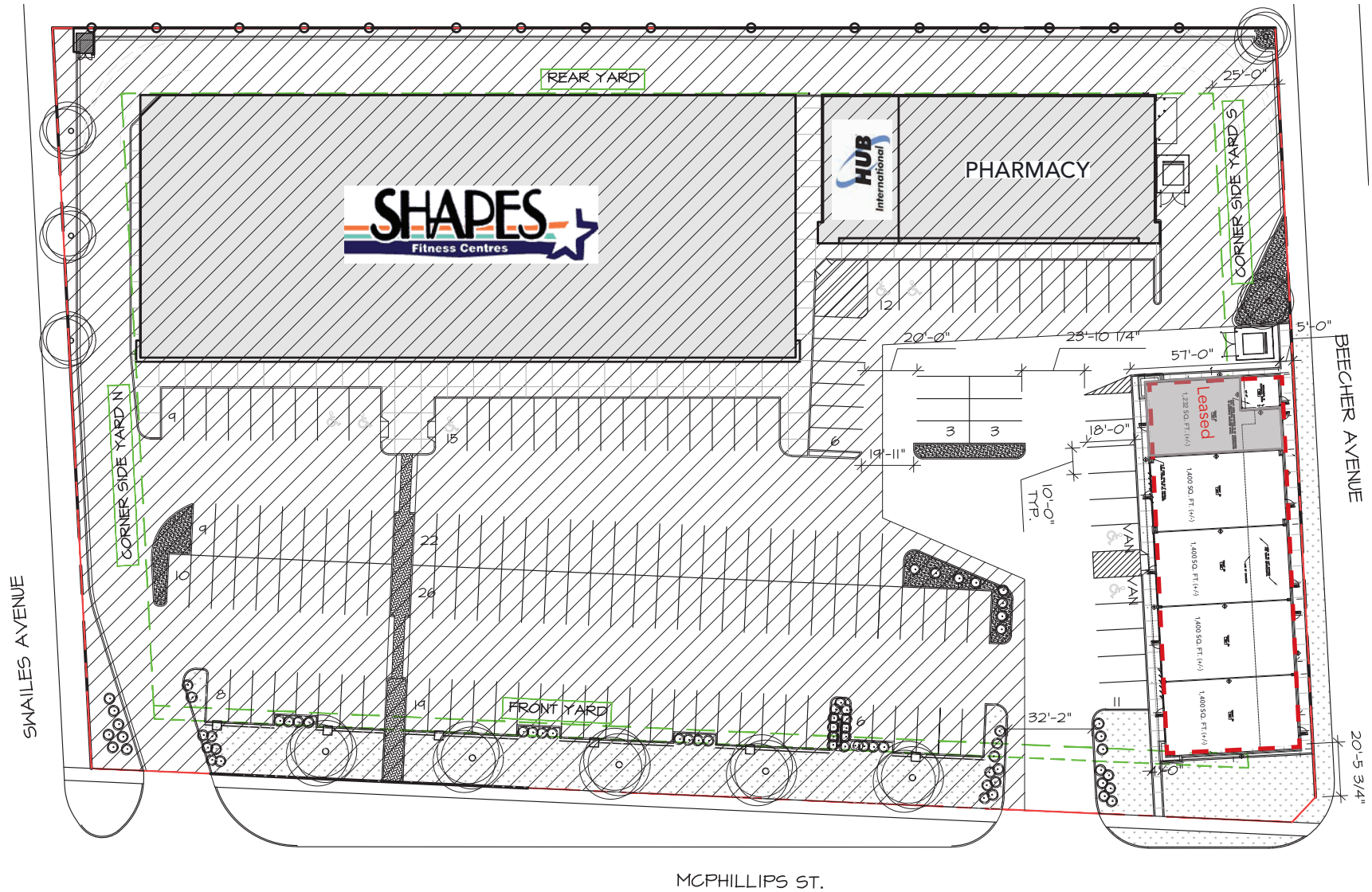

2501 McPhillips Street

Retail Aerial

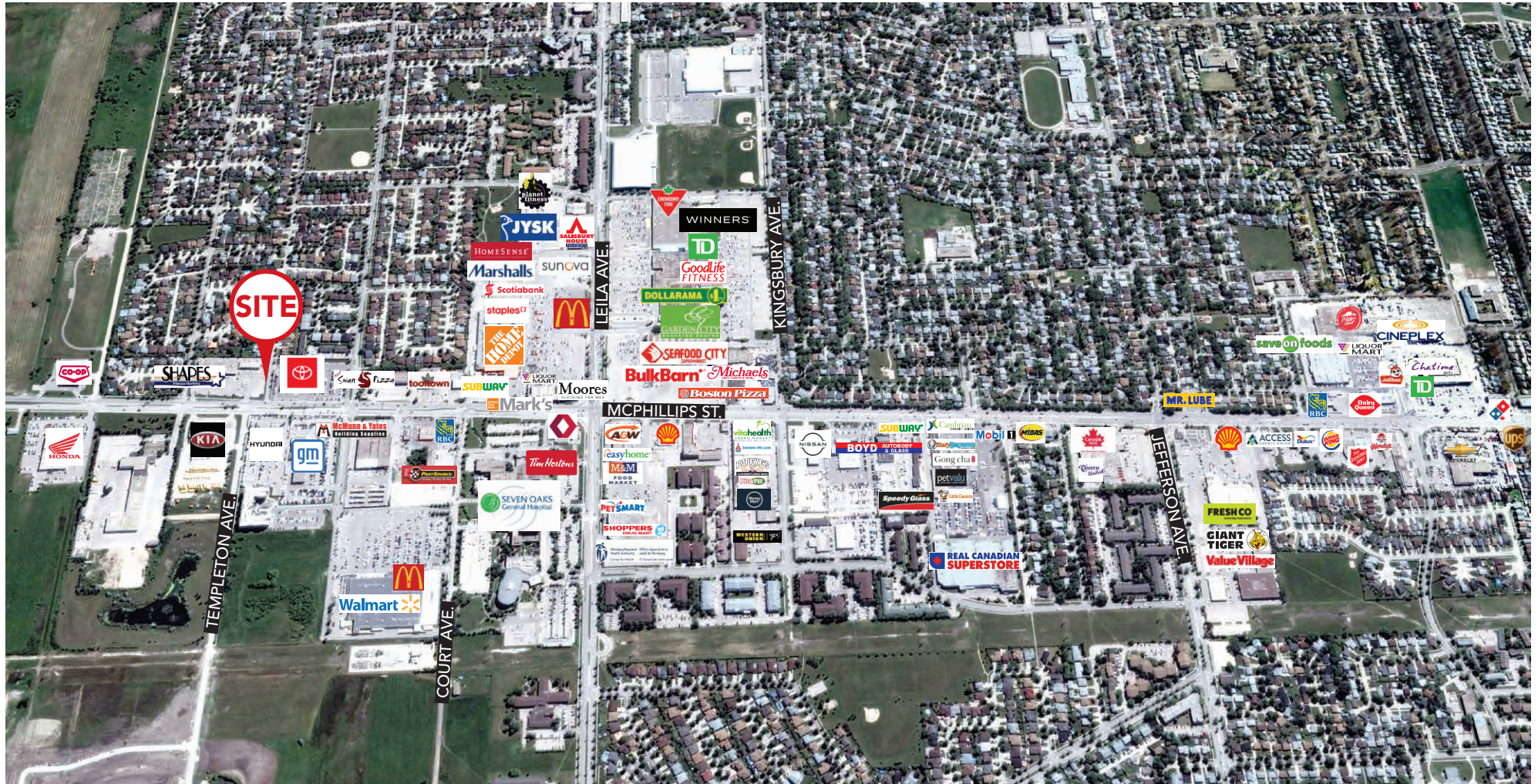

2501 McPhillips Street

Floor Plan

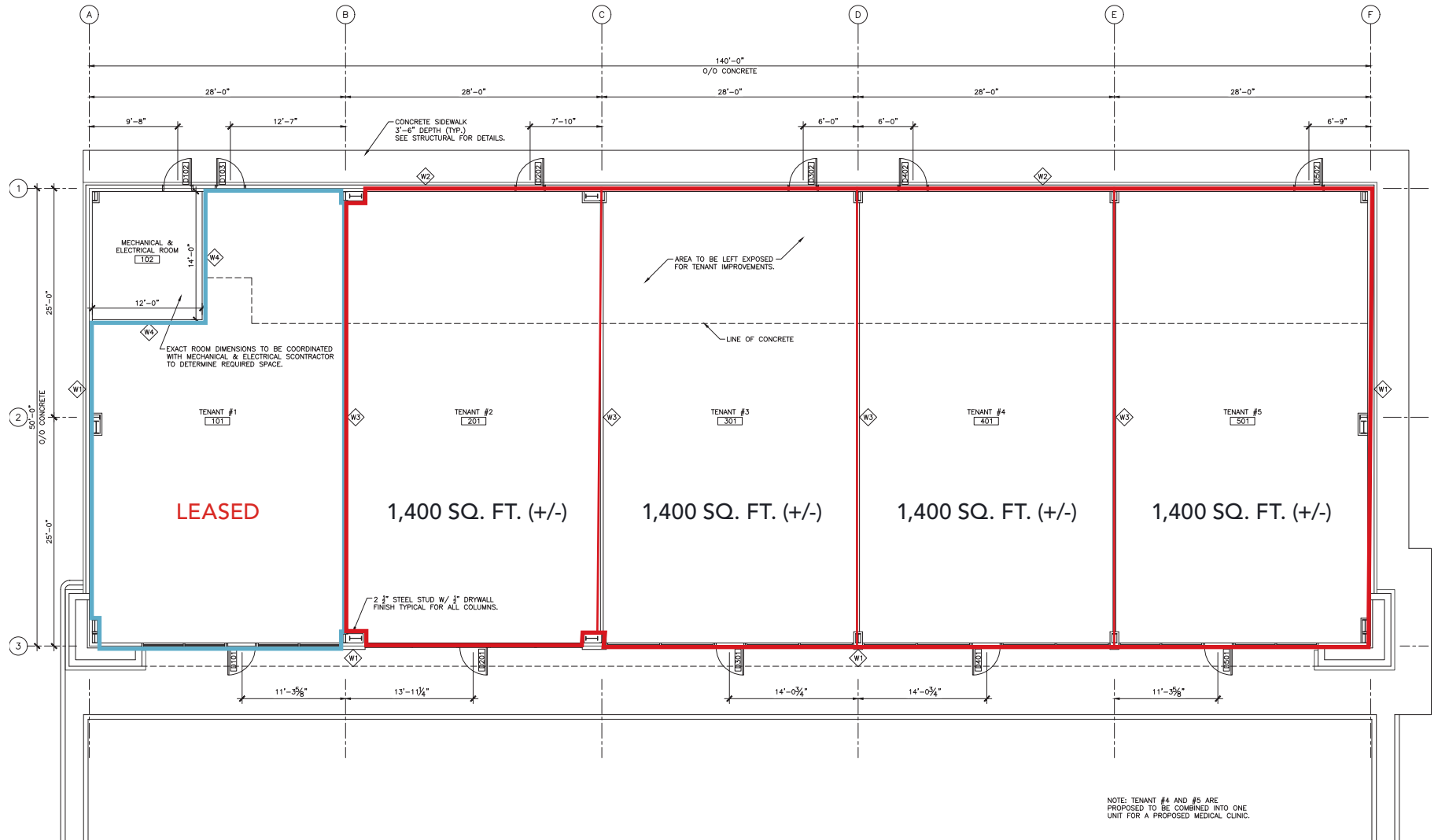

2501 McPhillips Street

Demographic Analysis

POPULATION



	2022	2027 (f)
1 KM	4,406	5,363
3 KM	59,745	64,517
5 KM	156,965	166,198

MEDIAN AGE



	Median Age
1 KM	38
3 KM	38
5 KM	38

HOUSEHOLD INCOME



	2022	2027 (f)
1 KM	\$99,278	\$117,319
3 KM	\$96,370	\$113,419
5 KM	\$89,839	\$105,708

HOUSEHOLDS



	Total Households
1 KM	1,604
3 KM	20,207
5 KM	55,308

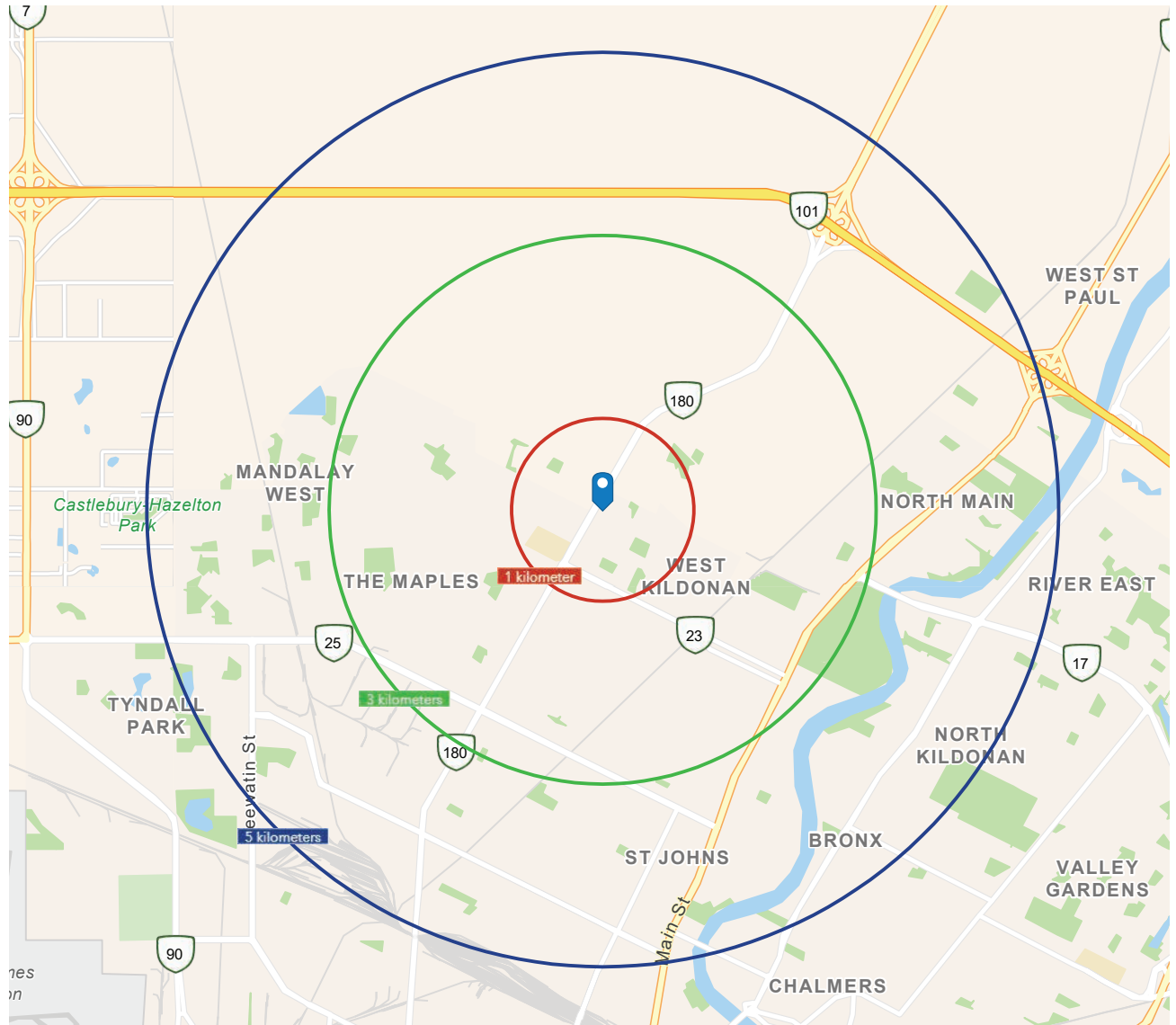



COMMERCIAL REAL ESTATE
SERVICES INC.

SIGNAGE

SIGNAGE

SIGNAGE

SIGNAGE

CAPITAL COMMERCIAL REAL ESTATE SERVICES INC.

300 - 570 Portage Avenue, Winnipeg, Manitoba R3C 0G4

T (204) 943-5700 | F (204) 956-2783 | capitalgrp.ca

Brett Chartier

Senior Advisor - Sales & Leasing

(204) 985-1366

brett.chartier@capitalgrp.ca

Services provided by Brett Chartier Personal Real Estate Corporation

Presley Bordian

Advisor - Sales & Leasing

(204) 985-1356

presley.bordian@capitalgrp.ca

Disclaimer: Capital Commercial Real Estate Services Inc. ("Capital") does not accept or assume any responsibility or liability, direct or consequential, for the information set out herein, including, without limitation, any projections, images, opinions, assumptions and estimates obtained from third parties. This information has not been verified by Capital, and Capital does not guarantee the accuracy, correctness and completeness of this information. The recipient of this information should take such steps as the recipient may deem necessary to verify the information in this document prior to placing any reliance upon it. The information may change and any property described in this document may be withdrawn from the market at any time without notice or obligation to the recipient from Capital.