



**298,597 SF MODERN OFFICE BUILDING - UNDER CONSTRUCTION**

545

wyn

545 NW 26<sup>th</sup> Street  
Wynwood Art District  
Miami, Florida



**Newmark  
Knight Frank**

**Sterling Bay**

The information contained herein has been obtained from sources deemed reliable but has not been verified and no guarantee, warranty or representation, either express or implied, is made with respect to such information

# 545 wyn

Over 298,597 SF of modern office space on ten floors, with floorplates ranging from 18,621 to 38,272 SF

Opportunity for prominent building signage with unobstructed views to Interstate 95

26,337 SF of retail

Elevated corporate signage opportunities

Dedicated tenant entrance available

Open-air balconies on each floor

18,621 SF amenity deck (5<sup>th</sup> Floor)

On-site fitness center

On-site covered parking for 420 cars

Separately metered electric for full-floor tenants

Construction currently underway

Delivering mid-2020

## Wynwood

is globally recognized as a premier destination for art, fashion, innovation and creative enterprises. It is one of the largest and most prominent creative communities in the United States, and where a new generation of creative and entrepreneurs live, work, eat, play and learn. Wynwood has attracted a new kind of community of artists, visionaries, and thinkers.

## THE NEIGHBORHOOD'S IN FULL BLOOM

CLICK TO VIEW  
360 VR TOUR





# 545

# wyn

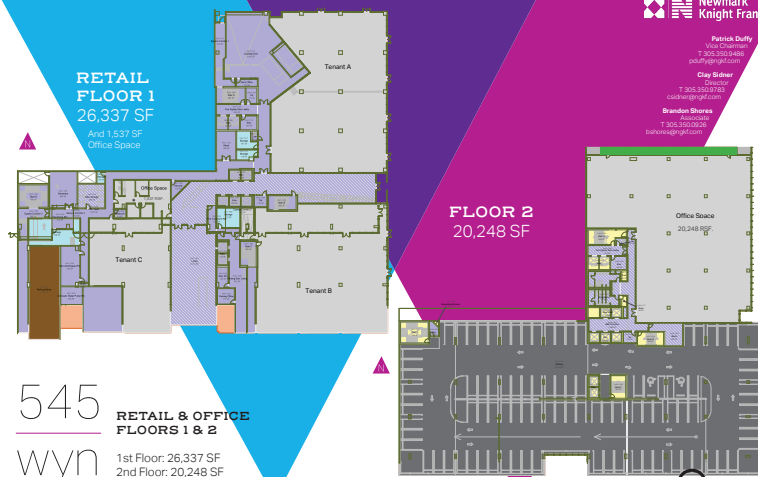

CLICK TO VIEW  
FLOOR PLANS

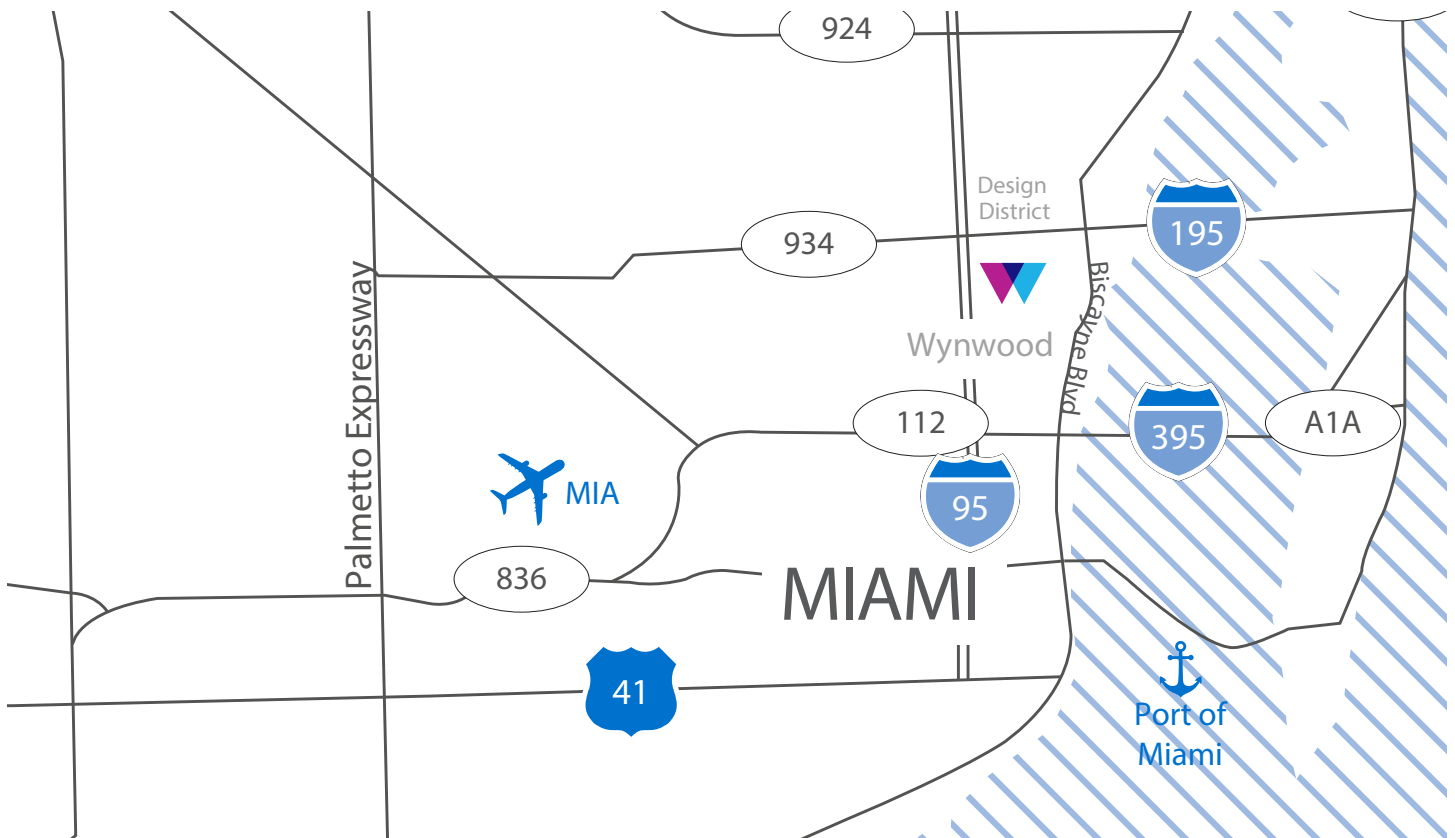

# 545 wyn



**Patrick Duffy**  
Vice Chairman  
T 305.350.9486  
[pduffy@ngkf.com](mailto:pduffy@ngkf.com)

**Clay Sidner**  
Director  
T 305.350.9783  
[csidner@ngkf.com](mailto:csidner@ngkf.com)

**Brandon Shores**  
Associate  
T 305.350.0926  
[bshores@ngkf.com](mailto:bshores@ngkf.com)

[www.545wyn.com](http://www.545wyn.com)

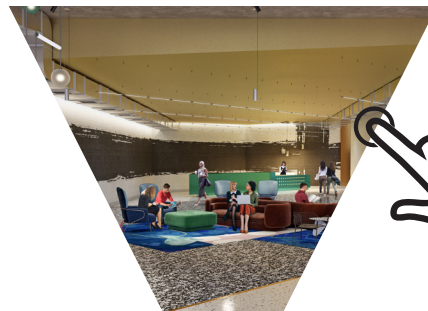

CLICK TO  
VIEW GALLERY