



## PROPERTY DETAILS

- Immediate Occupancy and partially furnished - Plug and Play
- Space available from 1,221 SF up to entire building of 6,506 SF
- Prominent signage on East Oakland Park Boulevard with 36,500 cars per day traffic count
- Convenient front and rear parking areas
- Close to major retail areas including Galleria Mall and Coral Ridge Mall
- Easy access to major residential areas- Coral Ridge CC, Bayview, Galt Ocean Mile
- Close proximity to US 1 and I-95
- 2024 Estimated CAM- \$10.00 PSF

## ABOUT PROPERTY



### PRICE

\$35.00 SF/yr (NNN)



### YEAR BUILT

1960/Renov. 2021



6,506 SF



### PARKING

25 spaces



### LOCATION

East Fort Lauderdale

For more information:

**Steve Hyatt**

954.494.3091 | [Shyatt@Bergercommercial.com](mailto:Shyatt@Bergercommercial.com)  
[bergercommercial.com](http://bergercommercial.com)



COMMERCIAL BROKERAGE AND PROPERTY MANAGEMENT



For more information:

**Steve Hyatt**

954.494.3091 | [Shyatt@Bergercommercial.Com](mailto:Shyatt@Bergercommercial.Com)  
[bergercommercial.com](http://bergercommercial.com)



COMMERCIAL BROKERAGE AND PROPERTY MANAGEMENT







2700 E OAKLAND PARK BLVD  
FORT LAUDERDALE, FL 33306

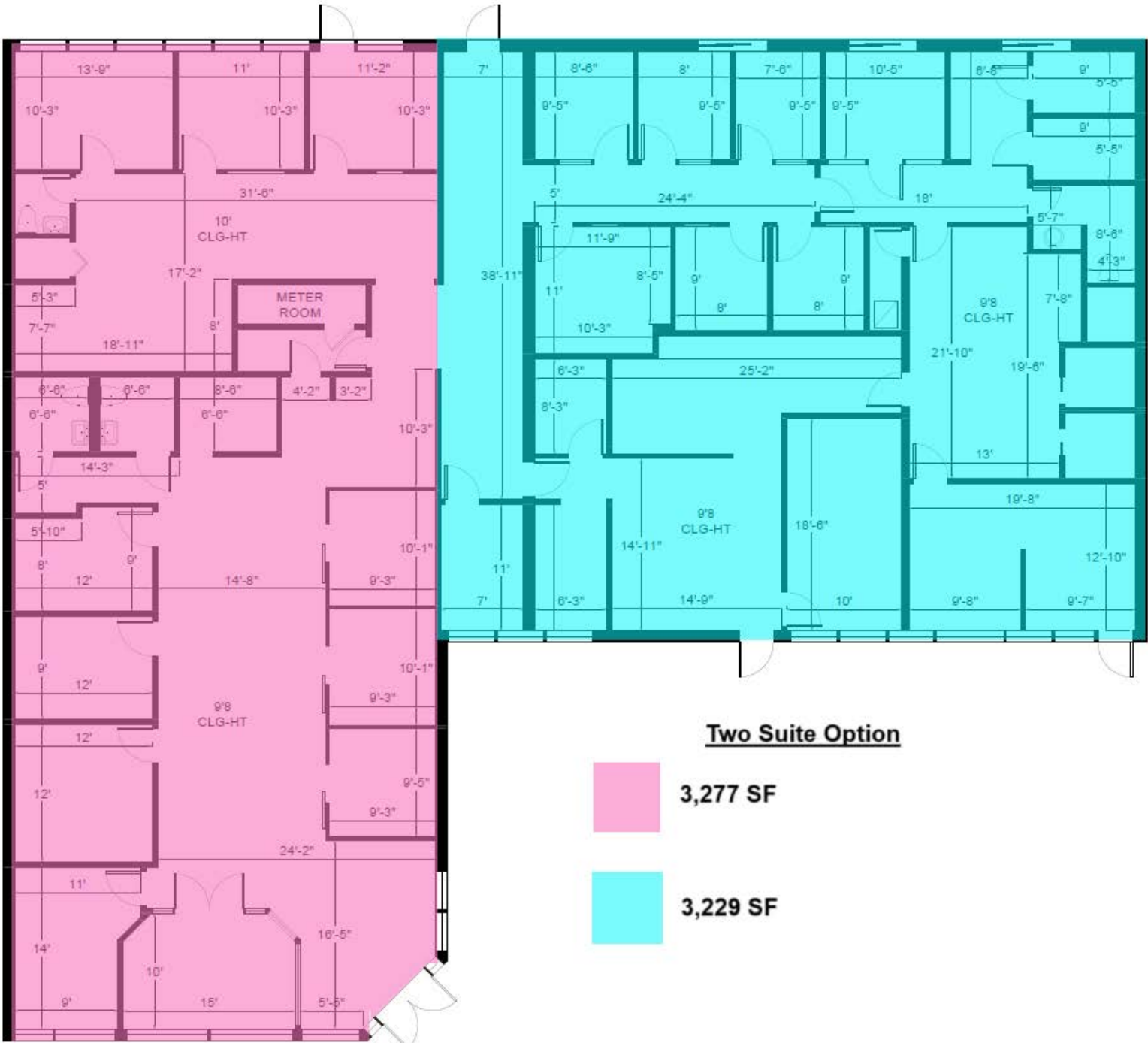

**Two Suite Option**

- 3,277 SF**
- 3,229 SF**



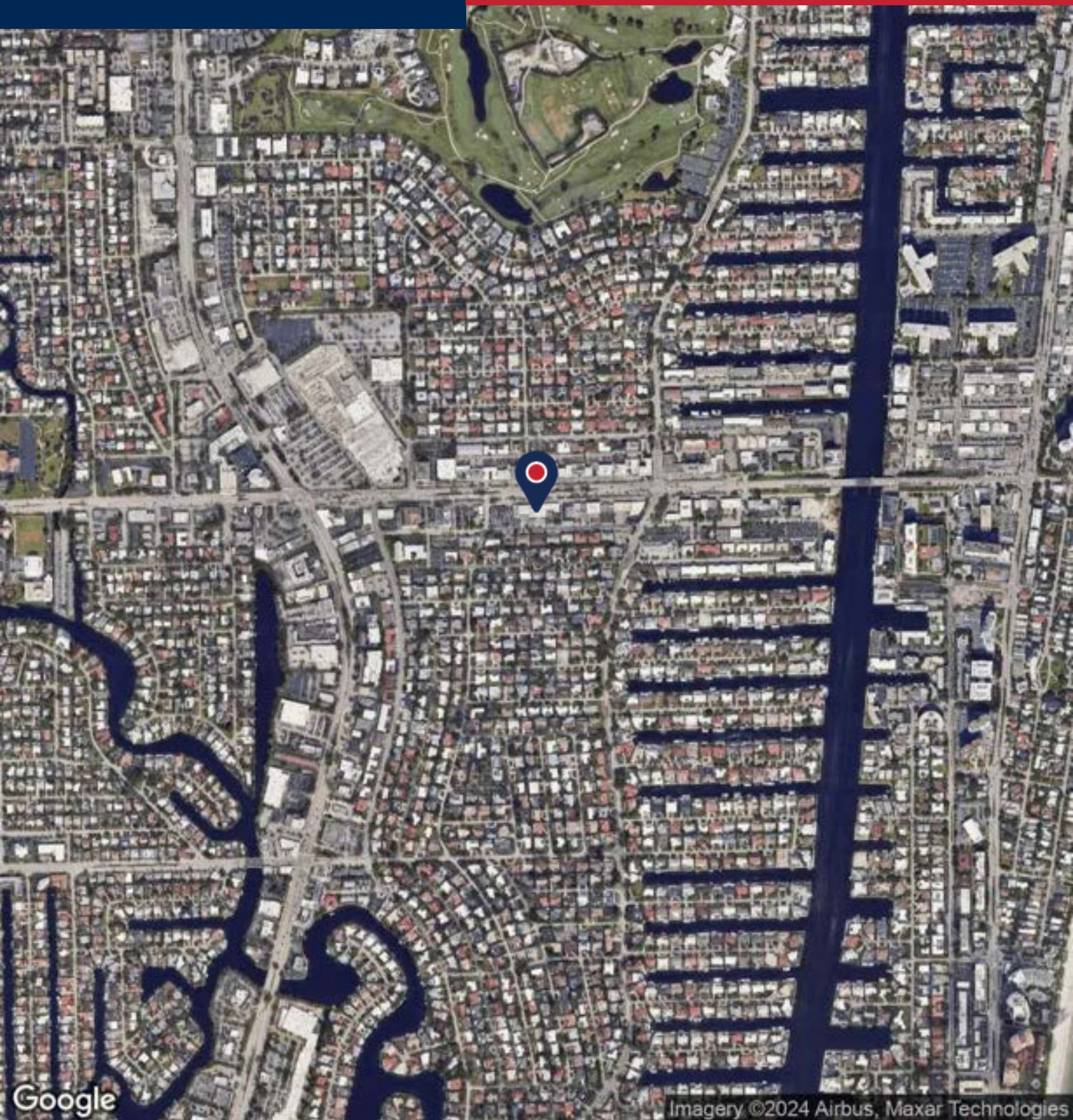

For more information:

**Steve Hyatt**

954.494.3091 | [Shyatt@Bergercommercial.Com](mailto:Shyatt@Bergercommercial.Com)  
[bergercommercial.com](http://bergercommercial.com)



COMMERCIAL BROKERAGE AND PROPERTY MANAGEMENT



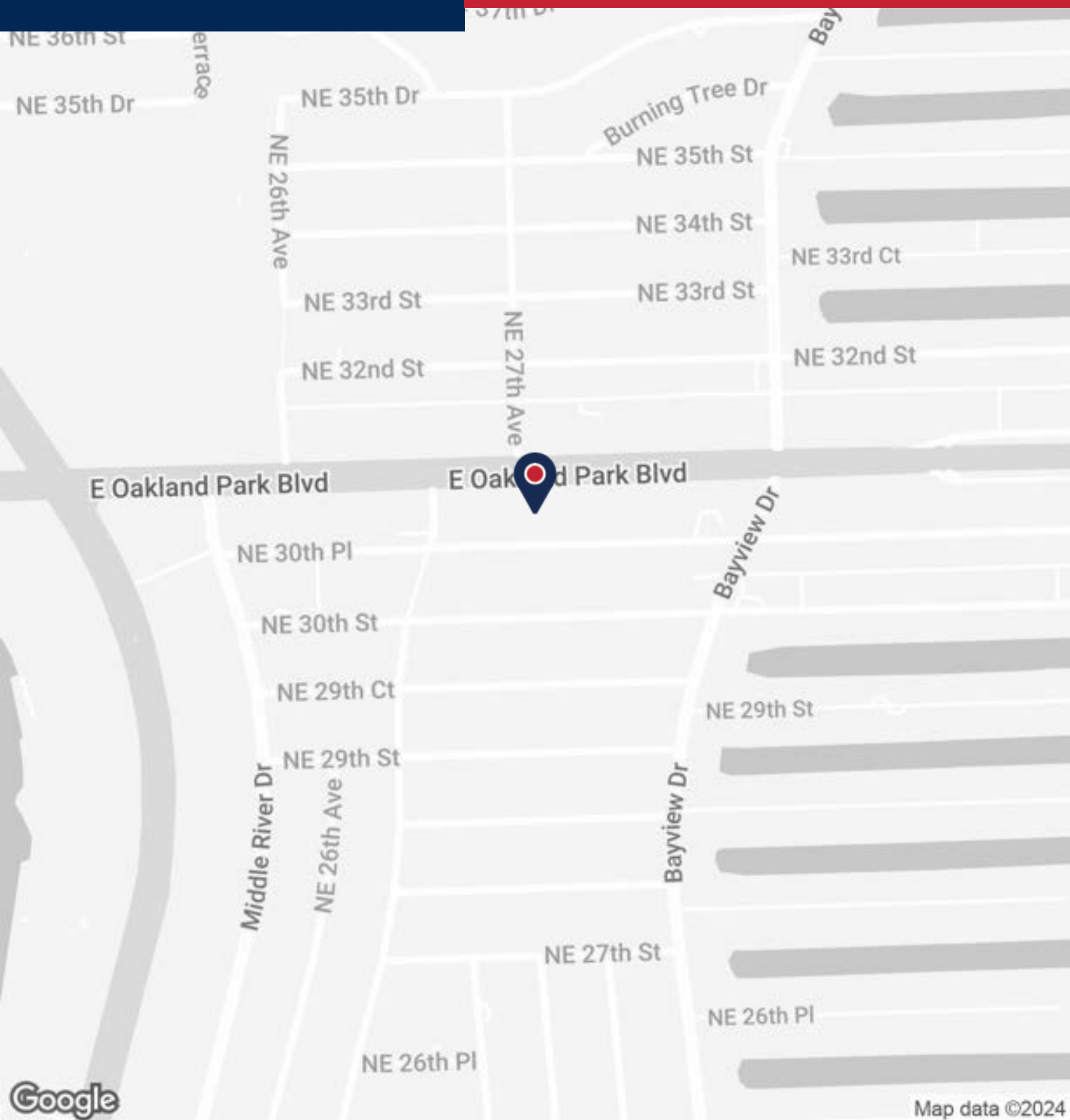

For more information:

**Steve Hyatt**

954.494.3091 | [Shyatt@Bergercommercial.com](mailto:Shyatt@Bergercommercial.com)  
[bergercommercial.com](http://bergercommercial.com)



COMMERCIAL BROKERAGE AND PROPERTY MANAGEMENT