



**1634 19TH STREET  
SANTA MONICA, CA 90404**



PREMISES ± 1,409 SF

RENT \$3.25/SF, MG

OCCUPANCY Immediate

TERM 3 - 5 Years

PARKING 2 Car Parking Included

#### FEATURES

- Freestanding Creative Building
- Five Private Offices
- High Exposed Ceilings with Skylights
- New Full Kitchen
- New Bathroom
- Ample Outside Space
- Within Five (5) Minutes of the Santa Monica Freeway

#### CONTACT

James Wilson  
310.899.2708  
jwilson@leewestla.com  
AGT DRE 00883324

David Wilson  
310.899.2707  
dwilson@leewestla.com  
AGT DRE 00822760



A DIVISION OF

**LEE &  
ASSOCIATES**

1508 17th Street, Santa Monica, CA 90404

310.899.2700 | [www.leewestla.com](http://www.leewestla.com) | DRE 01222000

No warranty or representation is made to the accuracy of the foregoing information.  
Terms of sale or lease are subject to change or withdrawal without notice.



**1634 19TH STREET  
SANTA MONICA, CA 90404**



# COMPOUND PLAN

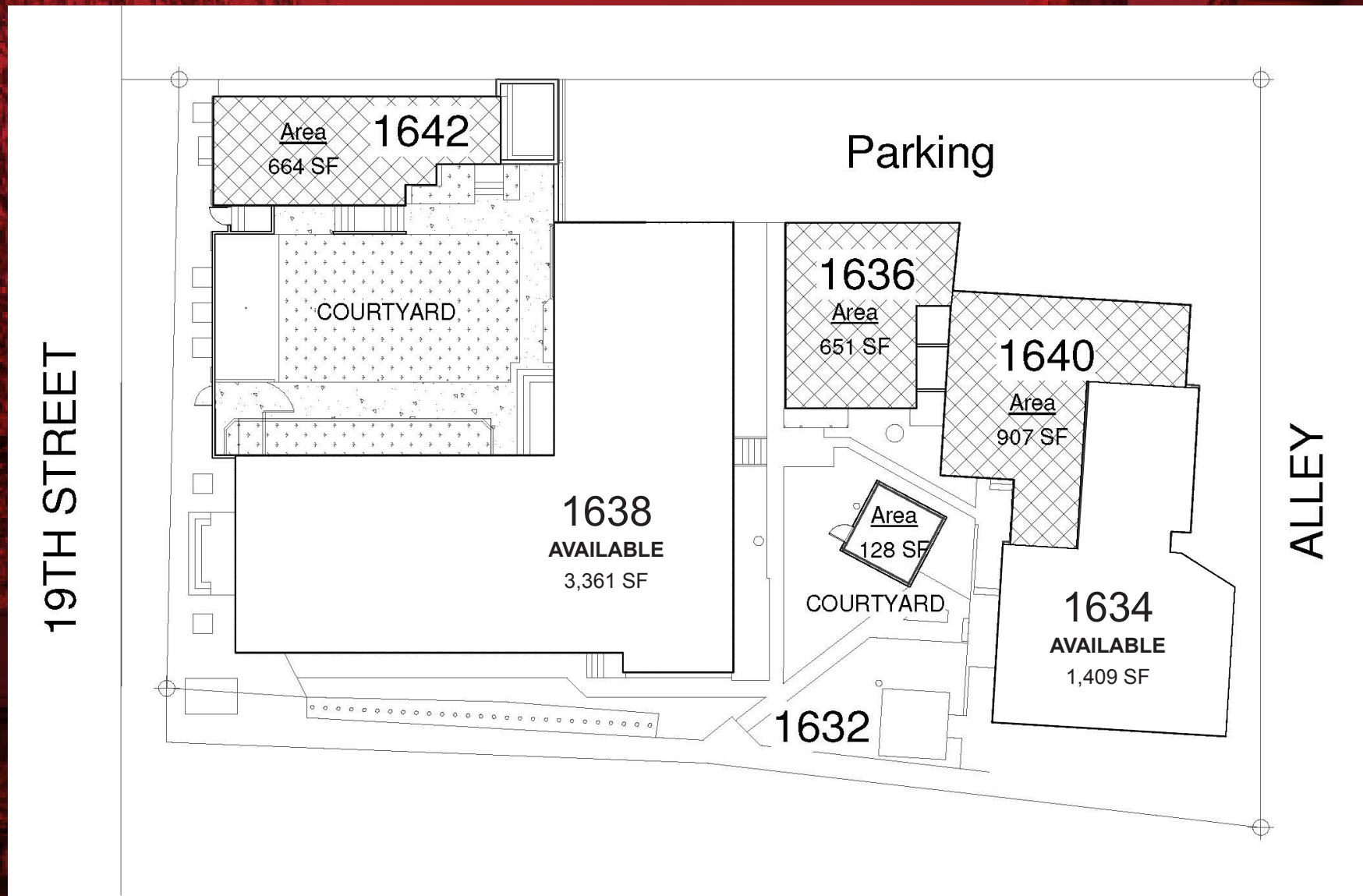

A DIVISION OF  
**LEE & ASSOCIATES**

James Wilson

310.899.2708

[jwilson@leewestla.com](mailto:jwilson@leewestla.com)

AGT DRE 00883324

David Wilson

310.899.2707

[dwilson@leewestla.com](mailto:dwilson@leewestla.com)

AGT DRE 00822760