

For lease

Industrial outdoor storage

6601 & 6801 E. Adamo Dr.,
Tampa, Florida 33619



6601 & 6801 E. Adamo Dr, Tampa, FL

6601 E. Adamo Dr

Address	6601 E. Adamo Dr Tampa, Florida 33619
Sq.Ft.	17,400
Acres	2.3
Clear height	20.5'
Year Built	1988
Loading	One (1) 10'x14' drive in door Two (2) 10'x11' dock-high doors One (1) 9'x10' van-high door
Zoning	IH (heavy industrial)
Site Features	Fenced and lit outdoor storage



6601 & 6801 E. Adamo Dr, Tampa, FL

6601 E. Adamo Dr.



6601 E. Adamo Dr. Floor Plan



6601 & 6801 E. Adamo Dr, Tampa, FL

6801 E. Adamo Dr

Address	6801 E. Adamo Dr Tampa, Florida 33619
Sq.Ft.	17,400
Acres	2.17
Clear height	20'
Year Built	1972
Loading	One (1) 16'x10' dock-high door Five (5) 9'x10' dock-high doors One (1) 9'x10' drive-in ramp Two dock-levelers
Zoning	IH (heavy industrial)
Site Features	Fenced and lit outdoor storage



6601 & 6801 E. Adamo Dr, Tampa, FL

6801 E. Adamo Dr.



6601 & 6801 E. Adamo Dr, Tampa, FL

6801 E. Adamo Dr.

Floor Plan

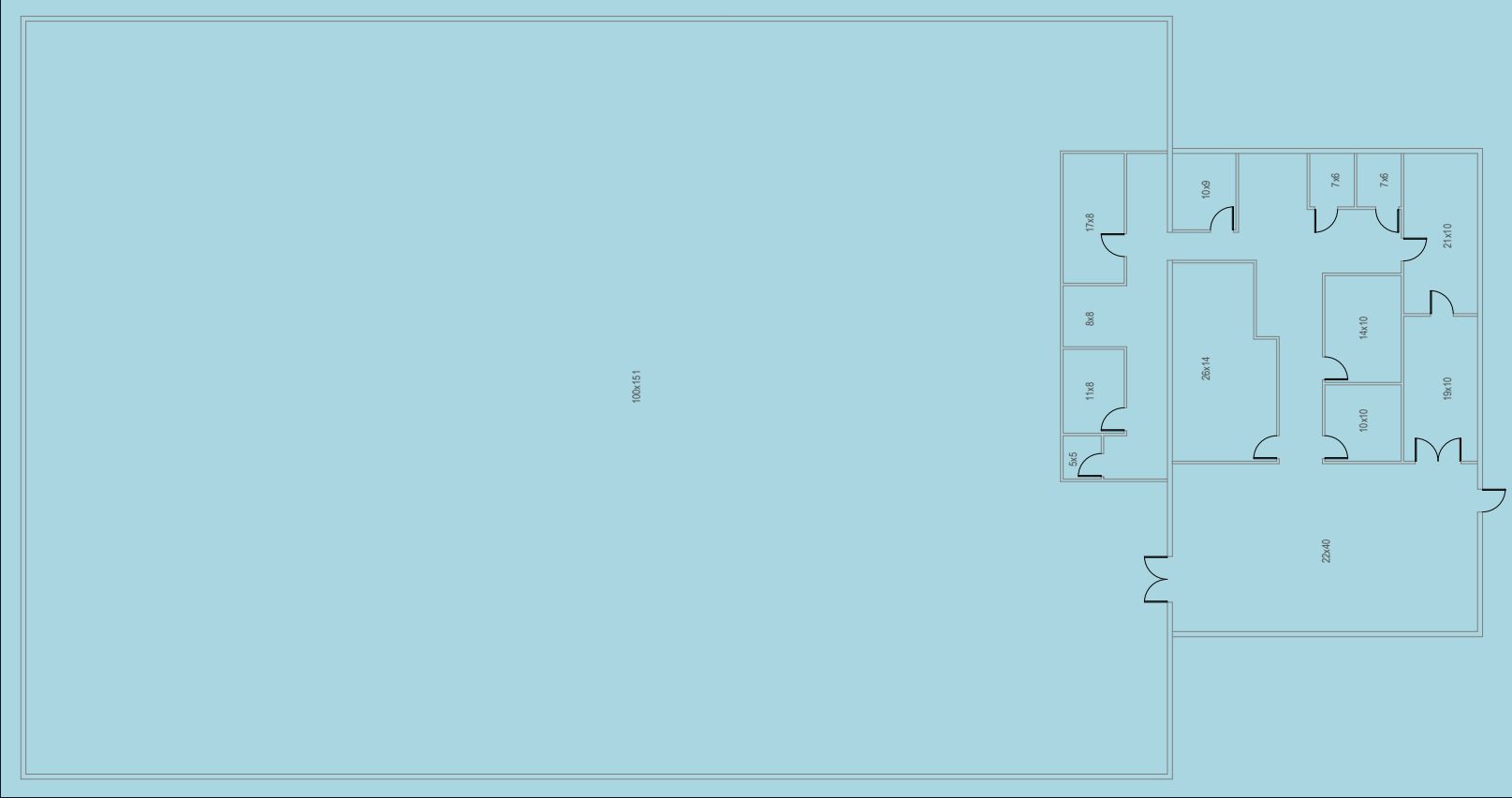

Location Map

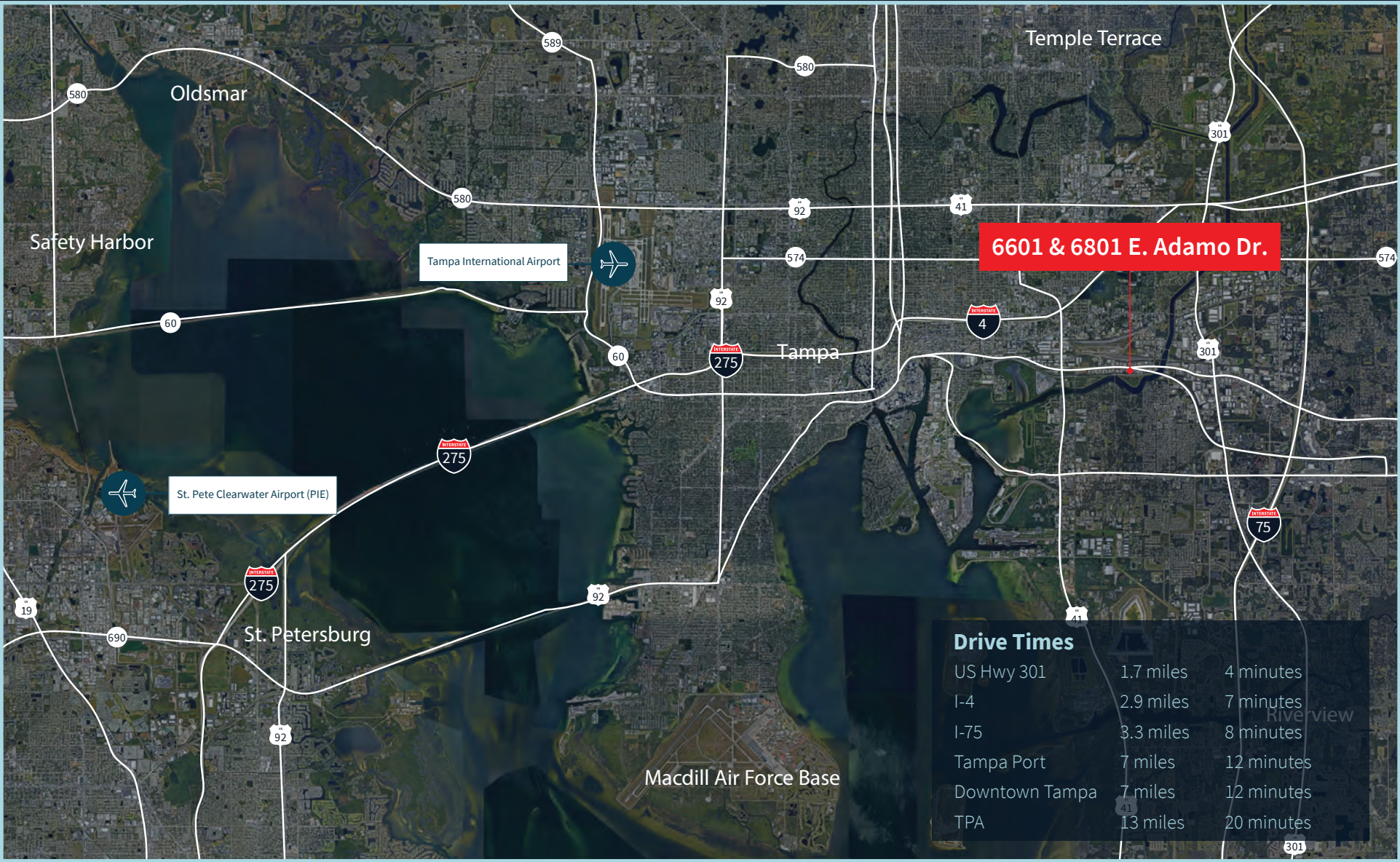

Contact:

Pete Cecora, SIOR

Senior Managing Director

+1 813 387 1297

peter.cecora@jll.com

Olivia Brock

Associate

+1 813 387 1320

olivia.brock@jll.com