

For
Lease

413 Industrial
Drive

North Wales, PA



WAREHOUSE UNIT

4,000 SF AVAILABLE

- 16,000 SF BUILDING



Property Specifications

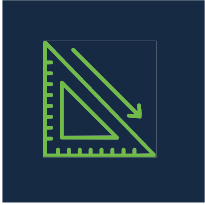

4,000 SF

Parcel #: 56-00-01884-607

2.47 acres

750 SF office



Loading

Grade level drive-in door in front

Loading dock in rear



Zoning

Zoned Limited Industrial in Upper Gwynedd Township

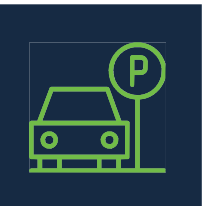

Parking

20 parking spaces onsite



Building Features

Public water and sewer

Serviced by electric and natural gas

Generally 13' clear height





Site

4,000 SF UNIT
 Situated on 2.47 Acres

The Flynn Company is pleased to represent InSpace on their seven-building small bay complex located in Upper Gwynedd Twp, PA. Strategically located between I-309 and I-476, the complex is within close proximity to Merck and other major employers, and within walking distance the North Wales SEPTA train station. Purpose-built to accommodate small users, each building is designed with drive-in and loading dock capabilities, shop and office restrooms along with office space.

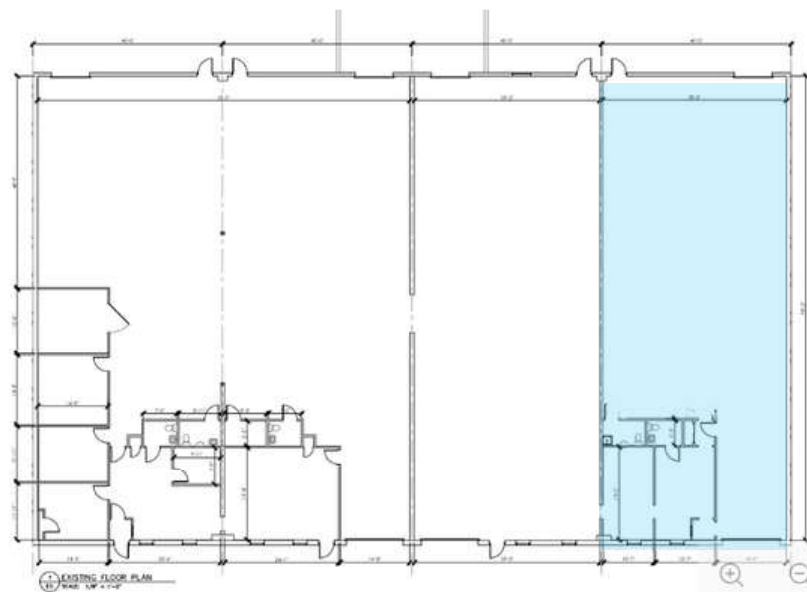

For
Lease

413 Industrial

North Wales, PA

Drive

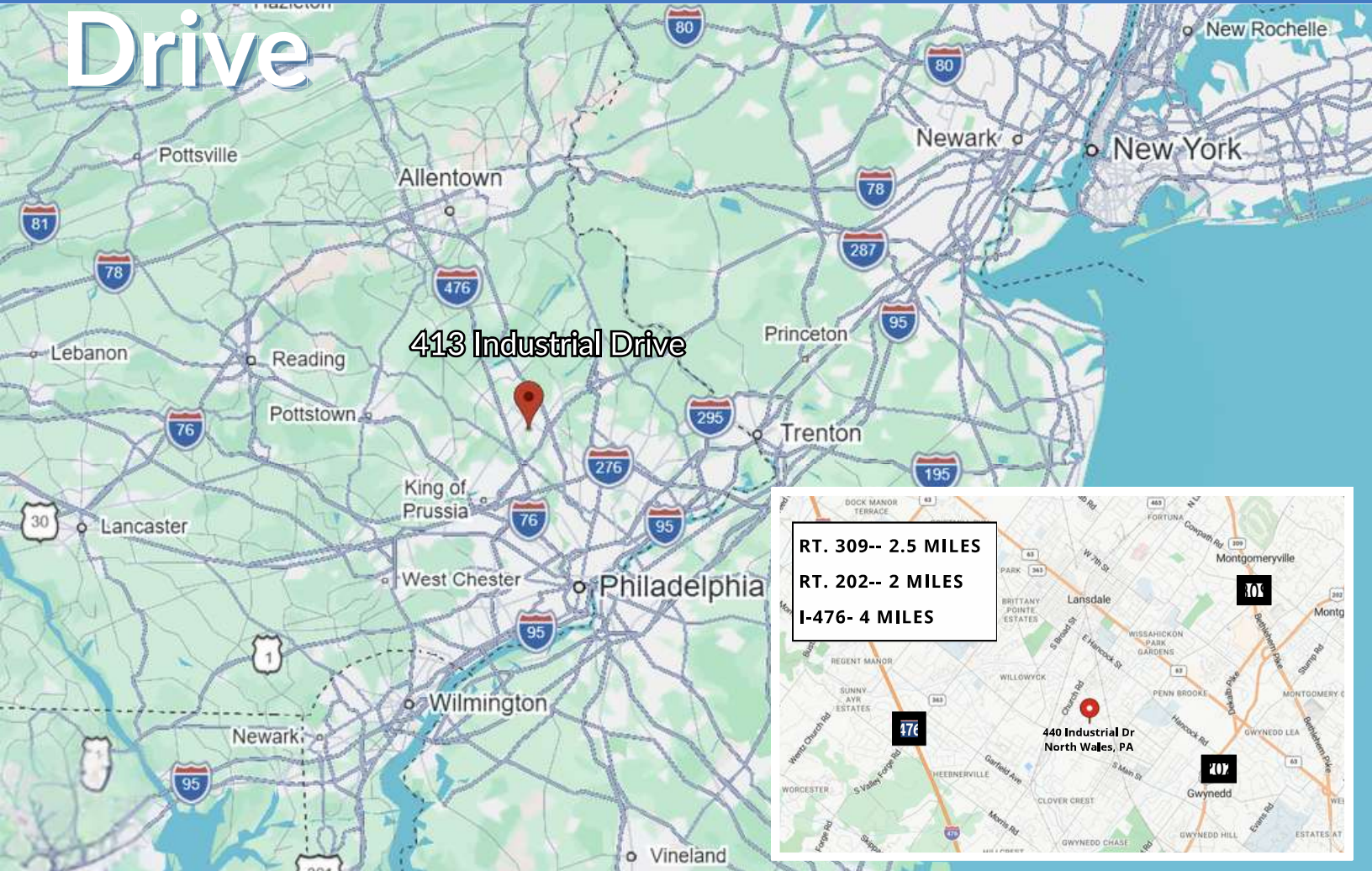

Contact us to arrange a tour!

Mike Borski, Jr., SIOR
mborskijr@flynnco.com

Mark Pawlowski
mpawlowski@flynnco.com

Andy Pancoast
apancoast@flynnco.com

