 **JLL** SEE A BRIGHTER WAY

For lease

47,250 SF Available

North Park IV

4438 Muhlhauser Rd, Suite 200

West Chester, OH

Mark Volkman, SIOR

Senior Managing Director

mark.volkman@jll.com

+1 (513) 252 2123

www.jll.com/cincinnati

47,250 SF Available

NorthPark IV is a 236,250 SF distribution building. Great West Chester location with easy access to I-275 and I-75. No earnings tax.

Property Highlights

Available SF:	47,250 SF
Office SF:	1,550 SF
Ceiling Height:	28'
Building Depth:	315'
Column Spacing:	50'x x 52'd
Docks:	7 - 9' x 10' overhead positions with 35,000 lb levelers
Sprinkler System:	ESFR
Power:	200 amps; 480/277V, 3 Phase
Lighting:	LED
Drive In:	1

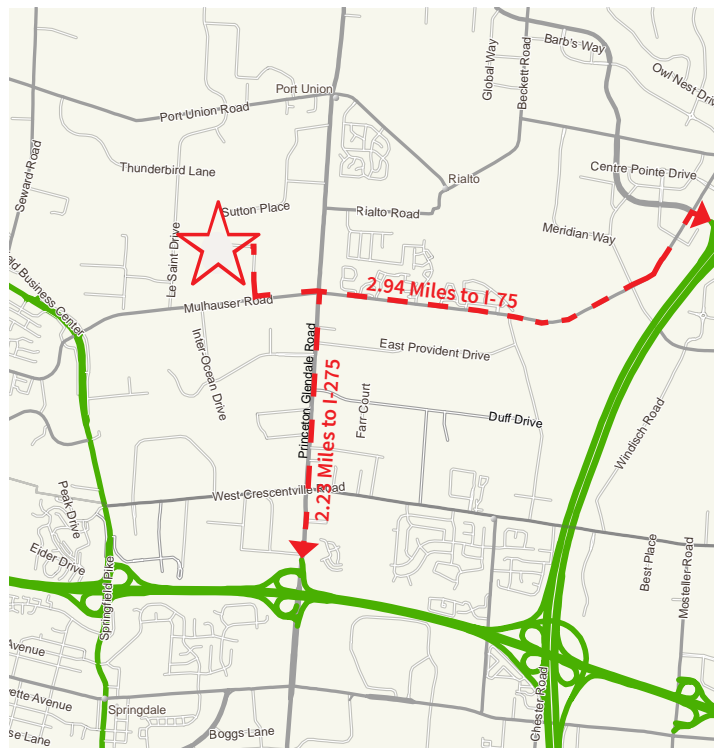

For lease

Space Plan

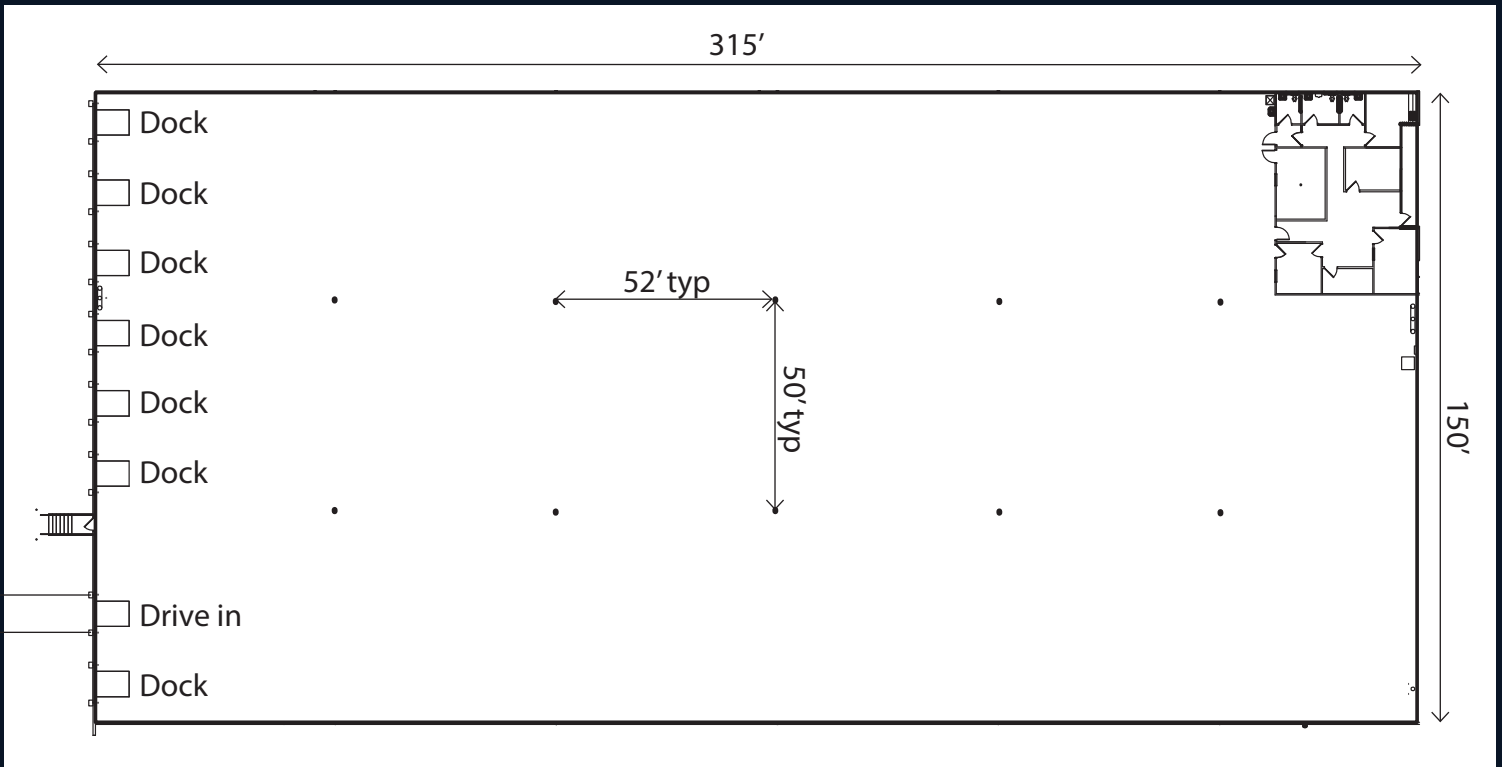

Mark Volkman, SIOR
Senior Managing Director
mark.volkman@jll.com
+1 (513) 252 2123