

±9,557 SF MEDICAL/RETAIL SPACE FOR LEASE TWIN PARKS TERRACE

373 East 183rd Street, Bronx, New York 10458



RM FRIEDLAND

COMMERCIAL REAL ESTATE SERVICES

BRAND NEW MIXED USE DEVELOPMENT IN THE
FORDHAM HEIGHTS SECTION OF THE BRONX

±9,557 SF MEDICAL/RETAIL SPACE FOR LEASE TWIN PARKS TERRACE

373 East 183rd Street, Bronx, New York 10458

SPACE AVAILABLE

UNIT 1: ±4,780 SF Ground Floor
±2,390 SF Min Division

UNIT 2: ±4,777 SF Ground Floor

RENTAL RATE

Upon Request

ADDITIONAL INFORMATION

- Newly built affordable housing building
- Located at the corner of Webster Ave & East 183rd Street
- Walking distance to Fordham Rd, one of the borough's major shopping destinations
- Just outside Little Italy area of The Bronx
- Across from a New York City Housing Authority development known as Twin Parks West. It will be a 14-story mixed use development with 182 residential units, 9,549 SF of commercial space, and 2,944 SF of community facility.
- Easy access to Bx12-SBS, Bx15, B, D, and #4 Trains (182nd-183rd St Station)

±9,557 SF MEDICAL/RETAIL SPACE FOR LEASE TWIN PARKS TERRACE

373 East 183rd Street, Bronx, New York 10458

FLOOR PLAN-GROUND FLOOR

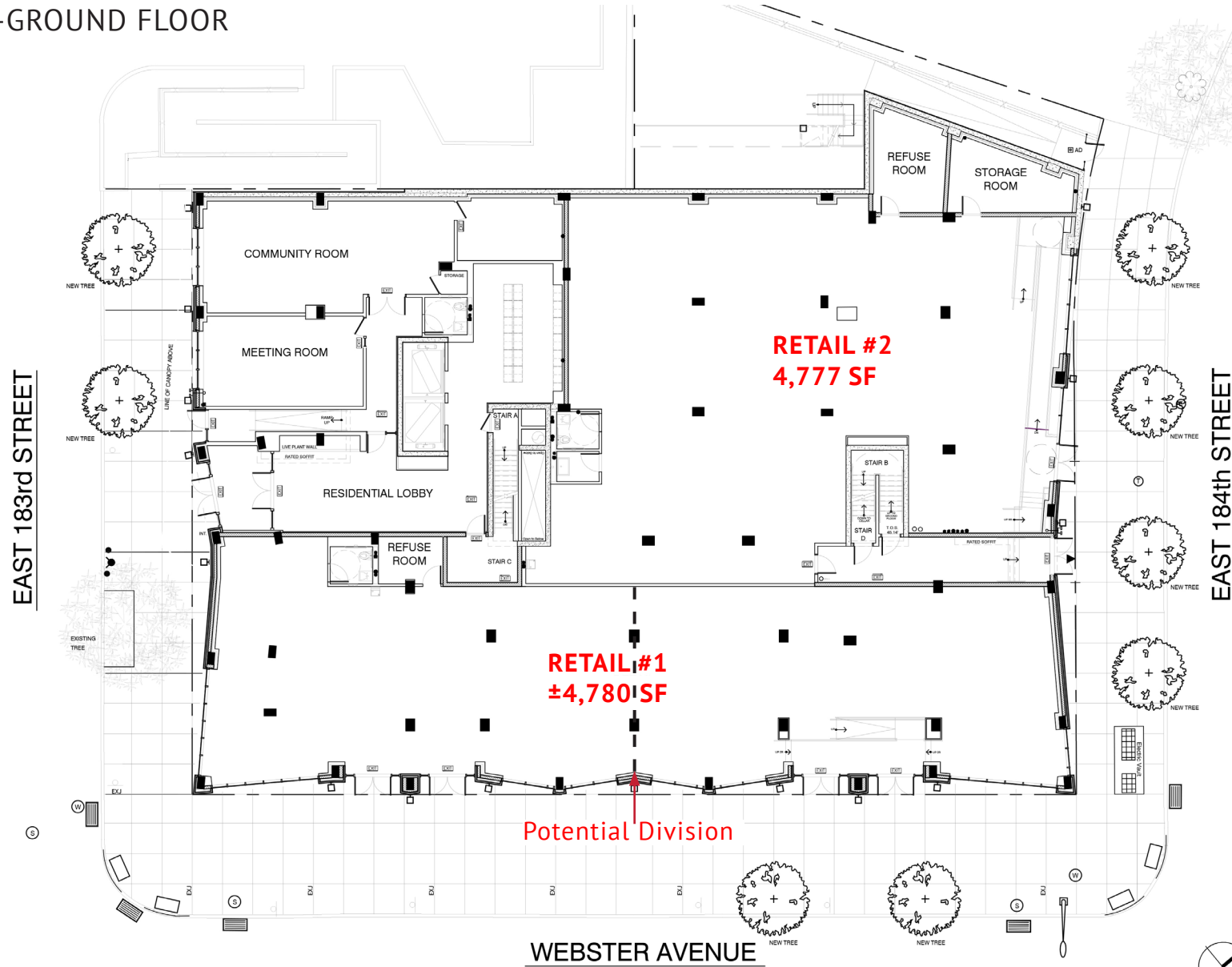

±9,557 SF MEDICAL/RETAIL SPACE FOR LEASE

TWIN PARKS TERRACE

373 East 183rd Street, Bronx, New York 10458



CONTACT EXCLUSIVE LISTING AGENTS:

MIA ABDOU

(914) 968-8500 X 326
mabdou@rmfriedland.com

KATHY ZAMECHANSKY

(347) 386-9452
kzama@aol.com



375