

FOR LEASE
B104: 11,633 SF

WEST PARK CORPORATE CAMPUS
3500 W VALLEY HWY N | AUBURN, WA



DOCK HIGH WAREHOUSE/OFFICE SPACE

FEATURES

- 11,633 SF total
- Includes 1,000 SF office
- 2 dock high doors, 1 grade level door
- 3-phase power
- 30' clear height
- Excellent office layout
- Sprinklered
- Excellent Highway 167 frontage
- Class A image
- Excellent access and proximity to I-5, SR-18 and Hwy-167
- Built in 2000
- Available Now
- **Contact Brokers for Rates**

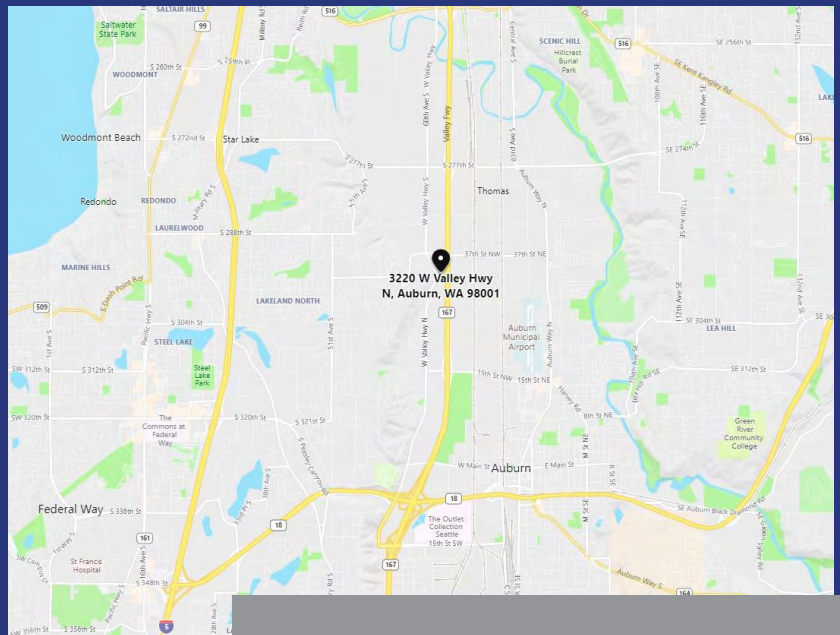

EXCLUSIVELY OFFERED BY:

Arne Svendsen
(206) 947-2885
asvendsen@andoverco.com

Brian Bruininks, CCIM
(206) 336-5324
bbruininks@andoverco.com



West Park Corporate Campus is owned and operated by:



The information contained herein has been obtained from reliable sources, but is not guaranteed. A prospective buyer/tenant should verify each item relating to this property and all information contained herein.

FOR LEASE
B104: 11,633 SF

WEST PARK CORPORATE CAMPUS

3500 W VALLEY HWY N | AUBURN, WA

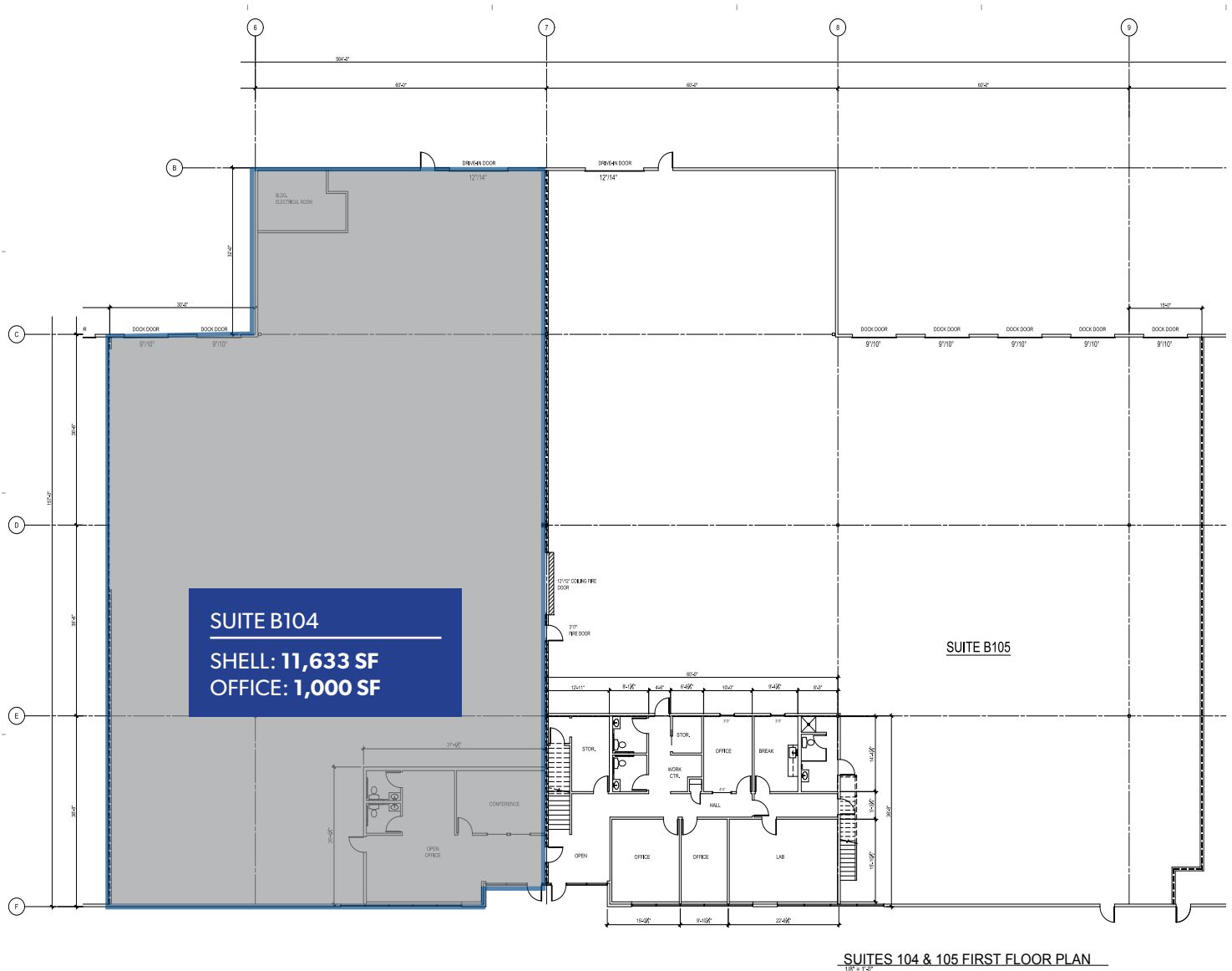

EXCLUSIVELY OFFERED BY:

Arne Svendsen
(206) 947-2885
asvendsen@andoverco.com

Brian Bruininks, CCIM
(206) 336-5324
bbruininks@andoverco.com



West Park Corporate Campus is owned and operated by:



The information contained herein has been obtained from reliable sources, but is not guaranteed. A prospective buyer/tenant should verify each item relating to this property and all information contained herein.