

Industrial / Flex Space

NW Omaha Industrial Warehouse

9570 Ida Street
Omaha, Nebraska 68122
www.cbre.com/nebraska

Fenced-in Outdoor Storage





Property Information

Space Available	10,052 SF
Lease Rate	\$10.00 PSF, NNN
Estimated NNNs	\$3.00 PSF (2026)
Year Built	2004 + 2016 Addition

Features

- + Move-in ready August 1, 2026
- + Fully-fenced site in NW Omaha with easy interstate access
- + 16' ceiling height
- + Large outdoor storage area; fenced & paved
- + 13 drive-in doors total; five with drive-thru loading capacity and rear outdoor storage
- + Additional lean-tos and 1,200 SF storage warehouse not included in the rentable square feet

Floor Plan

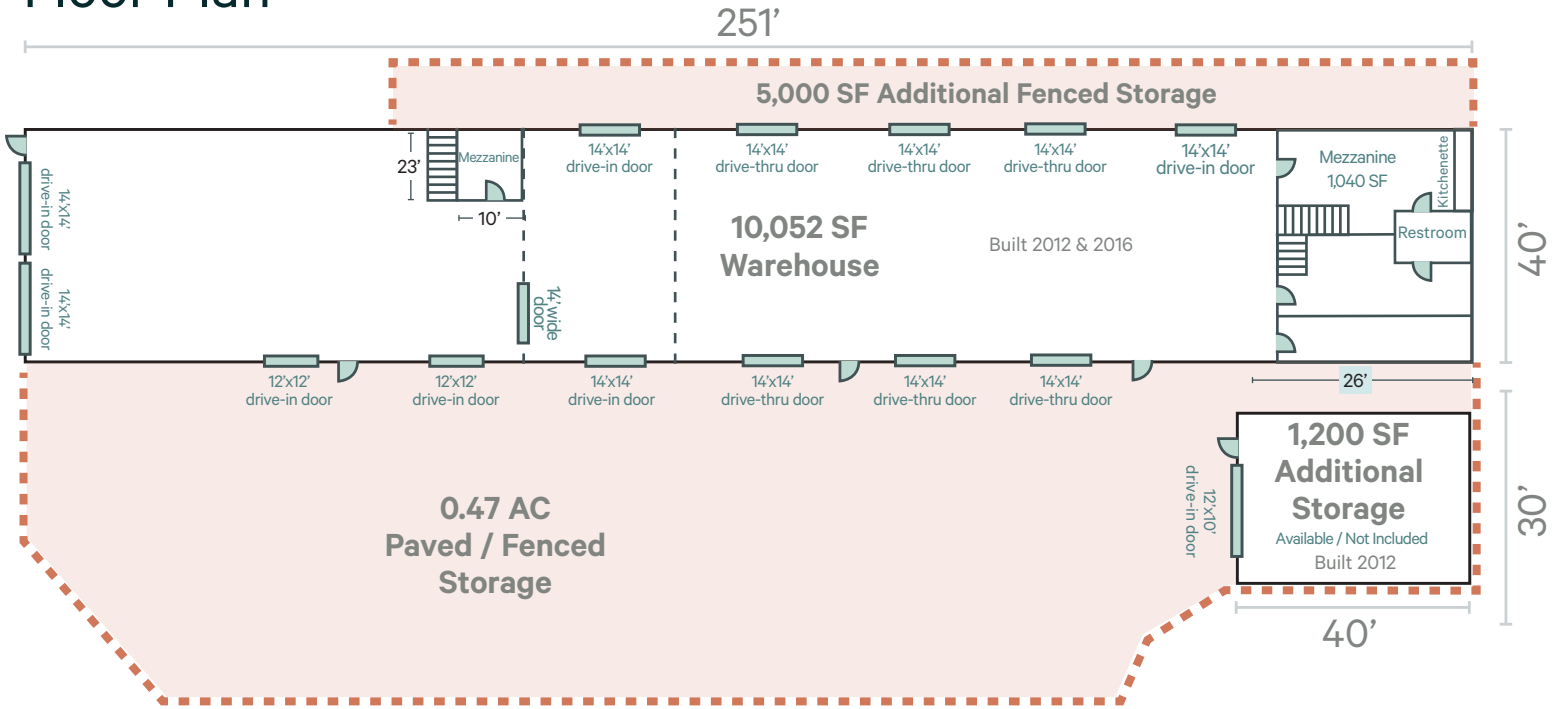

Building Information

Building Size	10,052 SF
Lot Size	36,329 SF / 0.83 AC
Year Built	2004
Stories	1
Drive-In Doors	13
Dock Doors	0
HVAC	Office – forced-heat units and radiant heat
Construction	Metal on steel frame
Outside Storage	Yes; fenced - 0.47 AC in front - 5,000 SF in building rear
Fence	Yes, fully - 8' chain-link
Power	2 - 400 amp panels; 3 phase
Restrooms	2
Additional Storage Building Available	- Built in 2012 - Metal on wood frame - 1 drive-in door





Location	Drive Times	Distance from Site
I-680	3 minutes	0.5 miles
W Dodge Road	8 minutes	5.3 miles
I-80	12 minutes	7.5 miles
Council Bluffs, Iowa	20 minutes	17.6 miles
Lincoln, Nebraska	52 minutes	56 miles

Contact Us

Graham Nabity
 Vice President
 +1 402 680 4651
 graham.nabity@cbre.com

© 2026 CBRE, Inc. All rights reserved. This information has been obtained from sources believed reliable but has not been verified for accuracy or completeness. CBRE, Inc. makes no guarantee, representation or warranty and accepts no responsibility or liability as to the accuracy, completeness, or reliability of the information contained herein. You should conduct a careful, independent investigation of the property and verify all information. Any reliance on this information is solely at your own risk. CBRE and the CBRE logo are service marks of CBRE, Inc. All other marks displayed on this document are the property of their respective owners, and the use of such marks does not imply any affiliation with or endorsement of CBRE. Photos herein are the property of their respective owners. Use of these images without the express written consent of the owner is prohibited. 050126q