

# Land For Sale

1462 N Little Creek Rd  
Dover DE 19901

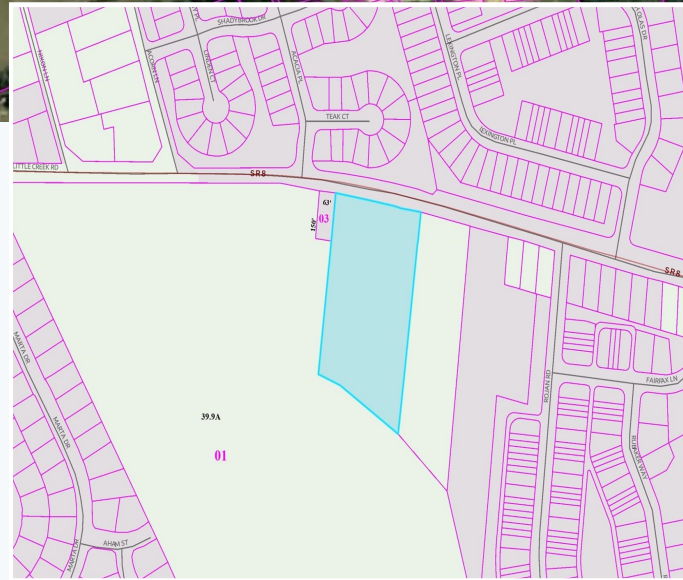

## HIGHLIGHTS:

- » Price - \$575,000
- » 4.7 +/- Acres
- » Zoned RG-2
- » Close proximity to all major highways
- » Significant Residential and Commercial Growth in the area

DEMOGRAPHICS	1 MILE	3 MILE	5 MILE
2025 Population	7,604	36,125	68,837
2025 Average HH Income	\$75,485	\$76,170	\$87,707

Exclusively Marketed by:

**Cynthia Bates**

R&R Commercial Realty

Associate Broker

(302) 222-2250 x108

rrmanagement46@gmail.com



46 S. State Street  
Dover, DE 19901