



Winkleman
1795 Amaya Ridge Road
Soquel, CA 95073
Tel 408-353-6700
Fax 408-353-4729
bill@winklemandesigns.com

All drawings and written material appearing herein constitute original and unpublished work of the Designer and may not, without written consent of the Designer, be duplicated, used, or disclosed in whole or in part for design, fabrications, or construction of any building, structure, or improvement, or portion thereof, other than the specific project to which it pertains.

1165 Reed
De Anza Properties
1165 W Reed St
Cupertino, CA

First Floor Plan

REVISION

No.	Date	Description

Date	11/21/25
Date Plotted	12/2/2025 3:52:25 PM
Scale	As indicated
Drawn	W
Job	25055
Sheet	A2.01

Winkleman Designs 2015

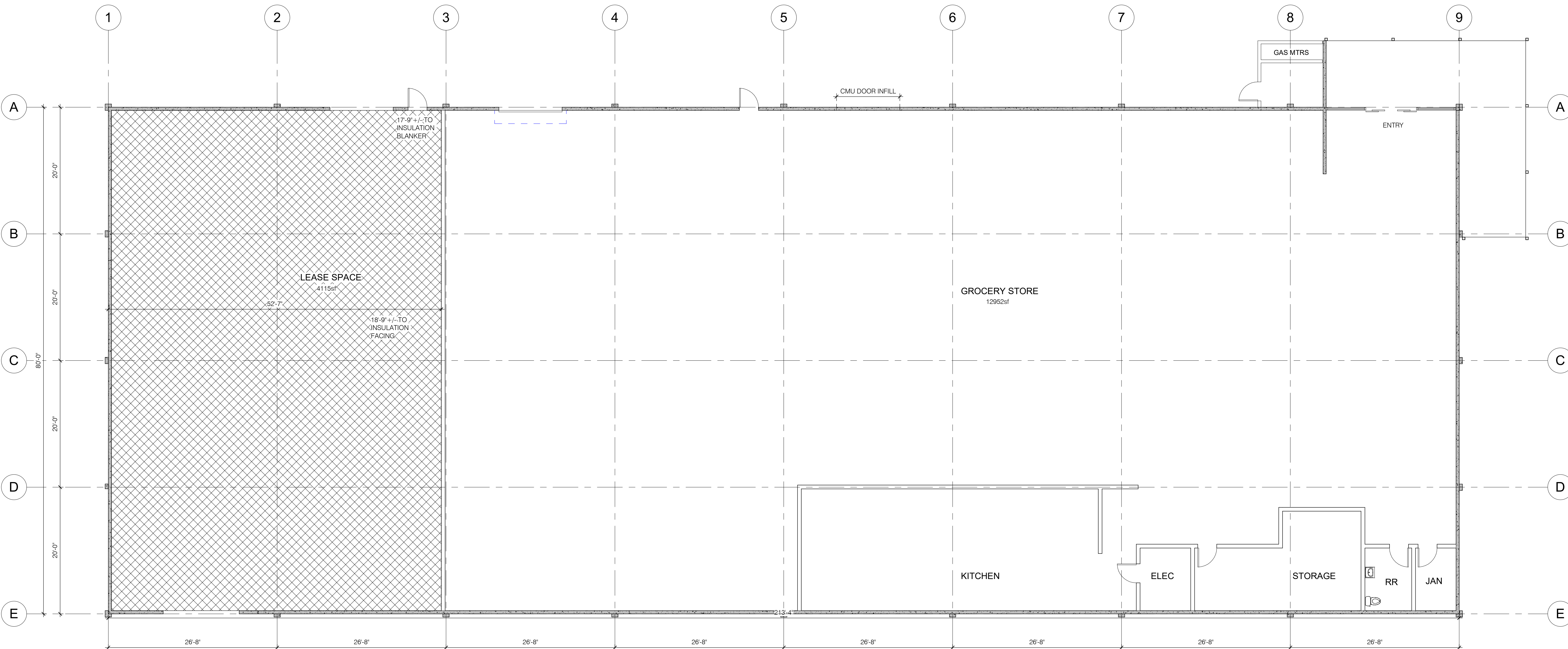
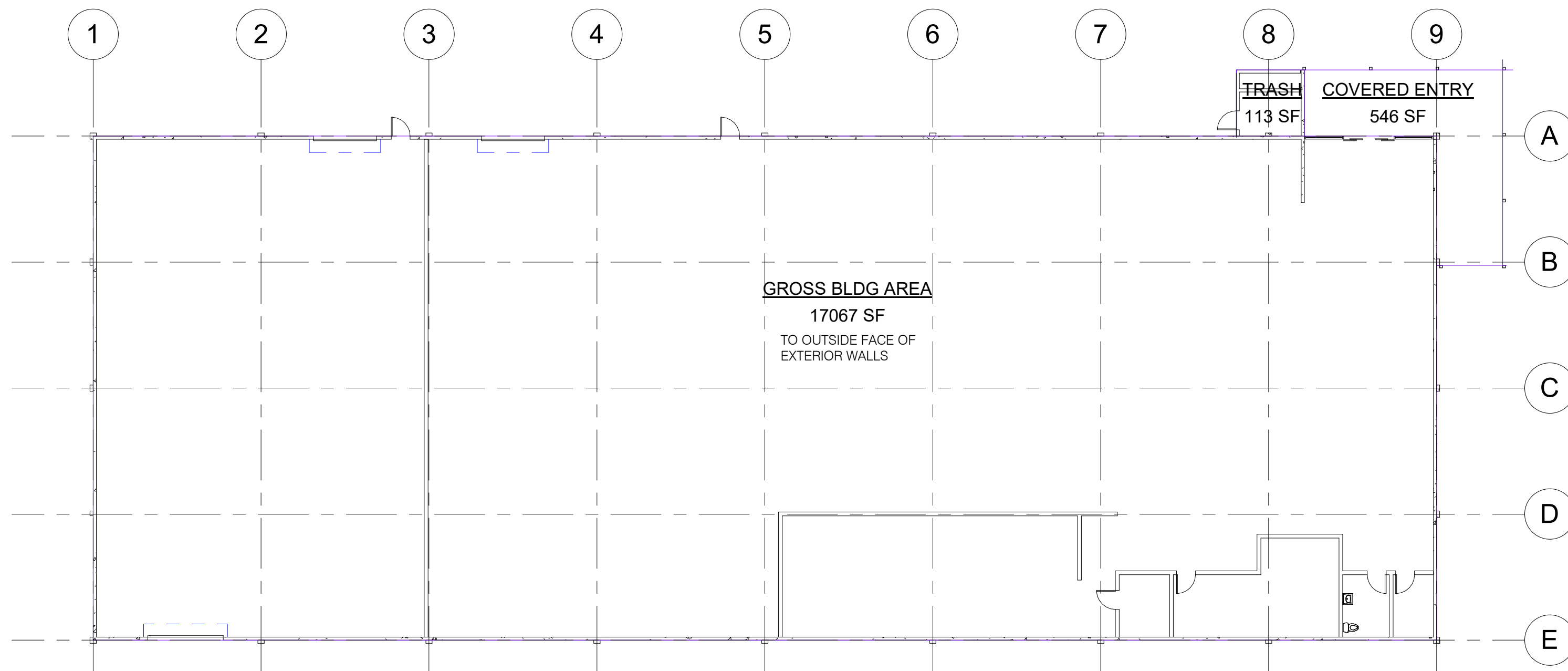

V:\Projects\De Anza Properties\1165 Reed
As of 11/21/25 11:05 AM Reed St_2.dwg