



For more information:  
*Offered Exclusively by:*  
Beer Wells Real Estate Services-  
East Texas, Inc.  
P. O. Box 3449  
Longview, Texas 75606  
[www.beerwellseasttexas.com](http://www.beerwellseasttexas.com)

Walter R. Northcutt, Broker  
[wnorthcutt@beerwellseasttexas.com](mailto:wnorthcutt@beerwellseasttexas.com)



---

## PROPERTY INFORMATION

<b>Location:</b>	1402 Mockingbird Lane, Sulphur Springs, Texas
<b>Square Footage Available:</b>	Suite 13 – Approximately 2,850 SF
<b>General Access:</b>	Interstate 30 Mockingbird Lane
<b>Anchors:</b>	Harbor Freight Family Dollar Texas Hibbett Aaron's
<b>Amenities:</b>	High Visibility, Easy Ingress and Egress, Excellent Signage.
<b>Zoning:</b>	Commercial

# SITE PLAN

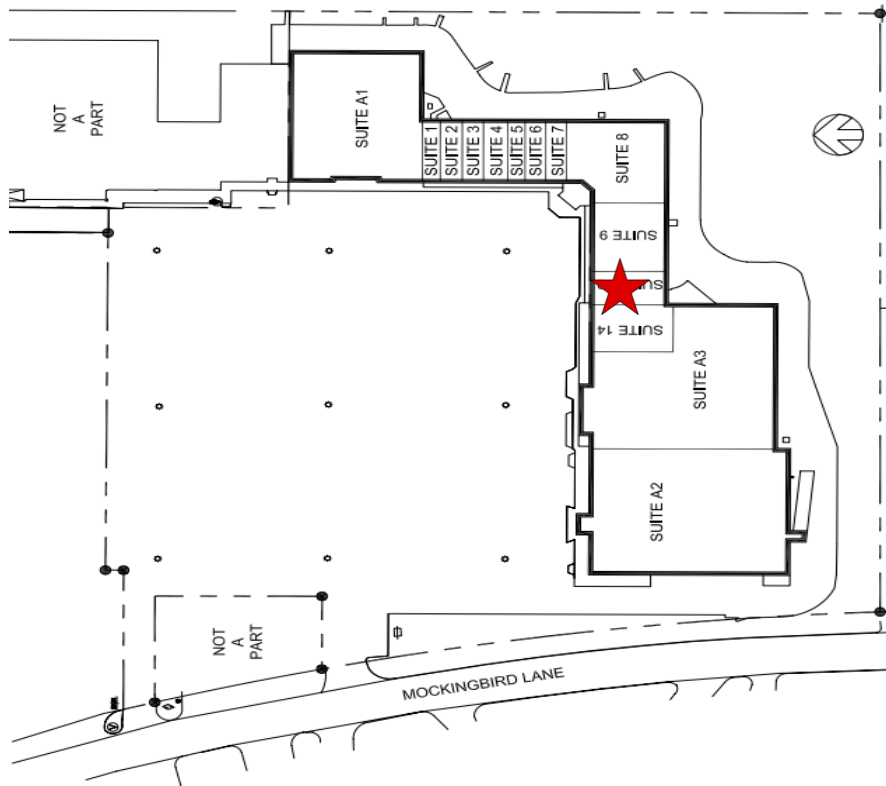
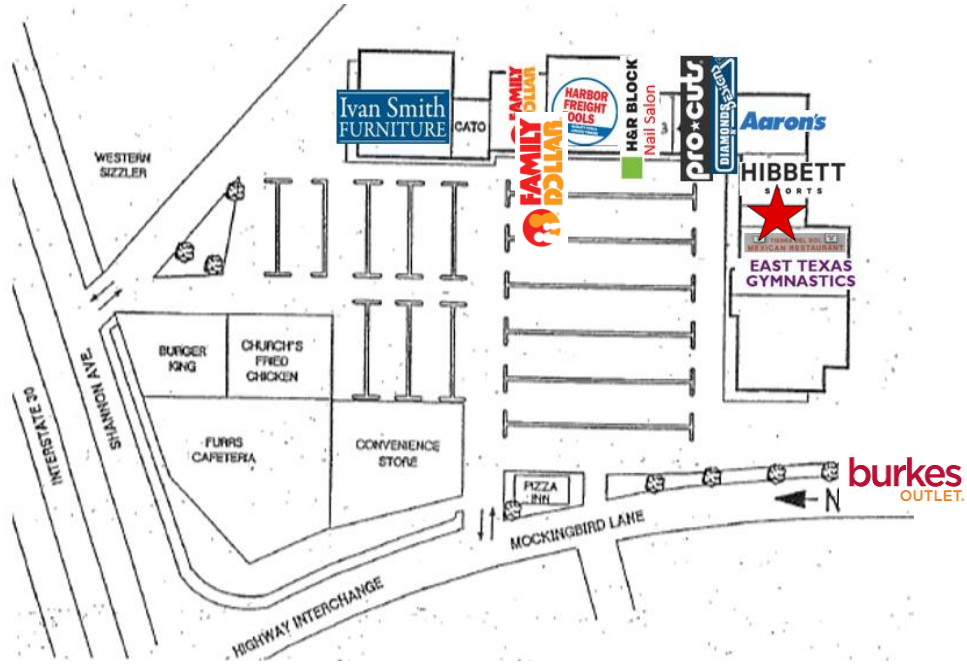

# MAPS



# TRAFFIC COUNTS

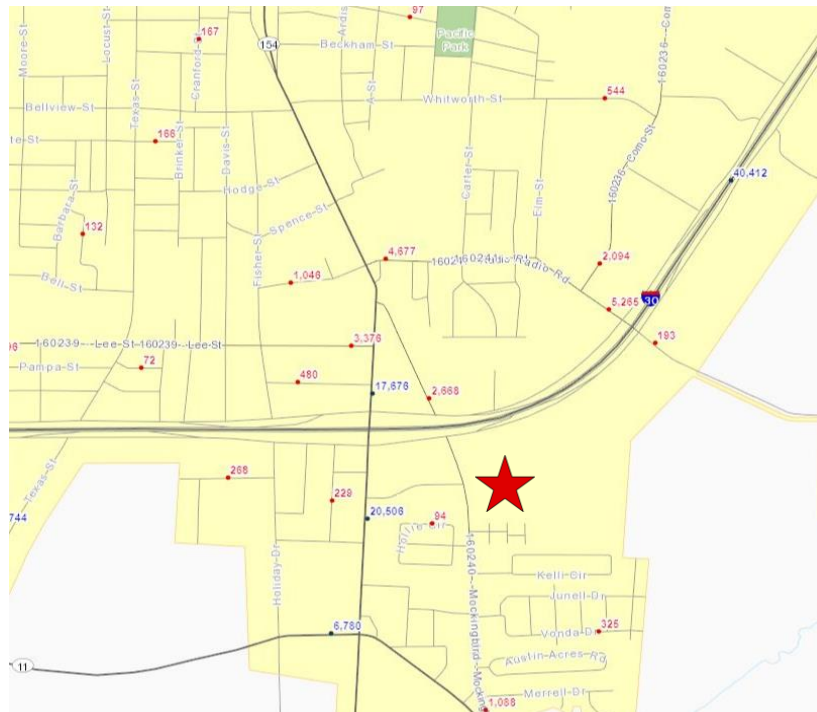

This information has been secured from sources we believe to be reliable, but we make no representations or warranties, expressed or implied, as to the accuracy of the information. References to square footage or age are approximate. Buyer must verify the information and bears all risk for any inaccuracies.