

# FOR LEASE

## 21208 NORDHOFF STREET CHATSWORTH, CA 91311

**GREAT  
BROKER BONUS  
FOR DEALS SIGNED BY  
12/31/2025  
CONTACT BROKER  
FOR DETAILS**

**APPROX. 1,416 SF  
AVAILABLE SPACE**

**\$1.55/SF/MO – MG**

### SUMMARY

<b>Property Type:</b>	Modified Gross
<b>Terms:</b>	Negotiable
<b>Available SQ.FT.:</b>	Approx. 1,416
<b>Zoning:</b>	LAMR1
<b>Year Built:</b>	1973
<b>Heat/Cool:</b>	Heating and AC Ventilation
<b>Specific Use:</b>	Light Industrial
<b>Restrooms:</b>	1
<b>Parking:</b>	2
<b>Electrical:</b>	A: 100 V: 240 Ø: 3 W: 4
<b>Min. Clear Height:</b>	15'
<b>Ground Level Doors:</b>	1 / 12' x 12'
<b>Offices #/SF:</b>	2 Offices + Reception Approx. 350 SF



### FEATURES

- Front Unit
- In a Most Desired Business Park in the SFV
- Rear Loading Door
- HVAC in Offices
- Nice Space for Warehouse, Light
- Assembly, Distribution, Marketing Group
- Priced to Attract a Quality Tenant



**WALK SCORE  
62**



**TRANSIT SCORE  
50**

Notes: Estimated CAM Fees \$0.15/SF/MO  
Lessee to verify power and all information contained on brochure.

### TRAFFIC COUNT – 2022

Street	Cross Street	Traffic Volume	Miles from Subject Property
Nordhoff St.	Canoga Ave. W	19,823	0.18 mi
Canoga Ave.	Parthenia St. S	22,169	0.28 mi
Nordhoff St.	De Soto Ave E	26,325	0.30 mi

Airport	Drive	Distance
Bop Hope	27 min	19.2 mi
LAX	43 min	29.4 mi

Commuter Rail	Drive	Distance
Chatsworth	5 min	1.9 mi
northridge	7 min	3.5 mi

### FOR MORE DETAILS:

**ARTHUR PFEFFERMAN**  
EXECUTIVE VICE PRESIDENT  
CalDRE# 01021906 Phone:  
818.725.2500  
Cell: 818.516.0257  
Direct: 818.449.5122  
Fax: 818.366.4900  
Email: art@pfeffermancre.com



DRE License No: 01527289

THE ABOVE INFORMATION HAS BEEN OBTAINED FROM SOURCES WE BELIEVE TO BE RELIABLE. HOWEVER, WE DO NOT TAKE RESPONSIBILITY FOR ITS CORRECTNESS.

FLOOR PLAN

21208 NORDHOFF STREET  
CHATSWORTH, CA 91311

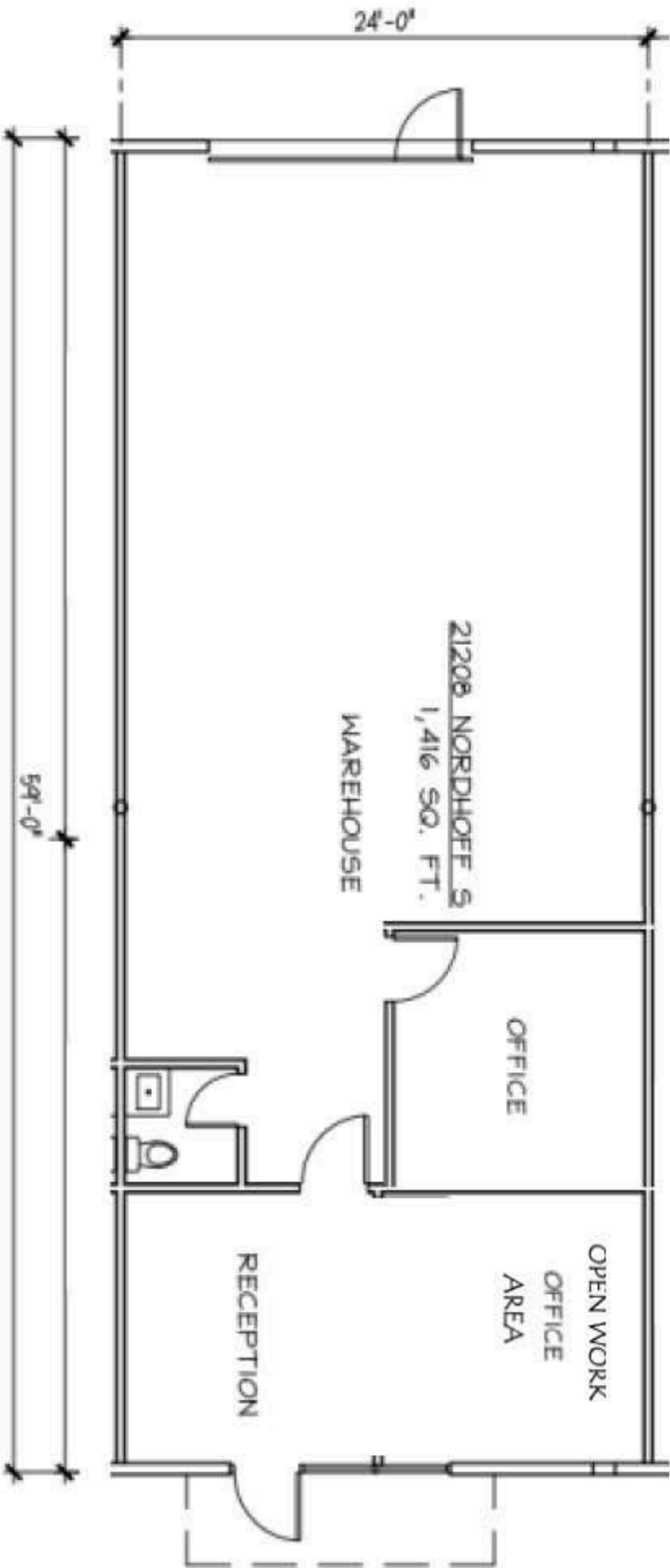

NOT TO SCALE