

# Publix #1212 - Walden Woods

2202 James L. Redman Parkway  
Plant City, FL 33563  
Lat 27.989, Long -82.121

FOR LEASE



1,265 - 2,069 SF AVAILABLE

## PROPERTY HIGHLIGHTS

- Tampa MSA - Northeast Hillsborough County
- Geographically Located in the Middle of the West Coast of Florida, Approximately 25 Miles East of Tampa, Immediately West of Lakeland
- Anchored by Publix and Bealls
- 2nd Generation Restaurant Available
- Hillsborough County is the 4th Largest County in Florida
- Four Miles South Alexander St. Exit on Interstate-4
- Retail Center of Gravity in Plant City
- Renovated with Attractive New Facade and Signage
- Co-Tenants Include: Bealls Department Store, GNC, H&R Block, CVS, and Moe's Southwest Grill
- Traffic Count: 44,200 VPD

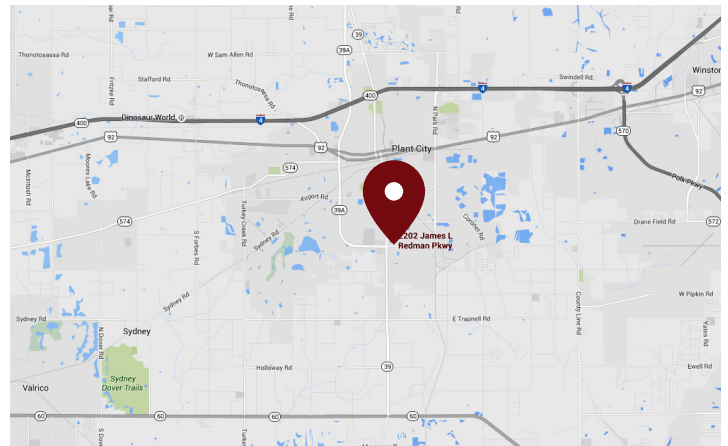

DEMOGRAPHICS	1 Mile	3 Miles	5 Miles
Total Population	6,589	39,471	69,223
Daytime Population	9,008	42,440	67,234
Total Households	2,416	13,533	24,191
Avg. HH Income	\$80,503	\$86,679	\$91,024

Data provided by Placer Labs Inc. ([www.placer.ai](http://www.placer.ai)) & Esri

## Sandra Woodworth

813.210.7509 | [swoodworth@crossmanco.com](mailto:swoodworth@crossmanco.com)  
9950 Princess Palm Avenue, Suite 340, Tampa, FL

Licensed Real Estate Broker. No warranty expressed or implied has been made to the accuracy of the information provided herein, no liability assumed for error or omission.



[www.crossmanco.com](http://www.crossmanco.com)



# Publix #1212 - Walden Woods

2202 James L. Redman Parkway  
 Plant City, FL 33563  
 Lat 27.989, Long -82.121

## SITE PLAN

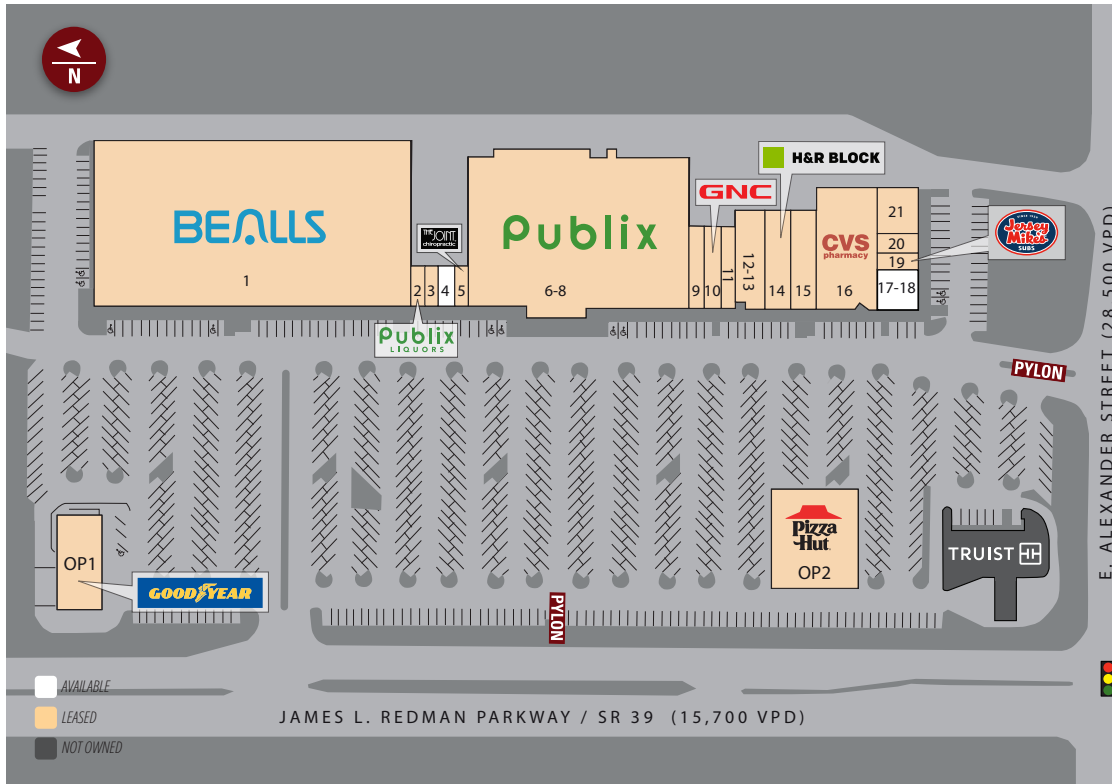

Suite	Tenant	Size
1	Bealls Dept. Store	71,449
2	Publix Liquors	1,270
3	Great American Barber Shop	1,005
4	AVAILABLE	1,265
5	The Joint Chiropractic	1,015
6-8	Publix	45,600
9	813 Chinese Food	1,474
10	GNC	1,500
11	Mystic Nails & Spa	1,494
12-13	Daisy Dukes Bar & Grill	5,000
14	H & R Block	2,038
15	Hibachi Express	2,990
16	CVS Pharmacy	10,368
17-18	AVAILABLE	2,069
19	Jersey Mike's	1,011
20	Unavailable	1,032
21	Dental Association	2,761
OP1	Goodyear	1 Acre
OP2	Pizza Hut	1 Acre

TOTAL 154,003



**Sandra Woodworth**

813.210.7509 | [swoodworth@crossmanco.com](mailto:swoodworth@crossmanco.com)  
 9950 Princess Palm Avenue, Suite 340, Tampa, FL

*Licensed Real Estate Broker. No warranty expressed or implied has been made to the accuracy of the information provided herein, no liability assumed for error or omission.*



Crossman & Company

[www.crossmanco.com](http://www.crossmanco.com)

# Publix #1212 - Walden Woods

2202 James L. Redman Parkway  
Plant City, FL 33563  
Lat 27.989, Long -82.121

## FOOT TRAFFIC OVERVIEW

EST. # OF CUSTOMERS ANNUALLY



EST. # OF VISITS ANNUALLY



AVG. VISITS / CUSTOMER



AVG. LENGTH-OF-STAY / VISIT



TOP 3 DAYS



Saturday	365,993
Friday	359,135
Sunday	331,703

# OF VISITS

TOP 3 HOURS



5-6 PM	328,267
6-7 PM	325,500
12-1 PM	321,292

# OF VISITS

Data provided by Placer Labs Inc. ([www.placer.ai](http://www.placer.ai)) July 1, 2023 - June 30, 2024

## SITE VISIT DENSITY

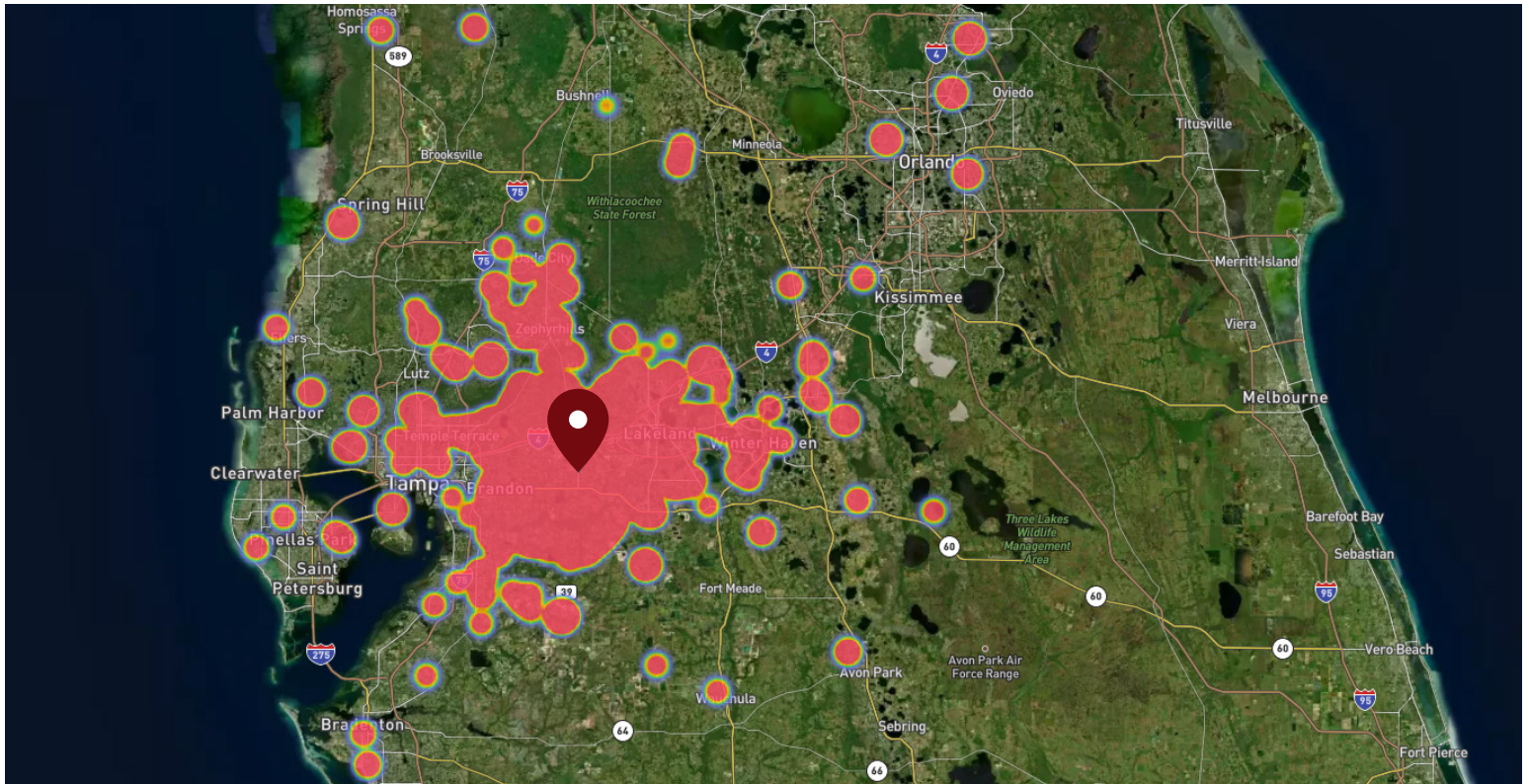

Red, orange, and yellow colors represent the location of 60% of site visitors

Data provided by Placer Labs Inc. ([www.placer.ai](http://www.placer.ai))

**Sandra Woodworth**

813.210.7509 | [swoodworth@crossmanco.com](mailto:swoodworth@crossmanco.com)  
9950 Princess Palm Avenue, Suite 340, Tampa, FL

Licensed Real Estate Broker. No warranty expressed or implied has been made to the accuracy of the information provided herein, no liability assumed for error or omission.



[www.crossmanco.com](http://www.crossmanco.com)