

TASTING ROOMS

- BERGEVIN LANE
70 N. Colville St.
- BLEDSOE FAMILY WINERY
229 E. Main St.
- BROWNE FAMILY VINEYARDS
31 E. Main St.
- DAMA WINES
123 E. Main St.
- GOOSE RIDGE
9 N. 2nd Ave.
- KONTOS CELLARS
10 N. 2nd Ave.
- LOCUST CIDER & BREWING CO.
226 E. Main St.
- MAISON BLEUE
20 N. 2nd Ave.
- MARK RYAN
26 E. Main St., Ste 1
- NOCKING POINT WINES
212 E. Alder St.
- PLUMB CELLARS
39 E. Main St.
- PROPER/HOUSE OF BONES TASTING LOUNGE
31 E. Main St.
- THE THIEF
102 E. Main St.
- TIME & DIRECTION
4 N Spokane St.

RESTAURANTS & DINERS

- AK'S MERCADO
21 E. Main St.
- BACON & EGGS
57 E. Main St.
- BRASSERIE FOUR
4 E. Main St.
- COLVILLE STREET PATISSERIE
40 S. Colville St.
- GRAZE
5 S. Colville St.
- HATTA WAY'S
125 W. Alder St.
- THE MAPLE COUNTER CAFE
209 E. Alder St.
- PASSATEMPO TAVERNA
215 W. Main St.
- T MAC S
80 N. Colville St.
- YAMAS GREEK EATERY
7 S 1st Ave.

PUBS & BARS

- MARCY'S BAR & LOUNGE
33 S. Colville St.
- PUBLIC HOUSE 124
124 E. Main St.
- RED MONKEY
25 W. Alder St.

HOTELS & SPAS

- THE HUNGATE
214 E. Main St.
- THE MARCUS WHITMAN
6 W. Rose St.
- MISBEHAVEN SPA
126 W. Poplar St.

PLACES OF INTEREST

- WALLA WALLA CLOTHING CO.
103 E. Main St.
- SWEETWATER PAPER & HOME
101 E Alder St.

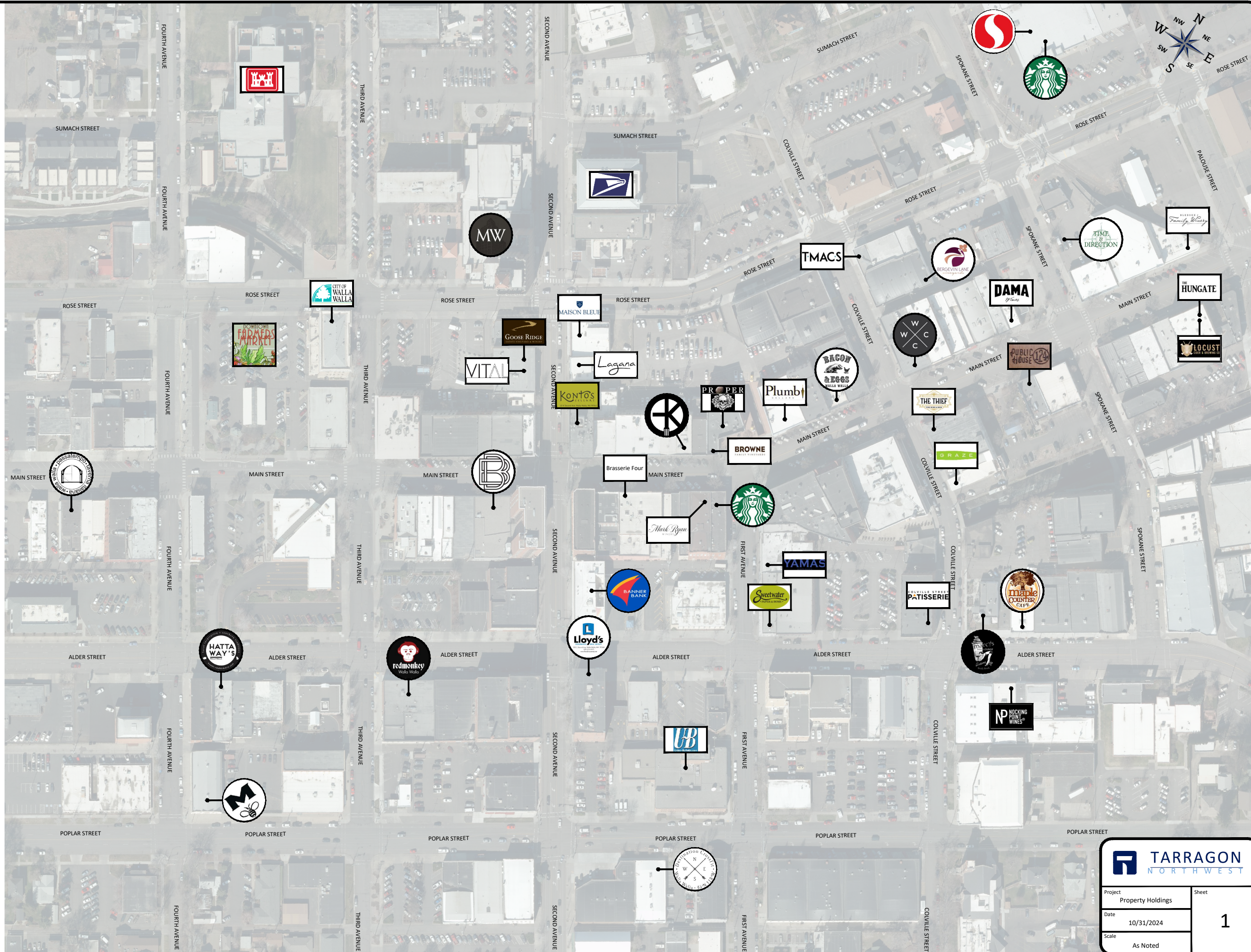

© Global Mapper, Mapbox, OpenStreetMap, Walla Walla Commercial Leasing Maps Downloaded 10/31/2024 12:43:10 PM

Project	Property Holdings
Date	10/31/2024
Scale	As Noted
Sheet	1