

## 3900 W 95th Street Office Suites

3900 W 95th St, Evergreen Park, IL 60805



**Chuck Groebe**

Coldwell Banker Commercial NRT  
676 N Michigan Ave, Suite 3010, Chicago, IL 60611  
[CGroebe61@gmail.com](mailto:CGroebe61@gmail.com)  
(708) 205-8703

# 3900 W 95th Street Office Suites

\$19.00 /SF/YR

Professional Office Suites for Lease - Ideal for General Office or Medical Use. Well-maintained office suites featuring six private offices, a half bath, and generous open workspace. The property offers ample on-site parking, as well as convenient street parking. Located east of 95th and Pulaski, the area is easily accessible by public transportation and surrounded by popular restaurants and shopping. A prime location in a professionally managed building-an ideal office space....

- 95th and Pulaski Road Evergreen Park
- General Office or Medical Use
- High Traffic Count
- Ample Parking
- Prime Location
- Near Christ Hospital, Restaurants and Public Transportation



Rental Rate:	\$19.00 /SF/YR
Property Type:	Office
Building Class:	C
Rentable Building Area:	6,475 SF
Year Built:	1970
Walk Score ®:	77 (Very Walkable)
Transit Score ®:	44 (Some Transit)
Taxes:	\$0.50 USD/SF/MO
Operating Expenses:	\$0.17 USD/SF/MO
Rental Rate Mo:	\$1.58 /SF/MO

## 1st Floor Ste B1

Space Available	1,800 SF
Rental Rate	\$19.00 /SF/YR
Date Available	30 Days
Service Type	TBD
Built Out As	Standard Office
Space Type	Relet
Space Use	Office
Lease Term	Negotiable

Professional Office Suites for Lease - Ideal for General Office or Medical Use. Well-maintained office suites featuring six private offices, a half bath, and generous open workspace. The property offers ample on-site parking, as well as convenient street parking. Located east of 95th and Pulaski, the area is easily accessible by public transportation and surrounded by popular restaurants and shopping. A prime location in a professionally managed building-an ideal office space

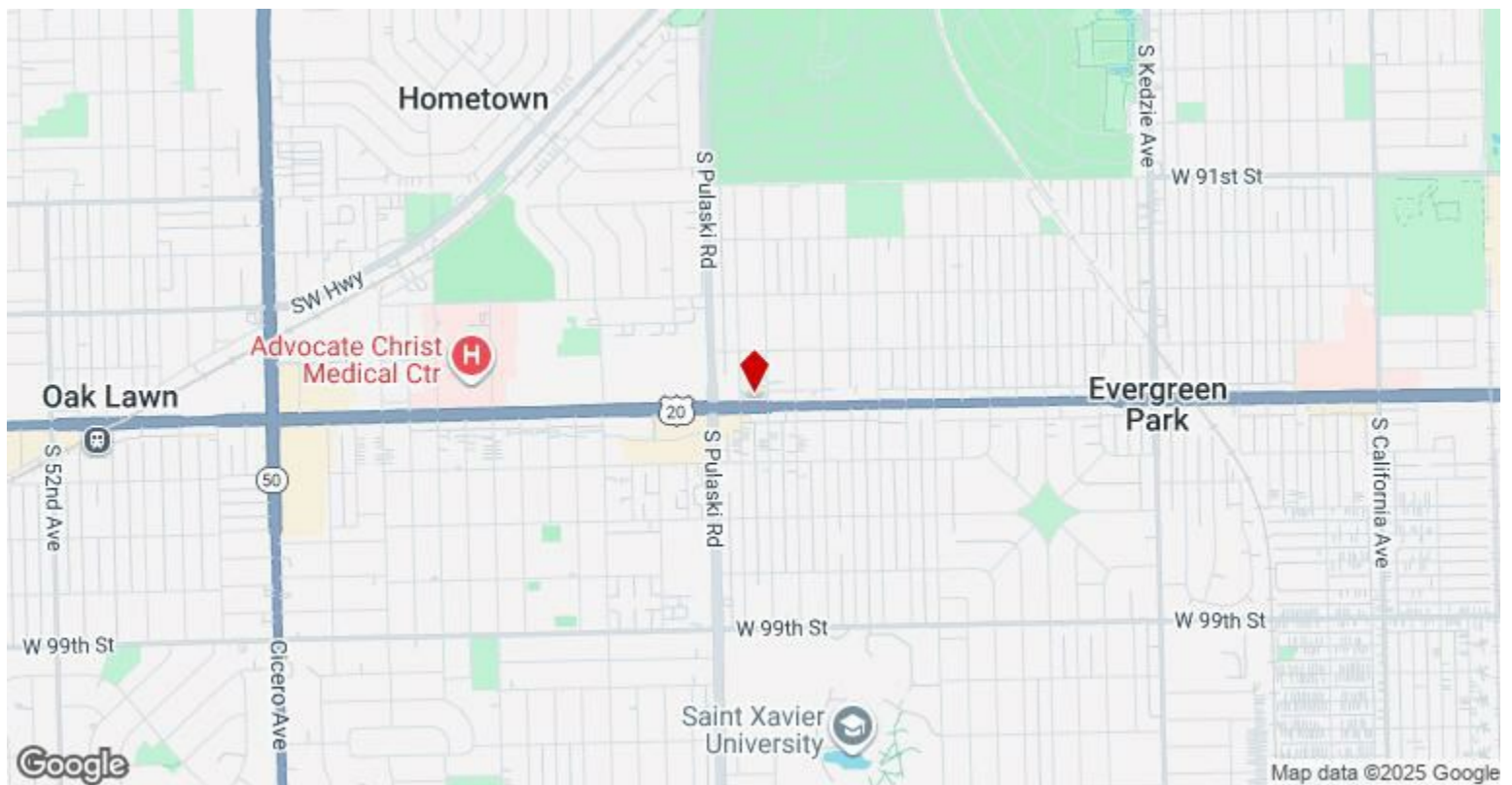

## 3900 W 95th St, Evergreen Park, IL 60805

Professional Office Suites for Lease - Ideal for General Office or Medical Use. Well-maintained office suites featuring six private offices, a half bath, and generous open workspace. The property offers ample on-site parking, as well as convenient street parking. Located east of 95th and Pulaski, the area is easily accessible by public transportation and surrounded by popular restaurants and shopping. A prime location in a professionally managed building-an ideal office space.



## Property Photos





## Property Photos





## Property Photos



Interior 6



Exterior Back



# Property Photos



Exterior Side

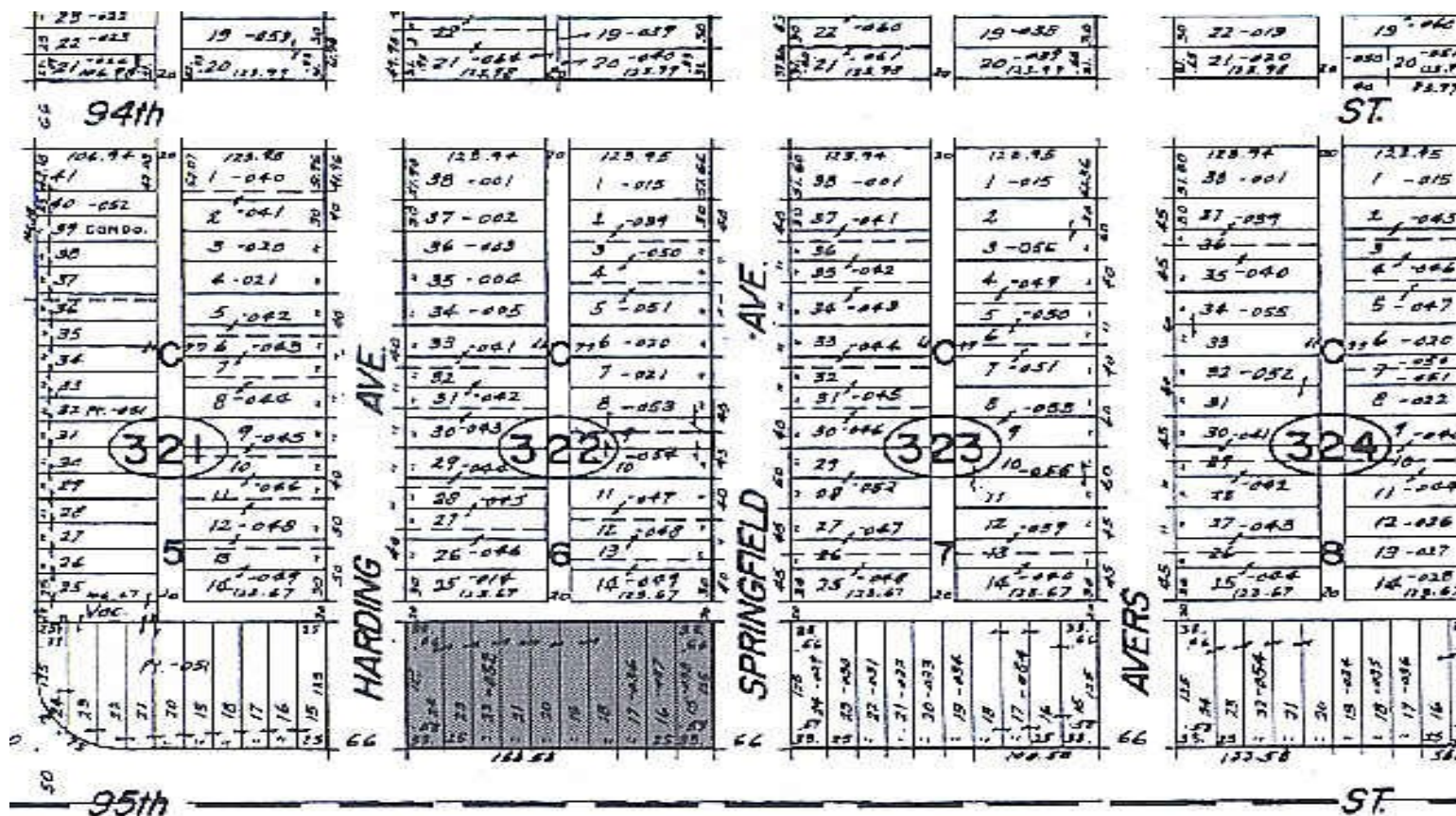



## Property Photos

