

FOR LEASE
2,360 sq. ft. available

RENOVATION COMPLETE!
13830 Manchester Road, St. Louis 63011



JASON MORGAN 314.560.8114



JOE COOK 314.518.8952

The information contained herein has been obtained from the owner of the property or from other sources. The brokers do not guarantee the accuracy of the information. Sellers and brokers make no representation as to the environmental or other condition of the property and recommend that purchaser/tenant investigate fully.

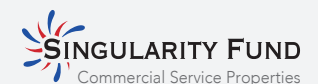

13830 Manchester Road, St. Louis 63011



Demographics

	Population	Households	Average Household Income
1 Mile	6,254	2,617	\$160,858
3 Miles	65,784	26,403	\$159,689
5 Miles	167,038	65,960	\$167,940



JASON MORGAN 314.560.8114



JOE COOK 314.518.8952

The information contained herein has been obtained from the owner of the property or from other sources. The brokers do not guarantee the accuracy of the information. Sellers and brokers make no representation as to the environmental or other condition of the property and recommend that purchaser/tenant investigate fully.

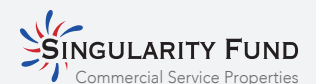

MANCHESTER (VARIABLE WIDTH) ROAD
STATE ROUTE 100 (PUBLIC)

13830 Manchester Road, St. Louis 63011

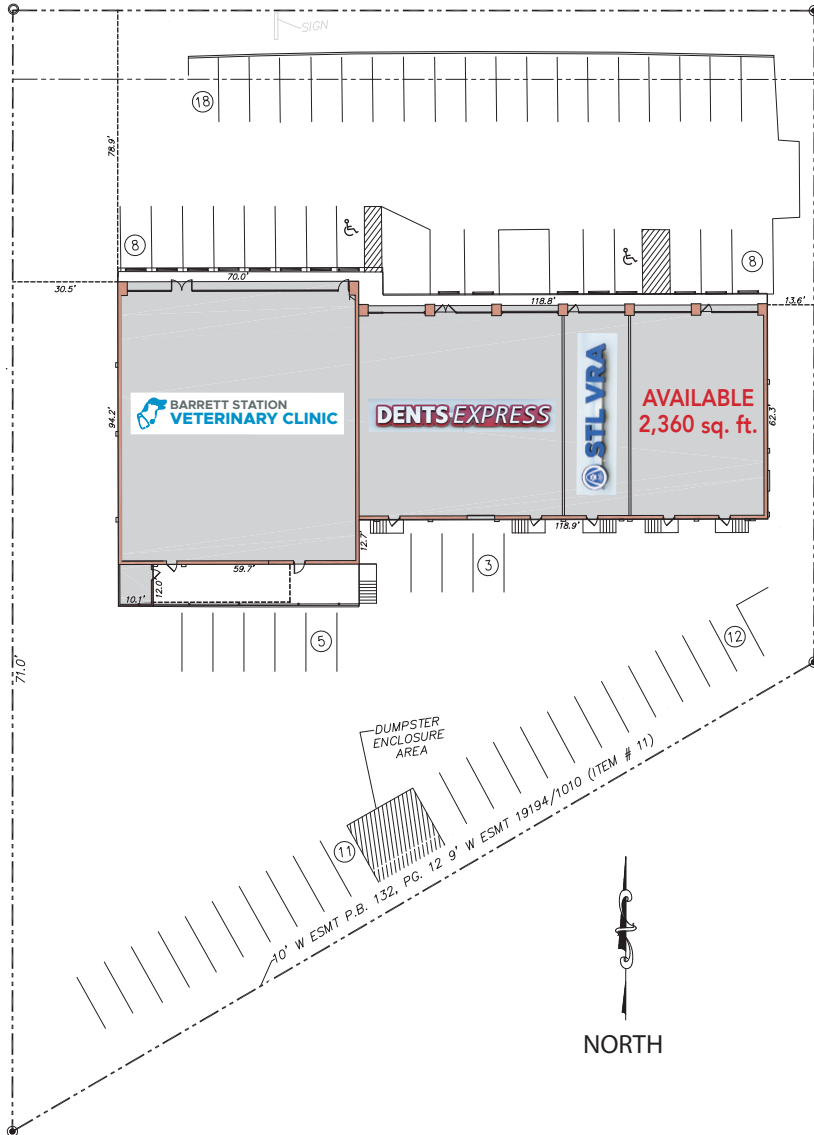

13830 MANCHESTER RD



JASON MORGAN 314.560.8114



JOE COOK 314.518.8952

The information contained herein has been obtained from the owner of the property or from other sources. The brokers do not guarantee the accuracy of the information. Sellers and brokers make no representation as to the environmental or other condition of the property and recommend that purchaser/tenant investigate fully.

