

3729 LINDEN AVENUE SE
WYOMING, MICHIGAN

INDUSTRIAL FOR LEASE
2,100 – 4,950 Square Feet Available



**SIGNATURE
ASSOCIATES**
KNOW SIGNATURE | KNOW RESULTS

WAREHOUSE

PRICE REDUCED



PROPERTY FEATURES

- 4,950 total building square feet
- 2,100-4,950 square foot suite available
- Five (5) 10' x 12' Overhead doors
- Built in 1961; remodeled in 2020
- 15' ceiling height
- Security system in place
- Zoned I-1
- Lease Rate: ~~\$17.00/sf~~ \$8.50/sf NNN

Comments: Industrial warehouse space located in City of Wyoming. Roof was replaced one year ago, with hanging heaters. If more power is required, landlord might consider upgrading. Great for storage, small business use, quiet workshop, car detailing and more.



For more information, please contact:

JOE RIZQALLAH
(616) 822 6310
jrizzqallah@signatureassociates.com

SIGNATURE ASSOCIATES
1188 East Paris Ave SE, Suite 220
Grand Rapids, MI 49546
www.signatureassociateswm.com

3729 Linden Avenue SE - Wyoming, Michigan

Industrial For Lease

2,100-4,950
Square Feet
AVAILABLE

Floor Plan

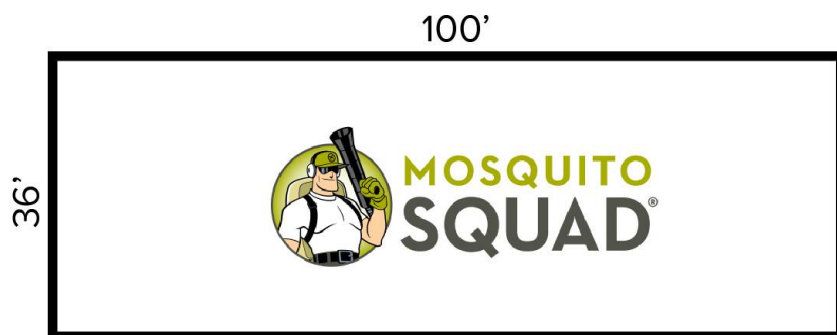
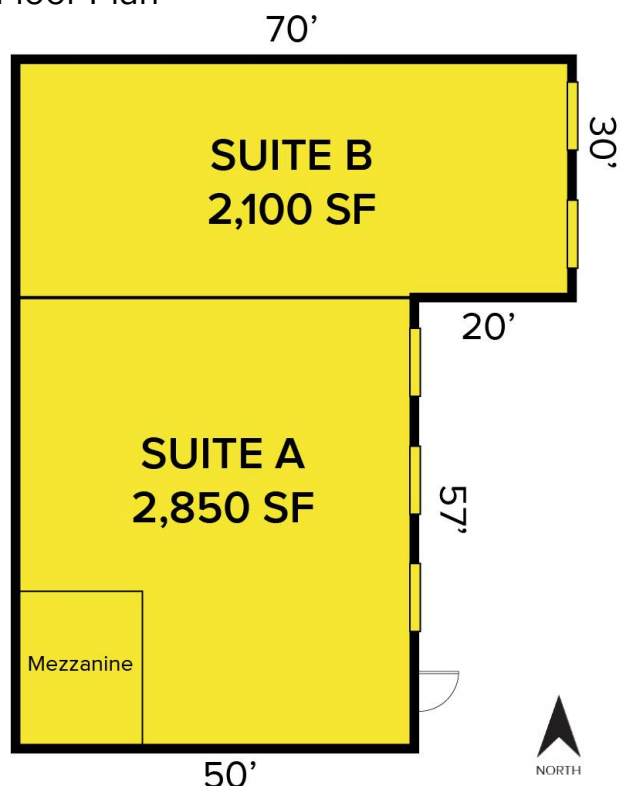

AVAILABILITY

SUITE	TOTAL SF	RATE PSF	MONTHLY
A	2,850	\$8.50	\$2,018.75
B	2,100	\$8.50	\$1,487.50
A & B	4,950	\$8.50	\$3,506.25

Suite A Interior Photos



Suite B Interior Photos



For more information, please contact:

JOE RIZQALLAH
(616) 822 6310
jrizzqallah@signatureassociates.com

SIGNATURE ASSOCIATES
1188 East Paris Ave SE, Suite 220
Grand Rapids, MI 49546
www.signatureassociateswm.com

3729 Linden Avenue SE - Wyoming, Michigan

Industrial For Lease

2,100-4,950
Square Feet
AVAILABLE

Aerial



For more information, please contact:

JOE RIZQALLAH

(616) 822 6310

jrizqallah@signatureassociates.com

SIGNATURE ASSOCIATES

1188 East Paris Ave SE, Suite 220

Grand Rapids, MI 49546

www.signatureassociateswm.com

Information is subject to verification and no liability for errors or omissions is assumed. Price is subject to change and listing withdrawal.