

COMMERCIAL STRATA UNITS AT A LUXURY RESORT-STYLE DEVELOPMENT

Zara at Lakestone | Lake Country, BC

Stephen Webber

Senior Vice President

D: +1 250 861 8104

M: +1 604 970 9134

stephen.webber@colliers.com

Layla Miller

Associate

D: +1 250 861 8117

M: +1 250 862 4506

layla.miller@colliers.com

Arjan Thouli

Sales Associate

D: +1 250 861 8101

M: +1 250 718 6202

arjan.thouli@colliers.com

For Lease



Location Overview

ZARA AT LAKESTONE IS LOCATED IN LAKE COUNTRY, POSITIONED ALONG THE AREA'S SOUGHT-AFTER WATERFRONT SETTING.

The District of Lake Country is located in the rapidly growing Central Okanagan area, which has seen record numbers of building permits issued over the past several years.

According to Canadian Census data, Lake Country was British Columbia's fastest-growing municipality in 2014 and 2021, with a population increase of 22% since 2016.

The natural environment of Lake Country is characterized by lakes, orchards, vineyards, and beautiful landscapes. Residents enjoy a healthy lifestyle focused on outdoor activities.

PROPERTY FEATURES



Kelowna International Airport (YLW)

10 min

Lake Country

7 min

Downtown Vernon

28 min

Downtown Kelowna

28 min

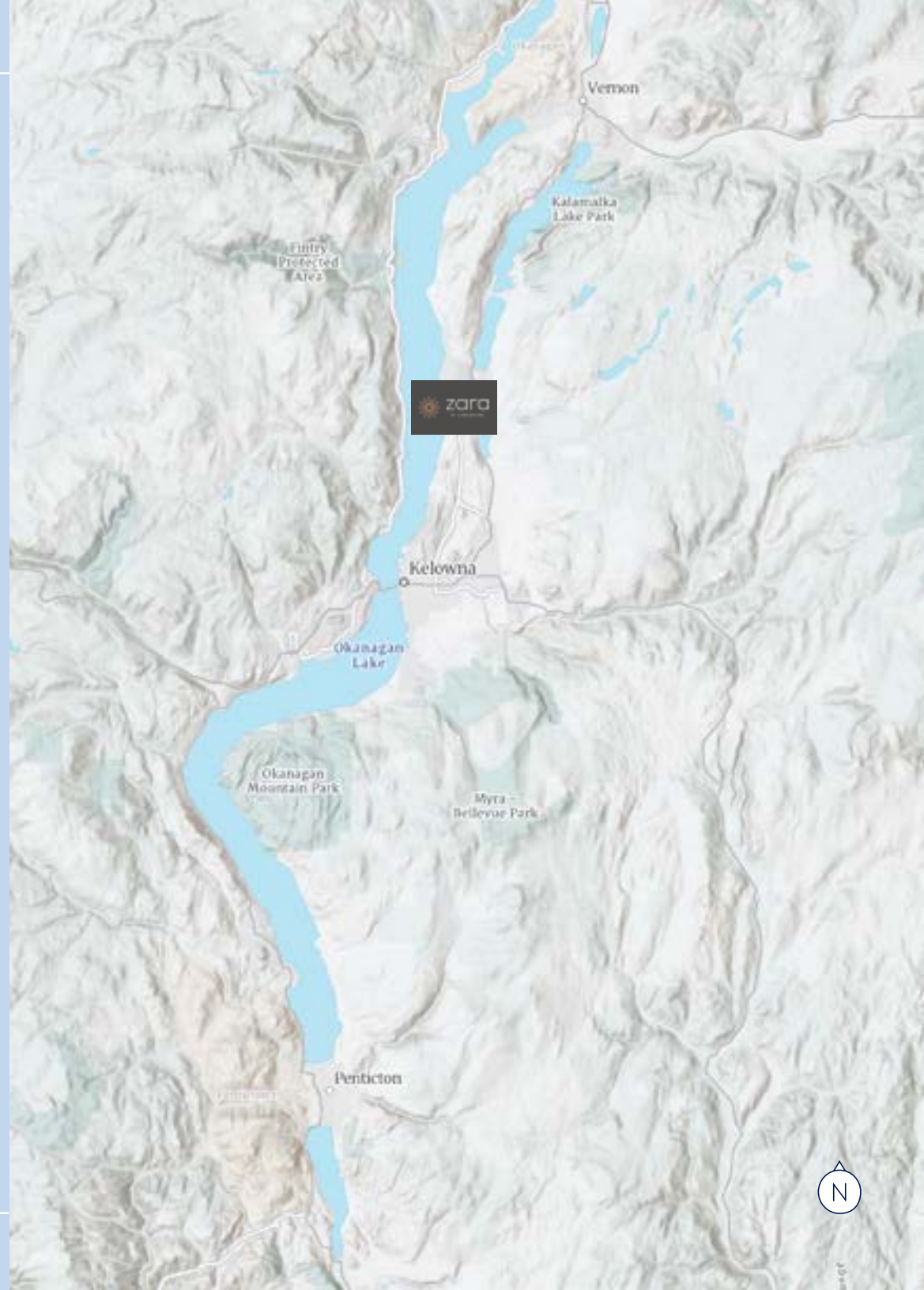



THE OPPORTUNITY

Located in the heart of the Lakestone community, these versatile commercial units in Lake Country's newest luxury resort-style development offer a rare opportunity to establish your business in a vibrant and upscale neighbourhood. Ideal for a wide range of uses—including a pharmacy, coffee shop, boutique, spa/salon, liquor store, and various professional services such as medical, physio, or legal offices. With community amenities like pickleball and tennis courts just steps away, there's strong potential for specialty retail that aligns with the active, health-focused lifestyle of this growing area.

The Lakestone community itself features upscale residences and a distinctly outdoor-oriented way of life, thanks to its close proximity to lakes, scenic trails, and world-class winerie - making it a destination for both locals and visitors alike.

SALIENT FACTS

Civic Address	Strata Lots 2-6, 9654 Benchland Dr. Lake Country, BC V4V 1N3
Legal Address	LOT 94 SECTION 9 TOWNSHIP 20 OSOYOOS DIVISION YALE DISTRICT PLAN EPP74823
Zoning	DC# - Direct Control Zone 3 (Lakestone)
Unit Size:	624 - 2,778 SF
*Asking Rent:	\$24.50 PSF + NNN <i>*Tenant incentives available with flexible lease terms</i>

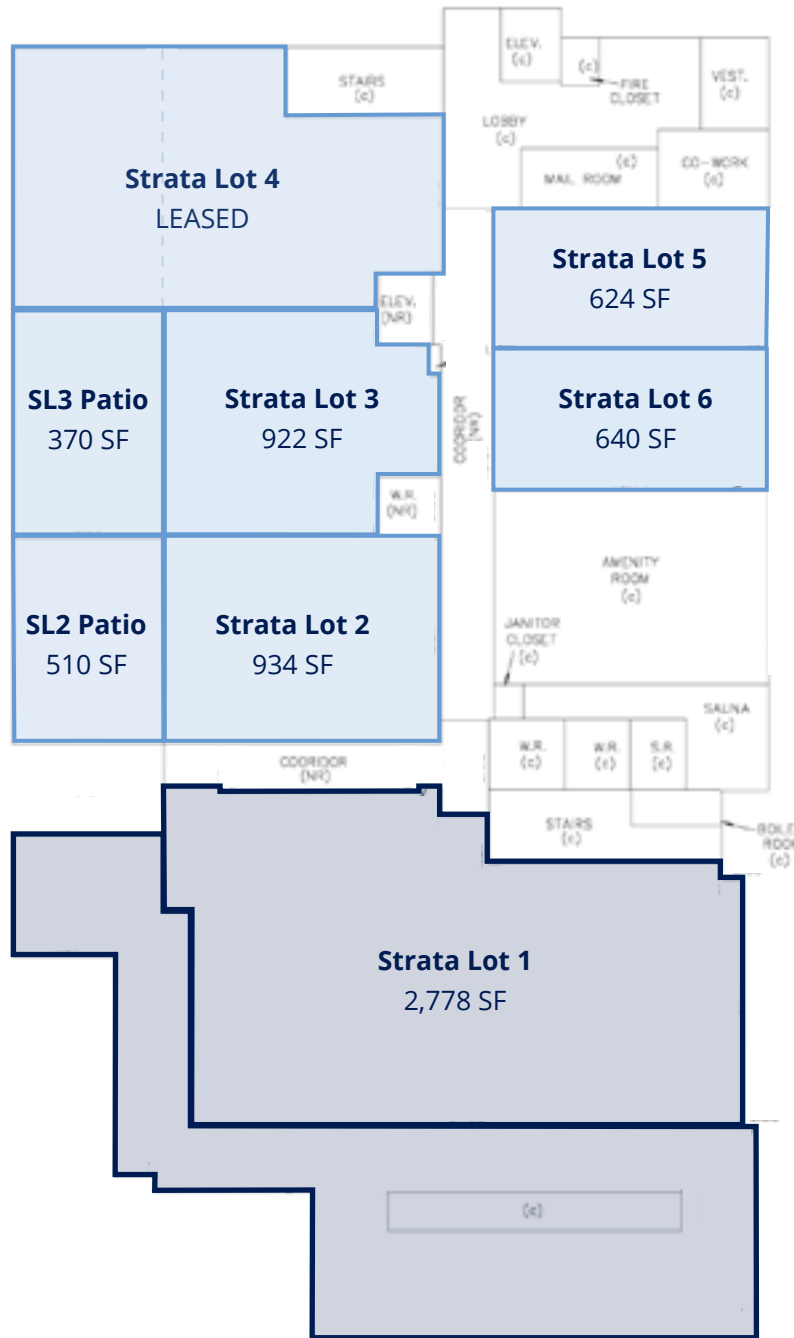

SITE PLAN

TOTAL COMMERCIAL AREA

8,410 SF

COMMERCIAL STRATA UNITS

UP TO 6

Strata Lot 1 2,778 SF*
poolside restaurant opportunity

Strata Lot 2 934 SF + 510 SF Patio*

Strata Lot 3 922 SF + 370 SF Patio*

Strata Lot 4 LEASED

Strata Lot 5 624 SF*

Strata Lot 6 640 SF*

**Measurements are approximate*

9654 BENCHLAND DRIVE | LAKE COUNTRY, BC

Lease rate starting at:

\$24.50 PSF + NNN

Stephen Webber

Senior Vice President

D: +1 250 861 8104

M: +1 604 970 9134

stephen.webber@colliers.com

Layla Miller

Associate

D: +1 250 861 8117

M: +1 250 862 4506

layla.miller@colliers.com

Arjan Thouli

Sales Associate

D: +1 250 861 8101

M: +1 250 718 6202

arjan.thouli@colliers.com

This document has been prepared by Colliers for advertising and general information only. Colliers makes no guarantees, representations or warranties of any kind, expressed or implied, regarding the information including, but not limited to, warranties of content, accuracy and reliability. Any interested party should undertake their own inquiries as to the accuracy of the information. Colliers excludes unequivocally all inferred or implied terms, conditions and warranties arising out of this document and excludes all liability for loss and damages arising there from. This publication is the copyrighted property of Colliers and/or its licensor(s). Copyright © 2026. All rights reserved. This communication is not intended to cause or induce breach of an existing listing agreement. Colliers Macaulay Nicolls Inc., Brokerage



Accelerating success.