



Lease Rate:

Undisclosed

Details:

- ⇒ ±3,150 Total SF
- ⇒ 3 Office Spaces
- ⇒ Reception, Lobby, Break Area/
Kitchenette, 2 Restrooms + Warehouse
Space
- ⇒ TMS: 00122-01-110

Highlights:

- ⇒ (2) 10' Drive-In Doors
- ⇒ Ample Lined Parking Space
- ⇒ ±1 Mile from I-95
- ⇒ Business Park Environment
- ⇒ Security System

For Lease | Suite D

±3,150 SF Office/Warehouse

Suite Available Located within a
Suburban Business Park

1307 Broughton Blvd | Florence, SC

Located just off North Cashua Drive, this ±3,150 SF space is part of a well-maintained multi-tenant building within a professional business park. The property offers a flexible combination of office and warehouse space to accommodate a range of business needs. It features ample lined parking, a professional atmosphere, and close proximity to established local, regional, and national businesses. Conveniently positioned about one mile from I-95 via US Highway 52, the site provides easy access to major roadways and business districts throughout Florence.



135 S Dargan St. Suite 301 | Florence, SC 29506 | Phone (843) 667-4999

www.palmettocommercial.com

No warranty or representation is made as to the accuracy of the information contained herein.

1307 Broughton Blvd Floor Plan

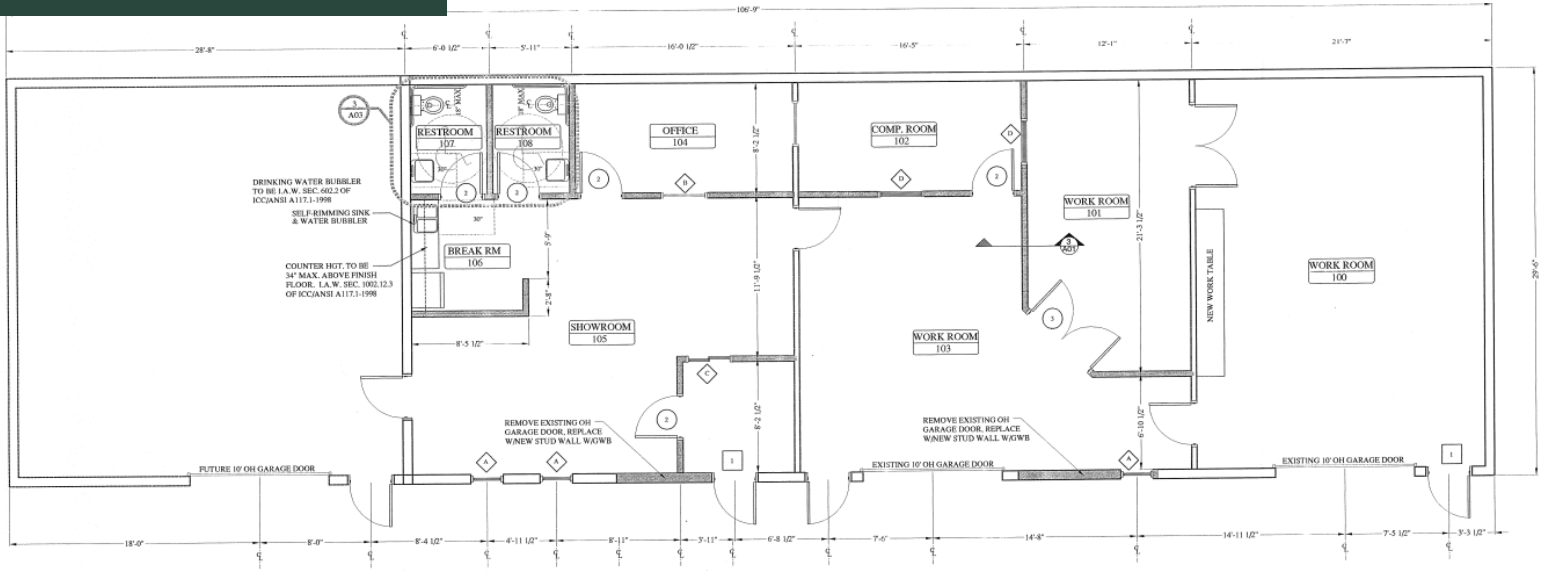

1307 Broughton Blvd Site Location



135 S Dargan St. Suite 301 | Florence, SC 29506 | Phone (843) 667-4999

www.palmettocommercial.com

No warranty or representation is made as to the accuracy of the information contained herein.

**1307 Broughton Blvd
Interior Photos**



135 S Dargan St. Suite 301 | Florence, SC 29506 | Phone (843) 667-4999

www.palmettocommercial.com

No warranty or representation is made as to the accuracy of the information contained herein.

1307 Broughton Blvd Interior Photos



135 S Dargan St. Suite 301 | Florence, SC 29506 | Phone (843) 667-4999

www.palmettocommercial.com

No warranty or representation is made as to the accuracy of the information contained herein.