

# FOR LEASE

📍 107 Flint Street | Jonesboro, AR 72401



**HALSEY**  
— REAL ESTATE —

Agent Ownership Disclaimer: One or more of the presenting agents has an ownership interest in the subject property. No warranty, expressed or implied, has been made as to the accuracy of this information. No liability is assumed for errors or omissions.

**Landon Wilson** Realtor®  
landon@halseyre.com

**870 972 9191**  
**HalseyRealEstate.com**





 107 Flint Street | Jonesboro, AR 72401

## OPPORTUNITY **OVERVIEW**

**\$6.50/SF NNN**

PRICE

**±25,218 SQFT**

AVAILABLE SPACE

## PROPERTY **HIGHLIGHTS**

- ✦ Modern industrial facility built in 2015 with updated features.
- ✦ Equipped with three dock-high doors, and one drive-in door.
- ✦ Includes 2 offices, 2 restrooms, and a durable warehouse floor.
- ✦ Positioned on a well-maintained lot with ample paved parking.
- ✦ Conveniently located in Downtown Jonesboro with easy accessibility.
- ✦ Build-to-suit options available to meet qualified tenant needs.



# HALSEY

REAL ESTATE

No warranty, expressed or implied, has been made as to the accuracy of this information. No liability is assumed for errors or omissions.

**Landon Wilson** Realtor®  
landon@halseyre.com

**870 972 9191**  
**HalseyRealEstate.com**





📍 107 Flint Street | Jonesboro, AR 72401



N



# HALSEY

REAL ESTATE

No warranty, expressed or implied, has been made as to the accuracy of this information. No liability is assumed for errors or omissions.

**Landon Wilson** Realtor®  
landon@halseyre.com

870 972 9191  
HalseyRealEstate.com





📍 107 Flint Street | Jonesboro, AR 72401

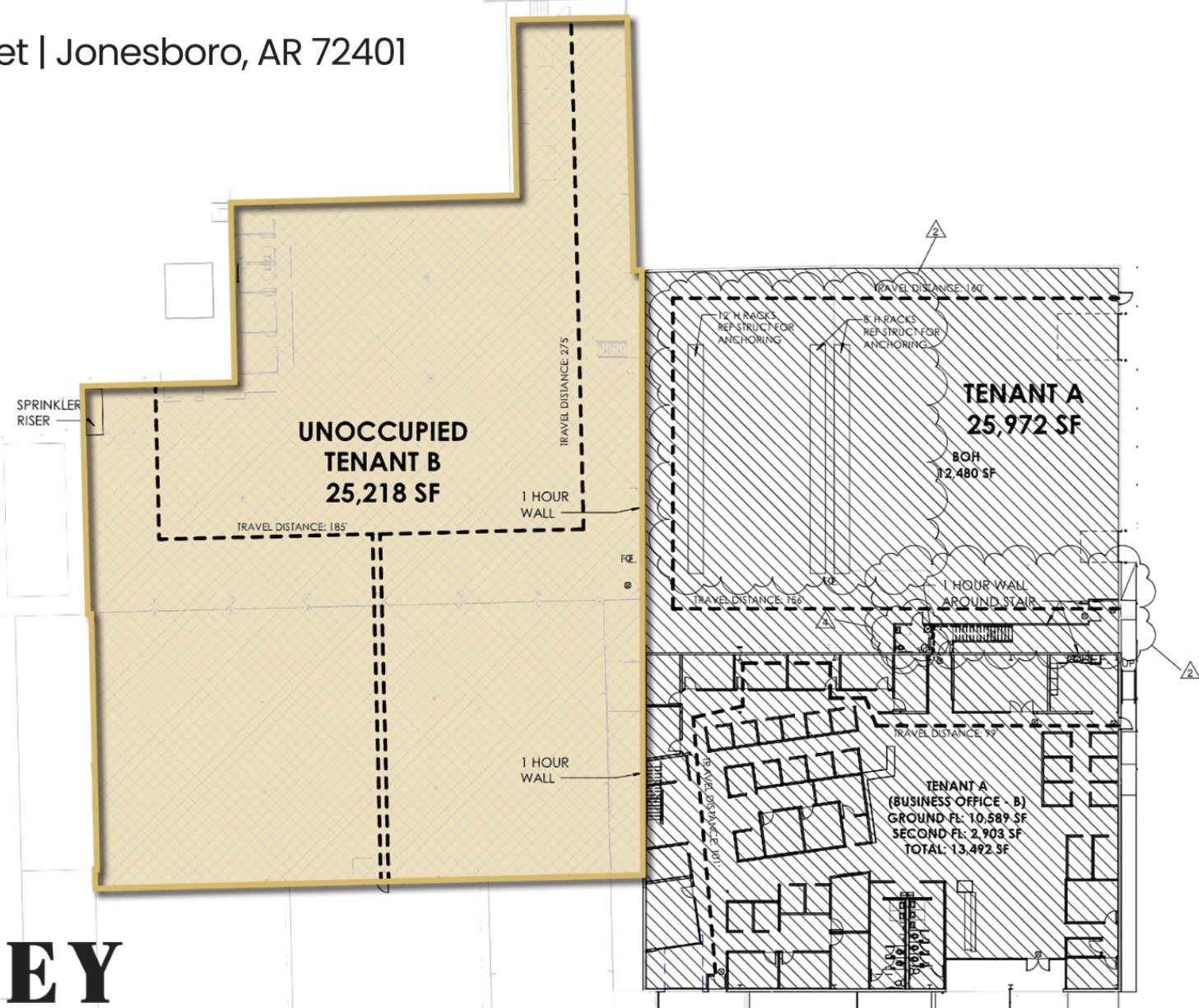

# FLOOR PLAN

**HALSEY**  
REAL ESTATE

Landon Wilson Realtor®  
landon@halseyre.com

No warranty, expressed or implied, has been made as to the accuracy of this information. No liability is assumed for errors or omissions.

870 972 9191  
HalseyRealEstate.com





📍 107 Flint Street | Jonesboro, AR 72401



INTERIOR

No warranty, expressed or implied, has been made as to the accuracy of this information. No liability is assumed for errors or omissions.

**HALSEY**  
REAL ESTATE

**Landon Wilson** Realtor®  
landon@halseyre.com

**870 972 9191**  
**HalseyRealEstate.com**





📍 107 Flint Street | Jonesboro, AR 72401

## DOWNTOWN BUSINESS DISTRICT

Downtown Jonesboro is a lively, walkable district at the city's core, blending history, culture, and community. Known for its local events, festivals, and unique charm, it serves as a central hub featuring medical facilities, professional services, art galleries, restaurants, and diverse retail. More than just a business area, Downtown reflects Jonesboro's cultural and economic spirit, offering a vibrant space that fosters connection and defines the city's identity.

## RESTAURANTS & RETAIL

**Skinny J's**



SHADRACH'S COFFEE  
ROASTING COMPANY



## KEY PLAYERS



- Completed a \$137,500,000, 245,000 sqft expansion in 2020.
- Has over 4,000 employees.



- City hall and city governments reside in Downtown.



- The Craighead County Courthouse recently completed a \$14 mil. expansion and held its ribbon cutting in March 2025.



- Patrol and Special Operations Divisions are located in Downtown Jonesboro.

# HALSEY

REAL ESTATE

**Landon Wilson** Realtor®  
landon@halseyre.com

No warranty, expressed or implied, has been made as to the accuracy of this information. No liability is assumed for errors or omissions.

870 972 9191  
HalseyRealEstate.com



MARKET MAP

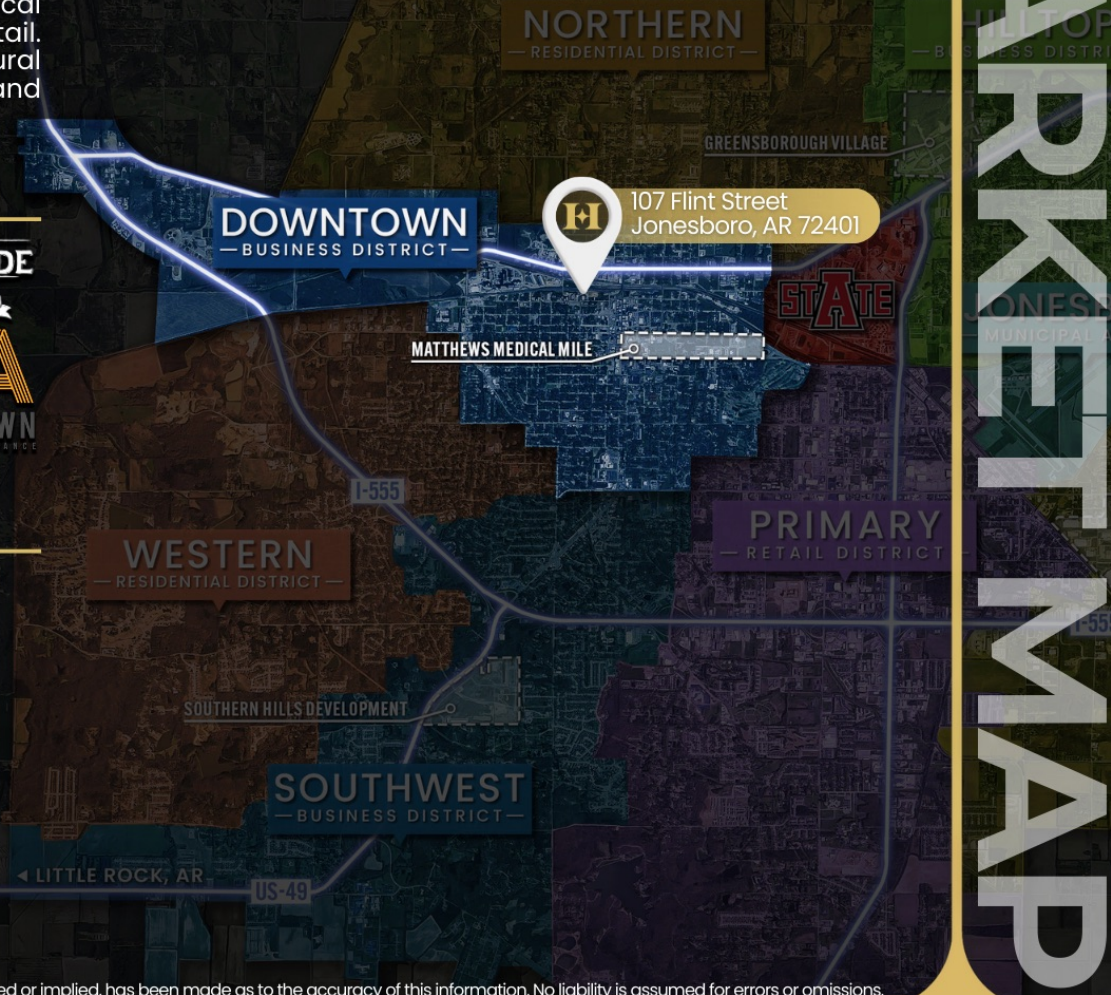



107 Flint Street | Jonesboro, AR 72401

# DEMOGRAPHICS



**HEALTH CARE & SOCIAL ASSISTANCE  
RETAIL TRADE  
MANUFACTURING**  
Top Employment Industries  
for Jonesboro, AR



**2.4**  
Avg. Size  
Household



**20.5 min.**  
Avg. Commute Time  
for Jonesboro, AR

## KEY FACTS

Based on a 7 mile ring of the subject property.



**94,899**  
Total Population



**\$235,088**  
Median Home Value



**3,761**  
Businesses



**103,730**  
Daytime Population



**34**  
Median Age



**\$32,523**  
Per Capita Income



**\$61,468**  
Median Household  
Income



**0.97%**  
2024-2029  
Pop Growth  
Rate

This infographic contains data provided by Esri (2024, 2029), Esri-Data Axle (2024), Esri-U.S. BLS (2024) and the Census Bureau ACS 5-year Estimate. No warranty, expressed or implied, has been made as to the accuracy of this information. No liability is assumed for errors or omissions.

# HALSEY

REAL ESTATE

**Landon Wilson** Realtor®  
landon@halseyre.com

**870 972 9191**  
**HalseyRealEstate.com**





# OPPORTUNITY CONTACT

Landon Wilson Leasing Agent  
License No. AR SA00094849  
870 514 5578  
landon@halseyre.com

107 Flint Street | Jonesboro, AR 72401



**HALSEY**  
REAL ESTATE

No warranty, expressed or implied, has been made as to the accuracy of this information. No liability is assumed for errors or omissions.

