

FOR SALE MIXED-USE/RESIDENTIAL DEVELOPMENT SITE

SE Hawthorne Road Gainesville, FL 32641



PROPERTY DESCRIPTION

This property is located in a qualified census tract for Florida Housing Finance Corporation programs. The parcel is approximately 5.69 acres and zoned to allow up to 8 units per acre. Under the County's Cottage Neighborhood Ordinance the density may be doubled to 16 units per acre when residential units are 1400 square feet or less. The property can also be used for a place of religious assembly, school, daycare, group home facilities, offices or a mix of non-residential and residential uses. There may be an additional 20 acres parcel with the same zoning abutting this parcel to the east.

OFFERING SUMMARY

Sale Price:	\$240,000
Lot Size:	5.69 Acres

DEMOGRAPHICS	1 MILE	3 MILES	5 MILES
Total Households	869	7,628	24,548
Total Population	2,430	21,921	68,167
Average HH Income	\$49,984	\$56,091	\$52,052

PROPERTY HIGHLIGHTS

- 5.69 Acres Vacant Mixed-Use Residential
- Located in the Alachua County Eastside Activity Center and the Opportunity Zone
- Located in a State of Florida Targeted Census Tract
- Great location for an Emergency Medical or Assisted Living Facility

RALPH HILLIARD
352 284 4977



**COLDWELL BANKER
COMMERCIAL**
M.M. PARRISH REALTORS

FOR SALE

MIXED-USE/RESIDENTIAL DEVELOPMENT SITE

SE Hawthorne Road Gainesville, FL 32641



RALPH HILLIARD
352 284 4977



**COLDWELL BANKER
COMMERCIAL**
M.M. PARRISH REALTORS

FOR SALE

MIXED-USE/RESIDENTIAL DEVELOPMENT SITE

SE Hawthorne Road Gainesville, FL 32641

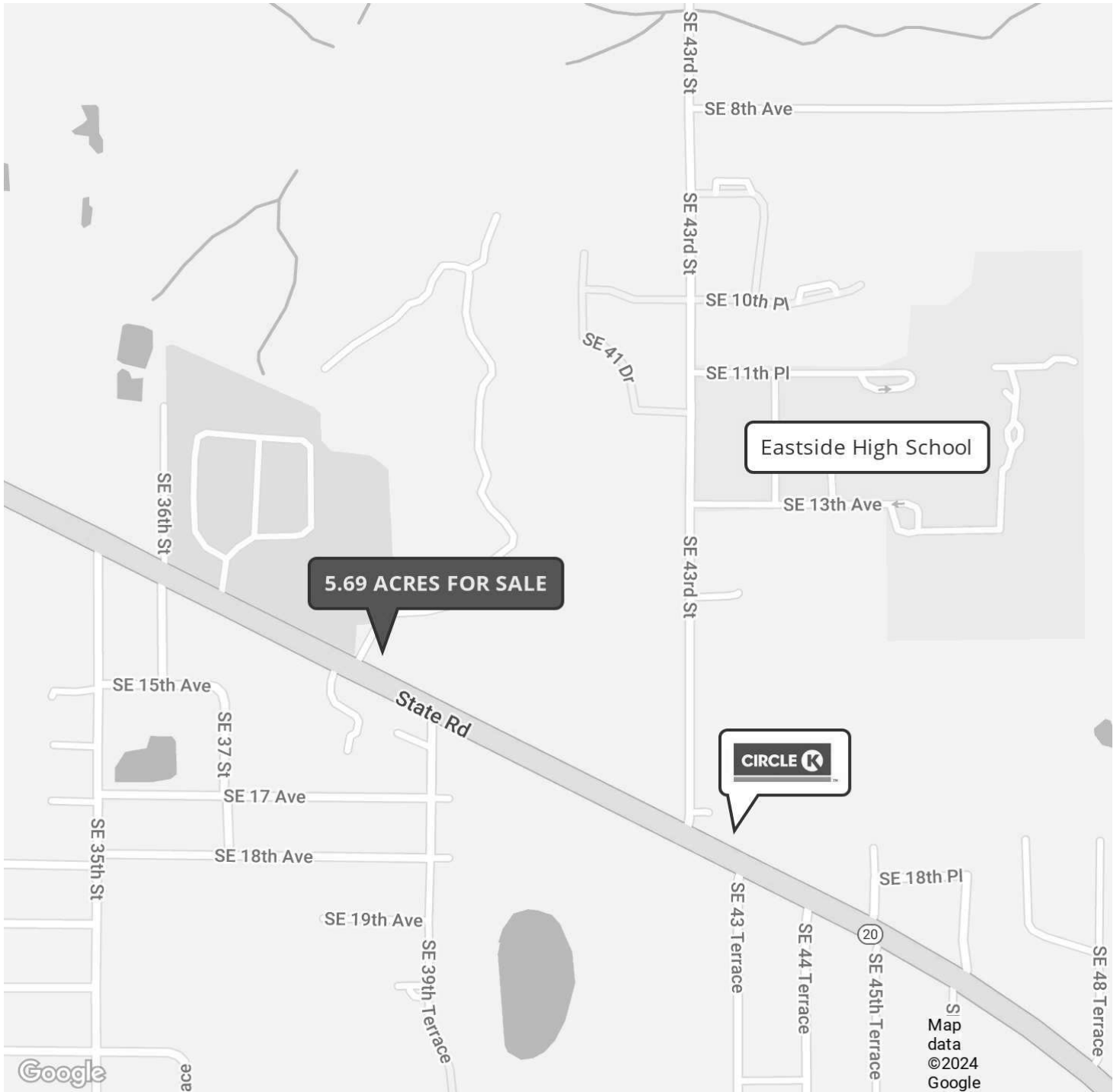

RALPH HILLIARD
352 284 4977



**COLDWELL BANKER
COMMERCIAL**
M.M. PARRISH REALTORS

FOR SALE

MIXED-USE/RESIDENTIAL DEVELOPMENT SITE

SE Hawthorne Road Gainesville, FL 32641

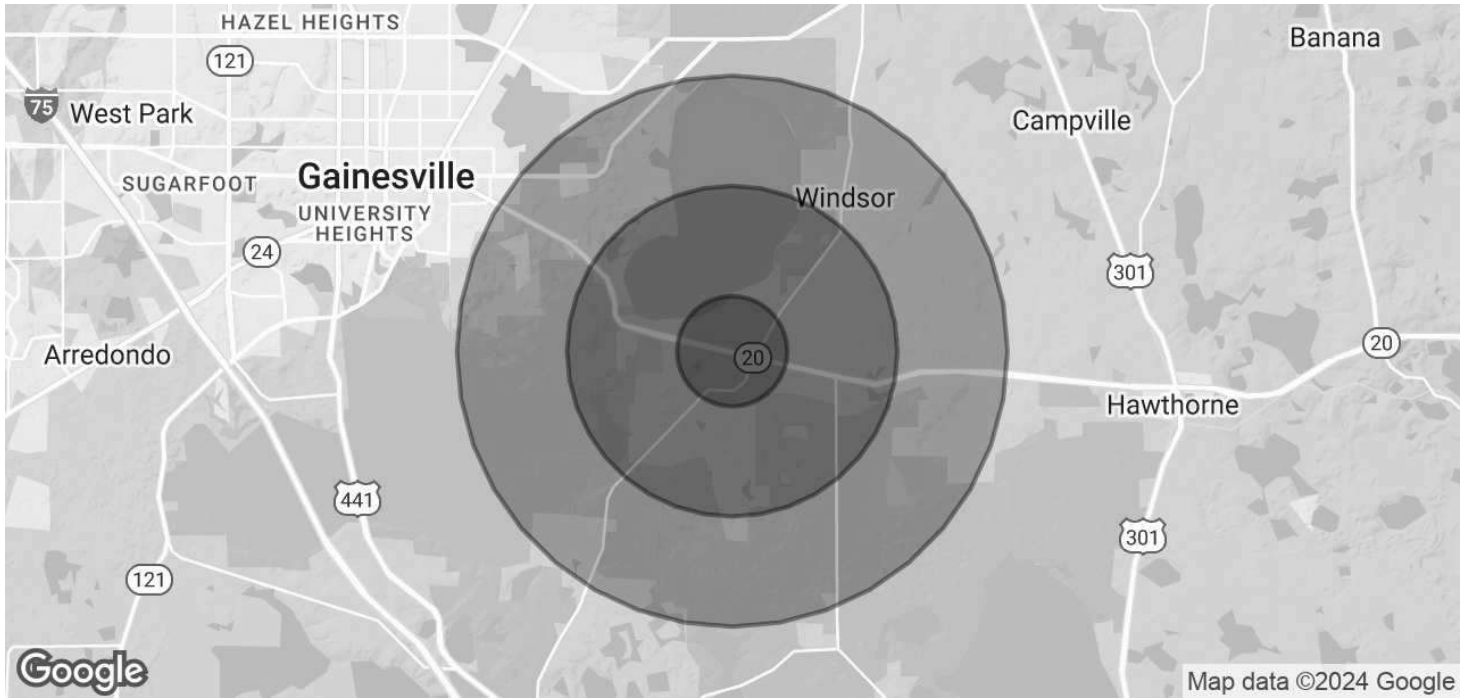

POPULATION	1 MILE	3 MILES	5 MILES
Total Population	2,430	21,921	68,167
Average Age	31.2	32.9	28.6

HOUSEHOLDS & INCOME	1 MILE	3 MILES	5 MILES
Total Households	869	7,628	24,548
# of Persons per HH	2.9	2.8	2.9
Average HH Income	\$49,984	\$56,091	\$52,052
Average House Value	\$118,184	\$132,749	\$154,660

2020 American Community Survey (ACS)

RALPH HILLIARD
352 284 4977



**COLDWELL BANKER
COMMERCIAL**
M.M. PARRISH REALTORS

FOR SALE

MIXED-USE/RESIDENTIAL DEVELOPMENT SITE QUALIFIED

SE Hawthorne Road Gainesville, FL 32641



RALPH HILLIARD

Commercial Real Estate Agent

Direct: 352.284.4977 **Cell:** 352.284.4977

rhilliard@mmparrish.com

RALPH HILLIARD
352 284 4977



**COLDWELL BANKER
COMMERCIAL**
M.M. PARRISH REALTORS