

FOR LEASE

Owned and Operated by 

1719 CHAPIN ROAD

Montebello, CA

±84,026 SF

\$0.85 PSF NNN 6-MONTH RATE



*Teaser rate will be applied to a qualified 5-year lease transaction. Rate will increase to market value at the end of the promotion

**LEASING INFO
& CONTACT**

John Reno, SIOR, CCIM

Mark Vanis

Trevor Gale, SIOR

Sage Segal

Lic # 01277642

Lic #01305617

Lic # 01452957

Lic # 02099925

213.271.1508 | Jon.reno@jll.com

213.239.5908 | mark.vanis@jll.com

213.239.6256 | Trevor.gale@jll.com

213.239.6078 | Sage.segal@jll.com



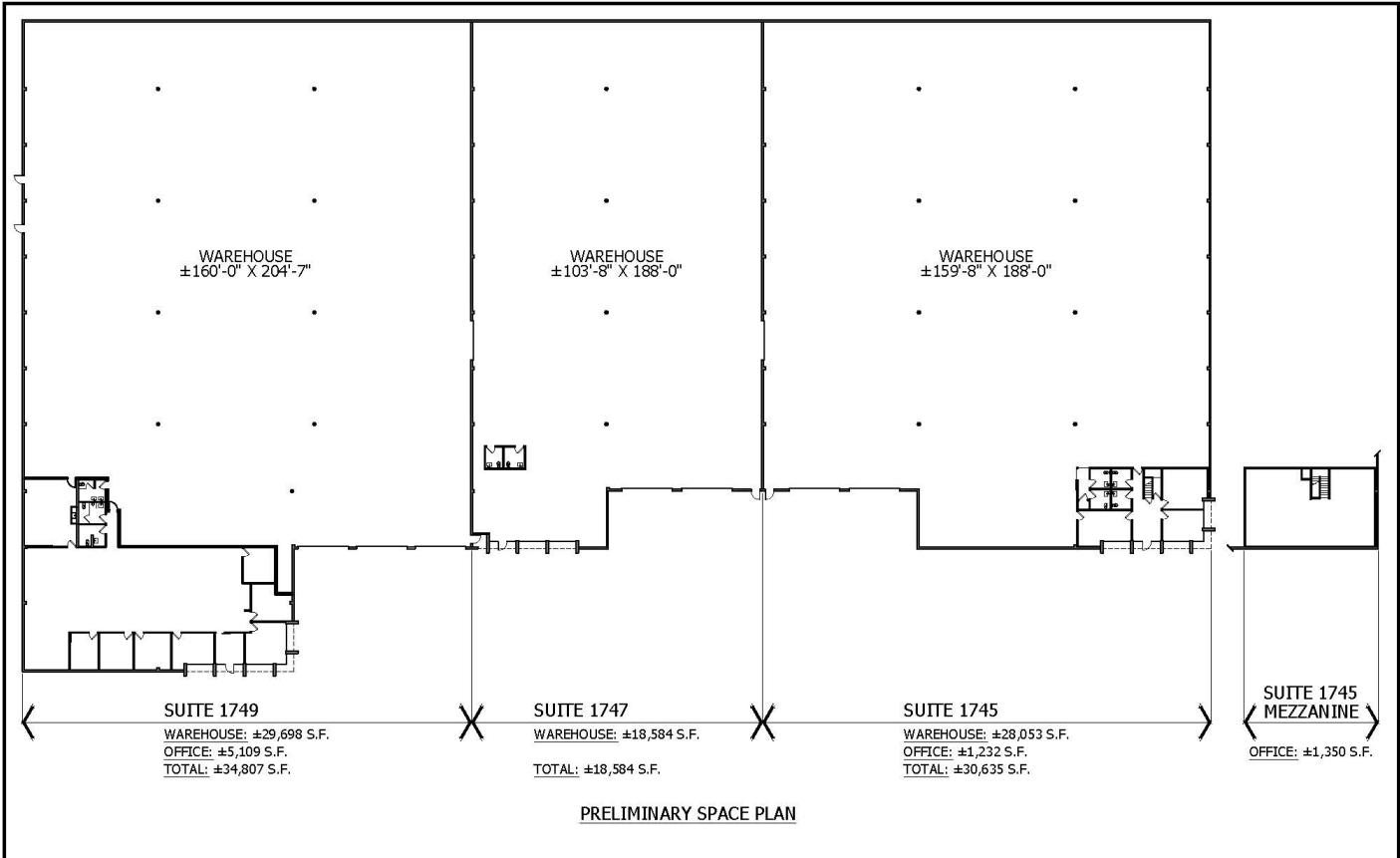

BUILDING AND SITE HIGHLIGHTS

Building Size:	+/- 84,026 SF
Office:	+/- 6,341 SF
Mezzanine:	+/- 1,350 SF
Clear Height:	24'

Loading Dock:	Twelve (12)
Drive-Ins:	Two (2)
Sprinklers:	.40/3000 GPM
Power:	800 amps; 277/480