

# THE FORMA

2016 TELEGRAPH AVENUE  
UPTOWN, OAKLAND

| 2,341 SF



Jamie Flaherty-Evans  
510-334-8606  
jamie@chromataRE.com  
DRE Lic # 01432663

John Polyzoides  
510-495-4018  
john@chromataRE.com  
DRE Lic # 01942201

**CHROMATA**  
RETAIL

**ADDRESS** 2016 Telegraph Avenue

**AVAILABLE SPACE** 2,431 SF

## NEIGHBORHOOD HIGHLIGHTS

The Forma is a recently completed 23-story, 223 unit high-rise located in Uptown featuring a highly visible retail site. Located on 20th St, between Broadway and Telegraph Ave and just steps to 19th Street BART, this ideal space is one block from the Fox and Paramount theaters and surrounded by several other new residential & office buildings.

- ±2,341SF of ground floor retail
- Available now
- Located on busy traffic and pedestrian corridor, surrounded by a dense residential population
- 1/2 block to 19th Street BART Station, AC Transit, and other public ride options
- Surrounded by buzzy restaurants, cocktail bars and taprooms
- Across the street from Uptown Station and Block's leased offices
- In the heart of the entertainment district with the Fox and Crybaby a block away
- Over 3,500 new residential units and over 3.3 million square feet of office space completed or under construction within the surrounding blocks
- Daytime population / 10min drive: 168,407
- 2025 Estimated population / 10 min drive: 262,927



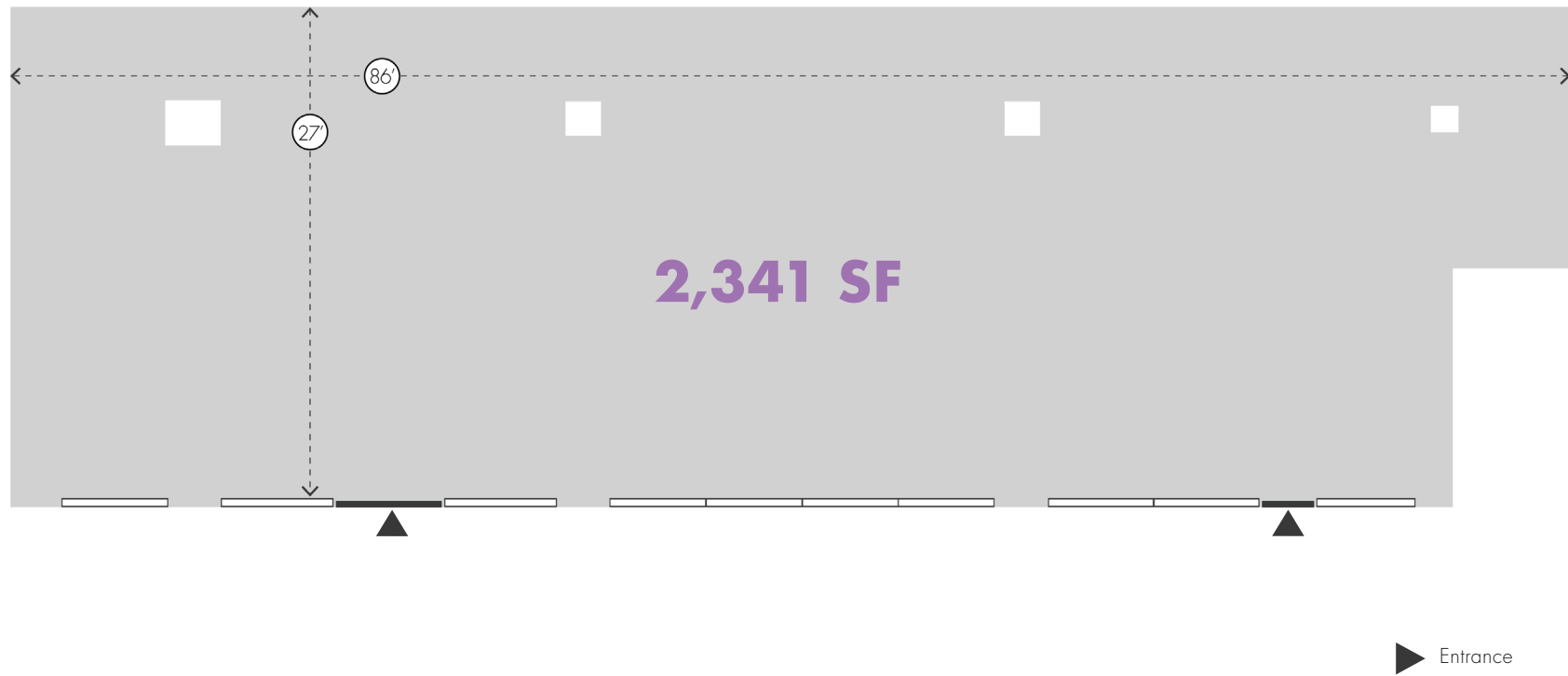

## SPECS

- 20'-5" Ceiling Height
- 400Amp Electrical Panel
- Expansive Window Frontage

TAPROOM CONCEPT

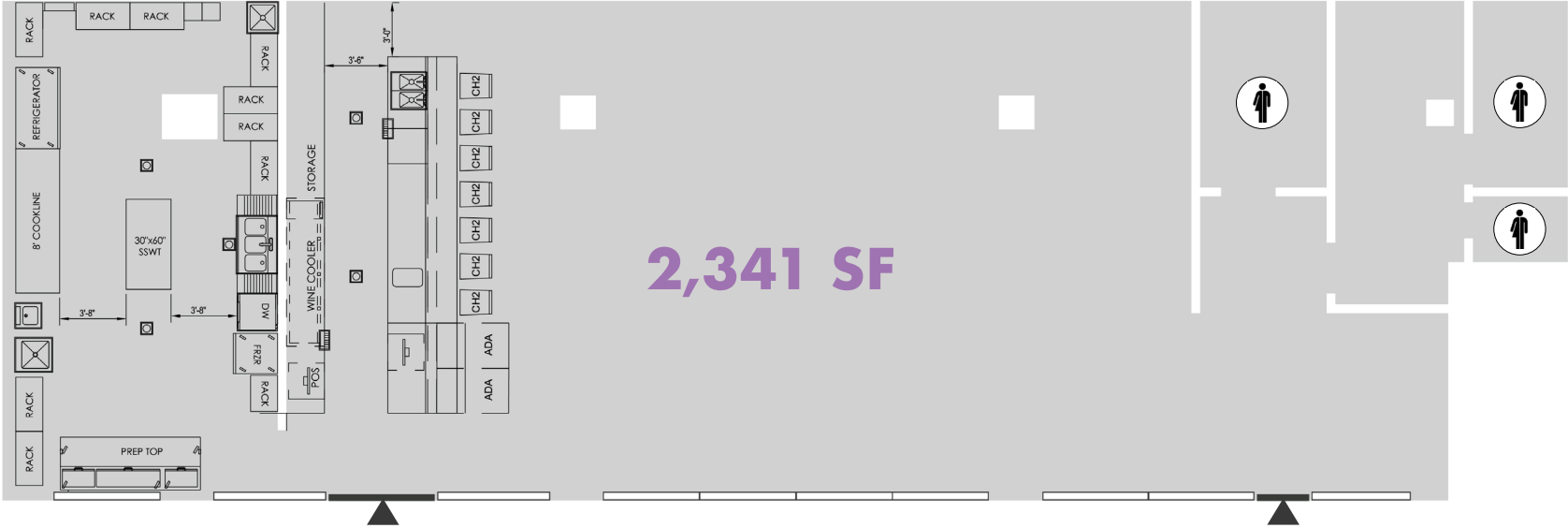

SPECS

- 20'-5" Ceiling Height
- 400Amp Electrical Panel
- Expansive Window Frontage



MULTI-USE: CAFE & RETAIL

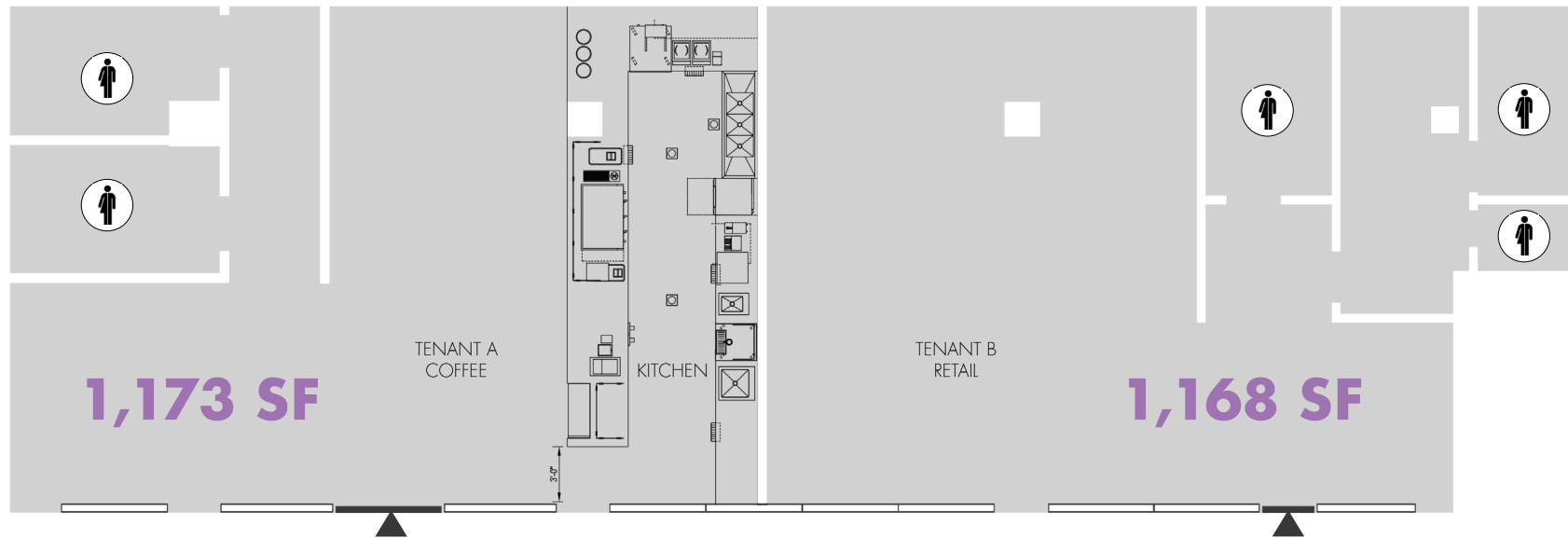

**SPECS**

- 20'-5" Ceiling Height
- 400Amp Electrical Panel
- Expansive Window Frontage



RETAIL & RESTAURANTS

- Agave Uptown
- Fox Theatre
- Crybaby
- Xolo
- Little Giant
- Itani Ramen
- Masabaga
- Gold Palm
- Lucy Blue
- The Hive
- Drakes Brewing
- Night Heron
- One Medical
- Miharu
- Gold Palm
- Lucy Blue
- Haus of Chefs
- Marin's Kitchen
- Shawarmaji
- Mama's Boy
- Viridian
- Ike's
- The Melt
- Parche
- Fox Theatre
- OSA





Jamie Flaherty-Evans  
510-334-8606 | jamie@chromataRE.com  
DRE Lic # 01432663

John Polyzoides  
510-495-4018 | john@chromataRE.com  
DRE Lic # 01942201

**CHROMATA**  
RETAIL  
ChromataRE.com

The information contained herein has been obtained from sources deemed reliable but has not been verified and no guarantee, warranty or representation, either express or implied, is made with respect to such information. Terms of sale or lease and availability are subject to change or withdrawal without notice.