

FOR LEASE

4 9 5
EDISON COURT



± 5,510 SF WAREHOUSE SPACE AVAILABLE FOR LEASE

495 Edison Court, Suite D

- ±5,510 SF warehouse space for lease
- ±300 SF of office space
- 20'-22' clear height in warehouse area
- 200 amps, 120/208 volt, 3-phase electrical
- One (1) grade-level loading door
- Available September 2024

Location Details:

495, 497, 499 Edison Court is a uniquely well-located and highly-visible multi-tenant light industrial property in the Cordelia Industrial Park at the intersection of Interstates 80, 680 and Highway 12.

Located in Fairfield, CA, midway between San Francisco / Oakland and Sacramento, the Property has excellent access to Napa and Solano Counties and the surrounding Bay Area. The buildings offer 22'-26' clear heights, convenient parking, and flexible floor plans.



To Schedule a Tour or For More Information, Please Contact:



CHRIS NEEB
chris.neeb@jll.com
(707) 495 7777
RE License No: 01324612

MATT BRACCO
matt.bracco@jll.com
(925) 200 3537
RE License No: 01185434

GLEN DOWLING
glen.dowling@jll.com
(707) 227 7800
RE License No: 00890450

FOR LEASE

4 9 5

EDISON COURT

Suite D: ±5,510 SF

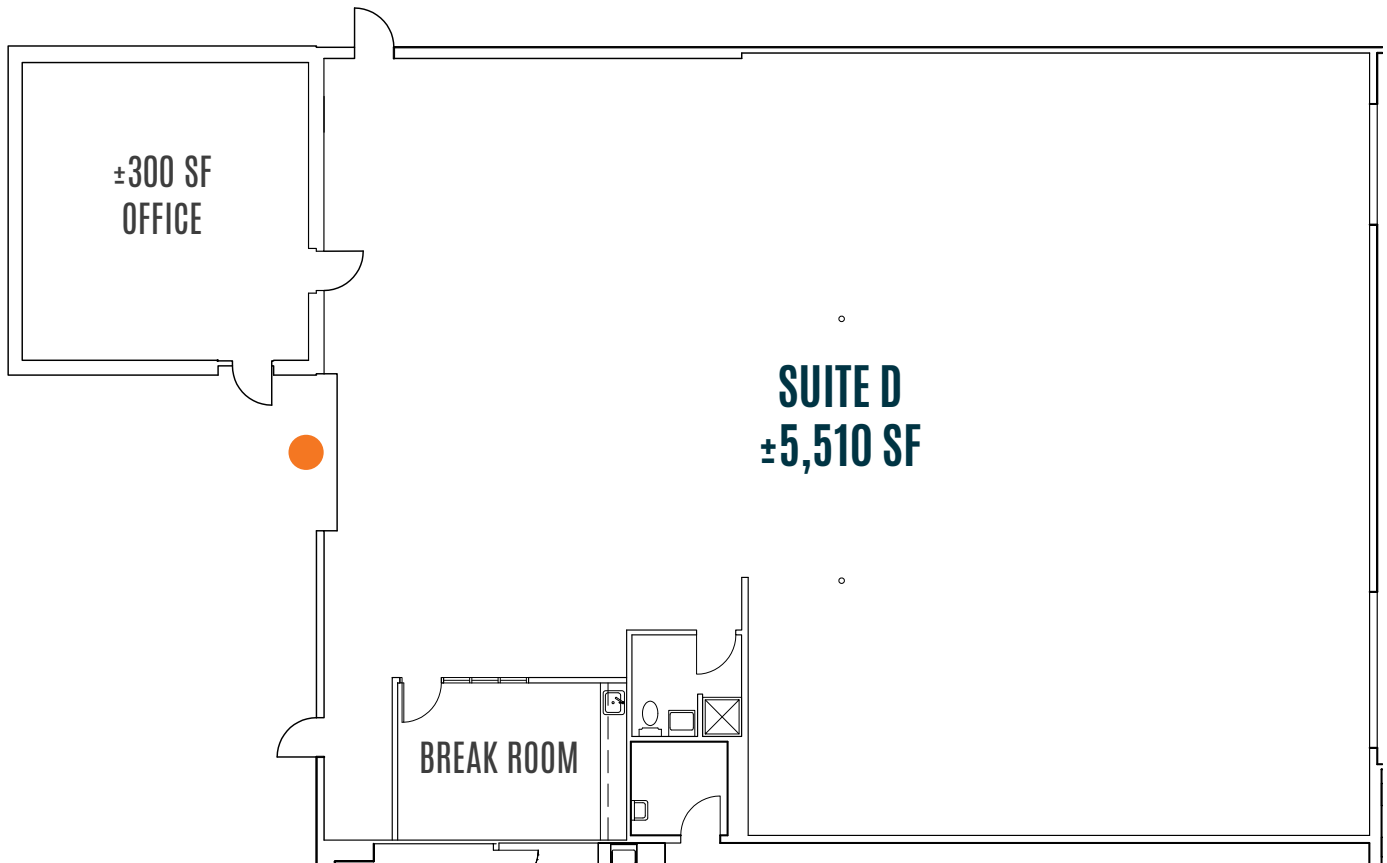

● Grade-Level Door



CHRIS NEEB
chris.neeb@jll.com
(707) 495 7777
RE License No: 01324612

MATT BRACCO
matt.bracco@jll.com
(925) 200 3537
RE License No: 01185434

GLEN DOWLING
glen.dowling@jll.com
(707) 227 7800
RE License No: 00890450

4 9 5

EDISON COURT



CHRIS NEEB
chris.neeb@jll.com
 (707) 495 7777
 RE License No: 01324612

MATT BRACCO
matt.bracco@jll.com
 (925) 200 3537
 RE License No: 01185434

GLEN DOWLING
glen.dowling@jll.com
 (707) 227 7800
 RE License No: 00890450

Although information has been obtained from sources deemed reliable, neither Owner nor JLL makes any guarantees, warranties or representations, express or implied, as to the completeness or accuracy as to the information contained herein. Any projections, opinions, assumptions or estimates used are for example only. There may be differences between projected and actual results, and those differences may be material. The Property may be withdrawn without notice. Neither Owner nor JLL accepts any liability for any loss or damage suffered by any party resulting from reliance on this information. If the recipient of this information has signed a confidentiality agreement regarding this matter, this information is subject to the terms of that agreement. ©2024. Jones Lang LaSalle IP, Inc. All rights reserved. Jones Lang LaSalle Brokerage, Inc. RE Lic# 01856260