

47000 LIBERTY DRIVE
WIXOM, MICHIGAN

HI-TECH FOR SALE OR LEASE
24,655 Square Feet Available



**SIGNATURE
ASSOCIATES**
KNOW SIGNATURE | KNOW RESULTS

WIXOM BUSINESS CENTER



PROPERTY FEATURES

- 24,655 square feet available
- 16,765 square foot two-story office
- 20' clear height
- (2) 12' x 14' grade level doors
- Corporate image with Beck Road frontage
- 0.5 miles north of I-96 freeway
- Extremely well-maintained
- Open office floor plan
- Fully air-conditioned shop
- 47-car parking
- 600 amps, 208/480 volt, 3-phase power
- Lease Rate: \$10.50/sq. ft. NNN
- Sale Price: \$3,081,875 (\$125.00/sq. ft.)

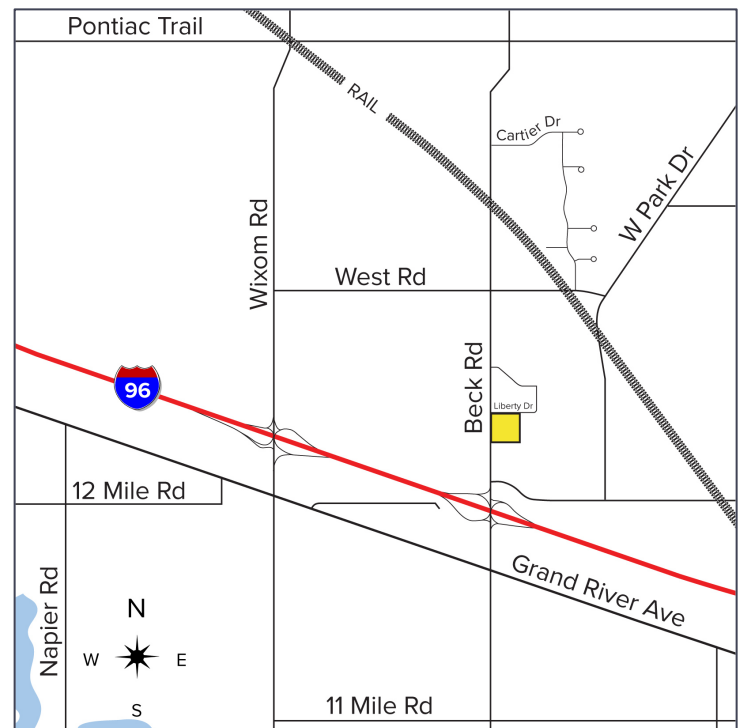

For more information, please contact:

JIM MONTGOMERY
(248) 359 0614

jmontgomery@signatureassociates.com

CHRISTOPHER M. D'ANGELO
(248) 948 0109

cdangelo@signatureassociates.com

SIGNATURE ASSOCIATES
One Towne Square, Suite 1200
Southfield, MI 48076
www.signatureassociates.com

47000 Liberty Drive – Wixom, Michigan

Hi-Tech For Sale or Lease

24,655
Square Feet
AVAILABLE

Aerial



For more information, please contact:

JIM MONTGOMERY
(248) 359 0614
jmontgomery@signatureassociates.com

CHRISTOPHER M. D'ANGELO
(248) 948 0109
cdangelo@signatureassociates.com

SIGNATURE ASSOCIATES
One Towne Square, Suite 1200
Southfield, MI 48076
www.signatureassociates.com