

LEASE RATE: \$0.95-\$1.05/SF



5th South Industrial Complex

**2950 W. 500 S.
SALT LAKE CITY, UT 84104**

For Lease

UNIT 20

- ±7,300 available SF
 - ± 594 office SF
 - ± 6,706 warehouse SF
- One ground level door (12'x12')
- LED lighting
- 400 amp / 240 v / 3-phase power supply
- Clear height: 14'-21'

UNIT 40

- ± 7,000 available SF
 - ±834 office SF
 - ±6,166 warehouse SF
- 14' clear height
- One (1) ground level door (12'x12')
- 200 amp 3-phase power supply
- T-5 warehouse lighting
- Gas forced air in warehouse
- One (1) restroom

UNIT 70

- ±6,300 available SF
- One (1) ground level door (15'x11')
- Three (3) ground level door (12'x12')
- Private Restroom
- LED Lighting
- Sprinklers
- Gas Forced Air
- 200 amp / 3-phase power supply
- Clear Height 14'

UNIT 80

- ± 4,200 available SF
 - ± 400 restroom SF
 - ±3800 warehouse SF
- Two (2) ground level doors (14'x14') (14'x12')
- Clear height: 14'-20'
- 200 amp / 208/12 volt / 3-phase power supply
- Swamp cooler
- Gas forced air heating in warehouse

For information, please contact:

Eli Priest

Senior Managing Director

t 801-746-4746

epriest@newmarkmw.com

Jason Hone

Associate

t 801-578-5586

jhone@newmarkmw.com

376 E. 400 S.

Suite 120

Salt Lake City, UT 84111

NEWMARK



The information contained herein has been obtained from sources deemed reliable but has not been verified and no guarantee, warranty or representation, either express or implied, is made with respect to such information. Terms of sale or lease and availability are subject to change or withdrawal without notice.

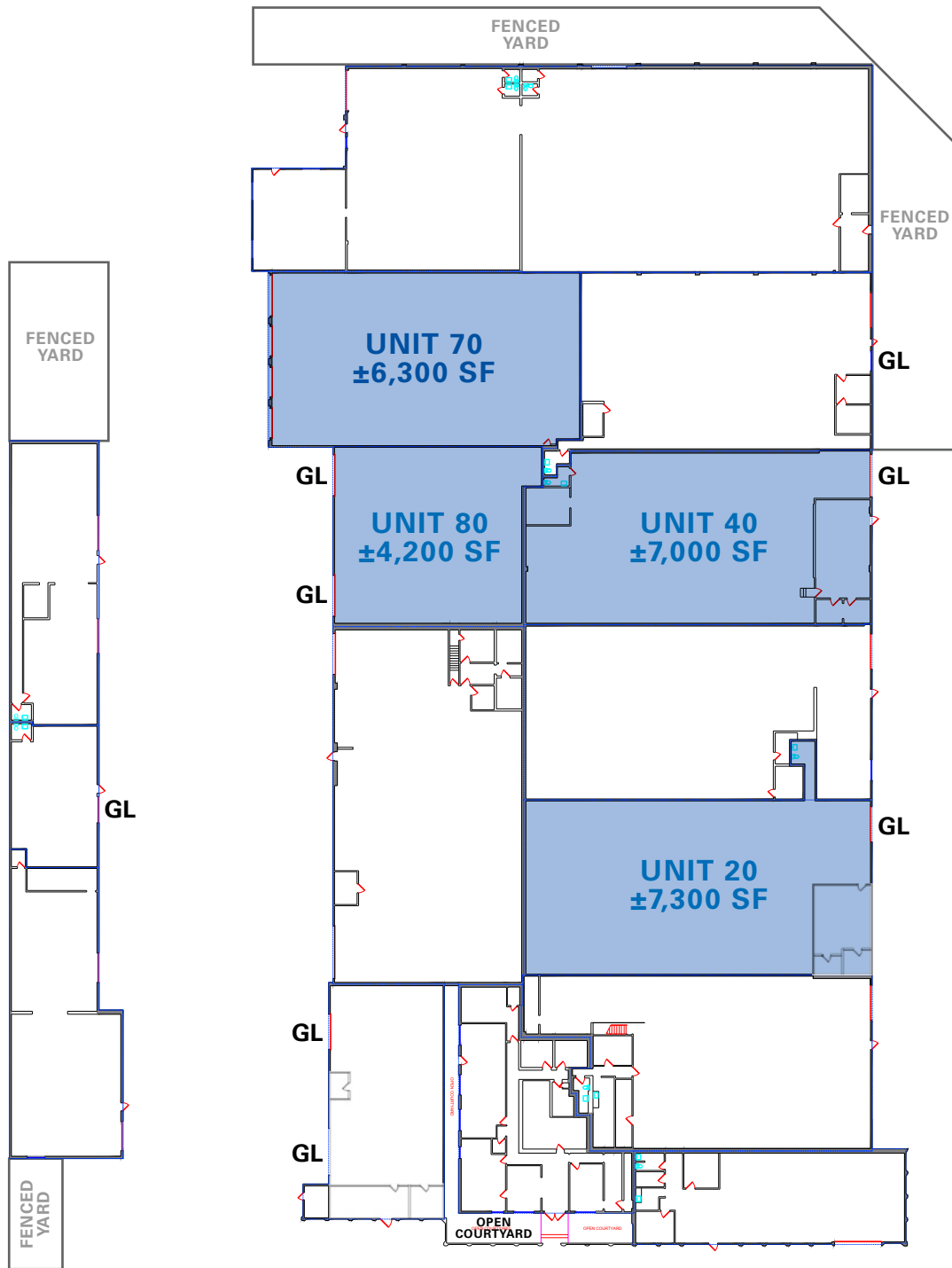

For information, please contact:

Eli Priest

Senior Managing Director

t 801-746-4746

epriest@newmarkmw.com

Jason Hone

Associate

t 801-578-5586

jhone@newmarkmw.com

376 E. 400 S.

Suite 120

Salt Lake City, UT 84111

NEWMARK



MOUNTAIN WEST

The information contained herein has been obtained from sources deemed reliable but has not been verified and no guarantee, warranty or representation, either express or implied, is made with respect to such information. Terms of sale or lease and availability are subject to change or withdrawal without notice.

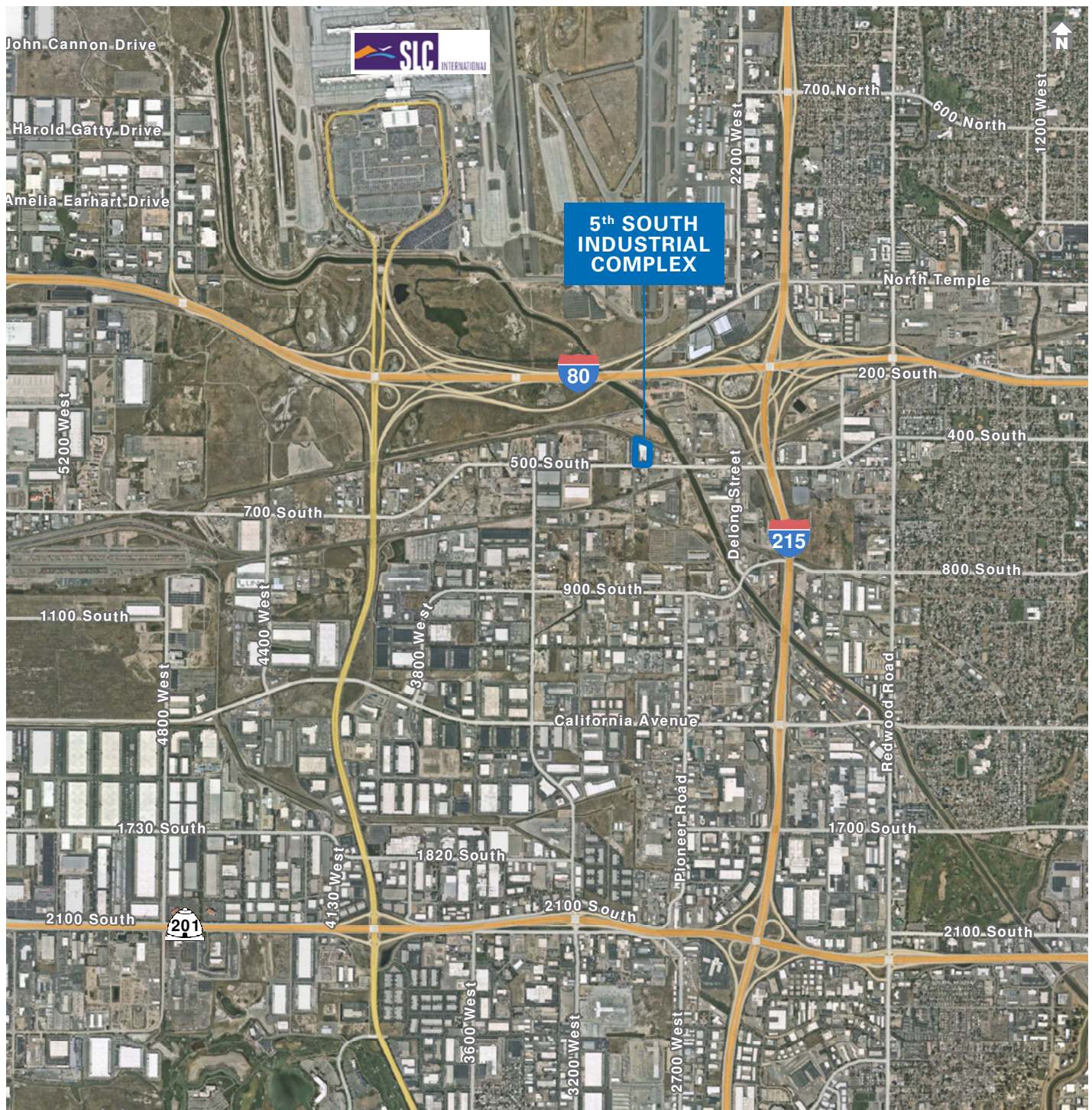

For information, please contact:

Eli Priest

Senior Managing Director

t 801-746-4746

epriest@newmarkmw.com

Jason Hone

Associate

t 801-578-5586

jhone@newmarkmw.com

376 E. 400 S.

Suite 120

Salt Lake City, UT 84111

NEWMARK

MOUNTAIN WEST

The information contained herein has been obtained from sources deemed reliable but has not been verified and no guarantee, warranty or representation, either express or implied, is made with respect to such information. Terms of sale or lease and availability are subject to change or withdrawal without notice.