



FOR LEASE



MACADAM PLACE

Available Office Spaces: 1,797 - 2,780 SF

6915 SW Macadam Avenue, Portland, OR

Macadam Place is located in the vibrant John's Landing Community of South Portland, walking distance to retail, restaurants, and parks nearby. This property offers Willamette River views and provides tenants with excellent proximity to Downtown Portland and the southwest suburbs.

Brand new bike storage facility, tenant coffee lounge, and showers ready for Tenant use!

MCCOY DOERRIE, SIOR
Senior Vice President | Licensed in OR & WA
503-523-7751 | mccoy@capacitycommercial.com

JEFF FALCONER, SIOR
Principal | Licensed in OR
503-542-4346 | jeff@capacitycommercial.com



BUILDING SPECS



**FOR
LEASE**



PROPERTY DETAILS & AMENITIES

Address	6915 SW Macadam Avenue, Portland, OR
Total Available SF	4,577 SF
Renovated	Lobby & Common Area Upgrades Recently Completed
Free Parking	<ul style="list-style-type: none">• 2.80/1,000 SF• 50 Surface Spaces• 20 Covered Spaces



SHOWER



FREE
PARKING



ESPRESSO
MACHINE



FITNESS
ROOM



BIKE
ROOM

AVAILABILITIES

Suite 255	1,797 RSF	\$32.50 RSF - Full Service
Suite 325	2,780 RSF	\$36.00 RSF - Full Service



AVAILABLE SUITES

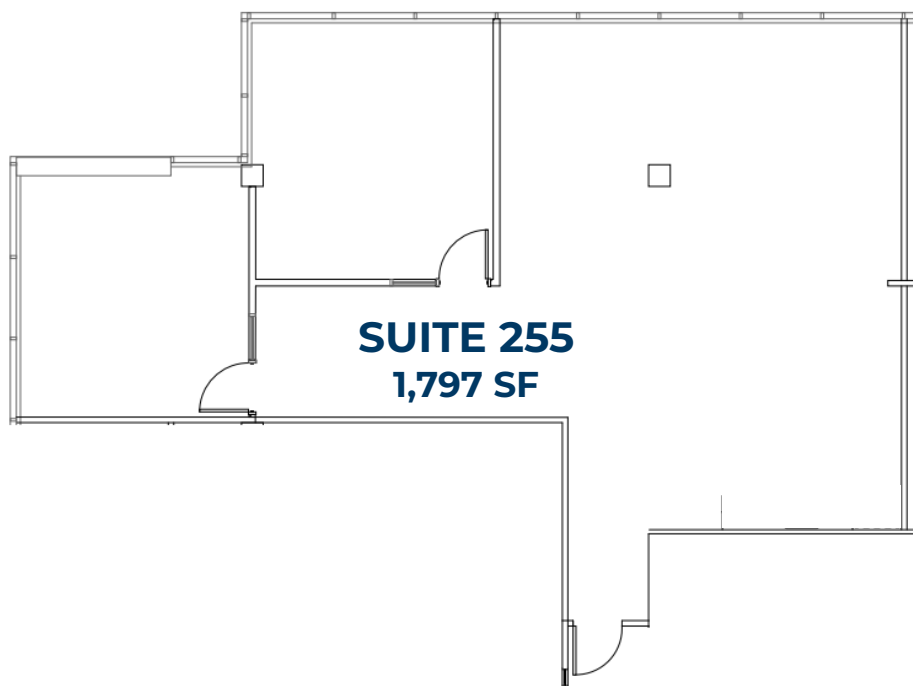
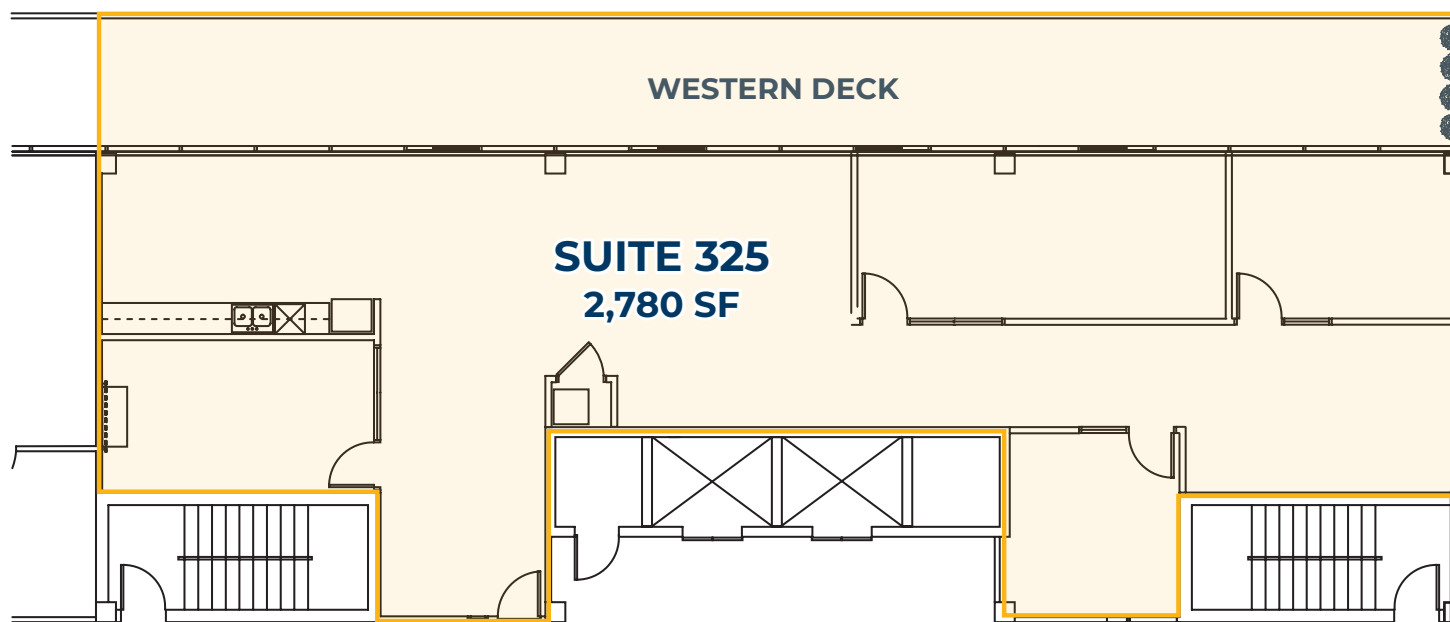



MCCOY DOERRIE, SIOR
Senior Vice President | Licensed in OR & WA
503-523-7751 | mccoy@capacitycommercial.com

JEFF FALCONER, SIOR
Principal | Licensed in OR
503-542-4346 | jeff@capacitycommercial.com

MACADAM PLACE