



# Old Augusta Commerce Center Building 3

1301 Logistics Parkway, Savannah, GA  
EFFINGHAM COUNTY

**350,000 - 1,112,108 SF AVAILABLE**



# Building 3 - Property Specifications

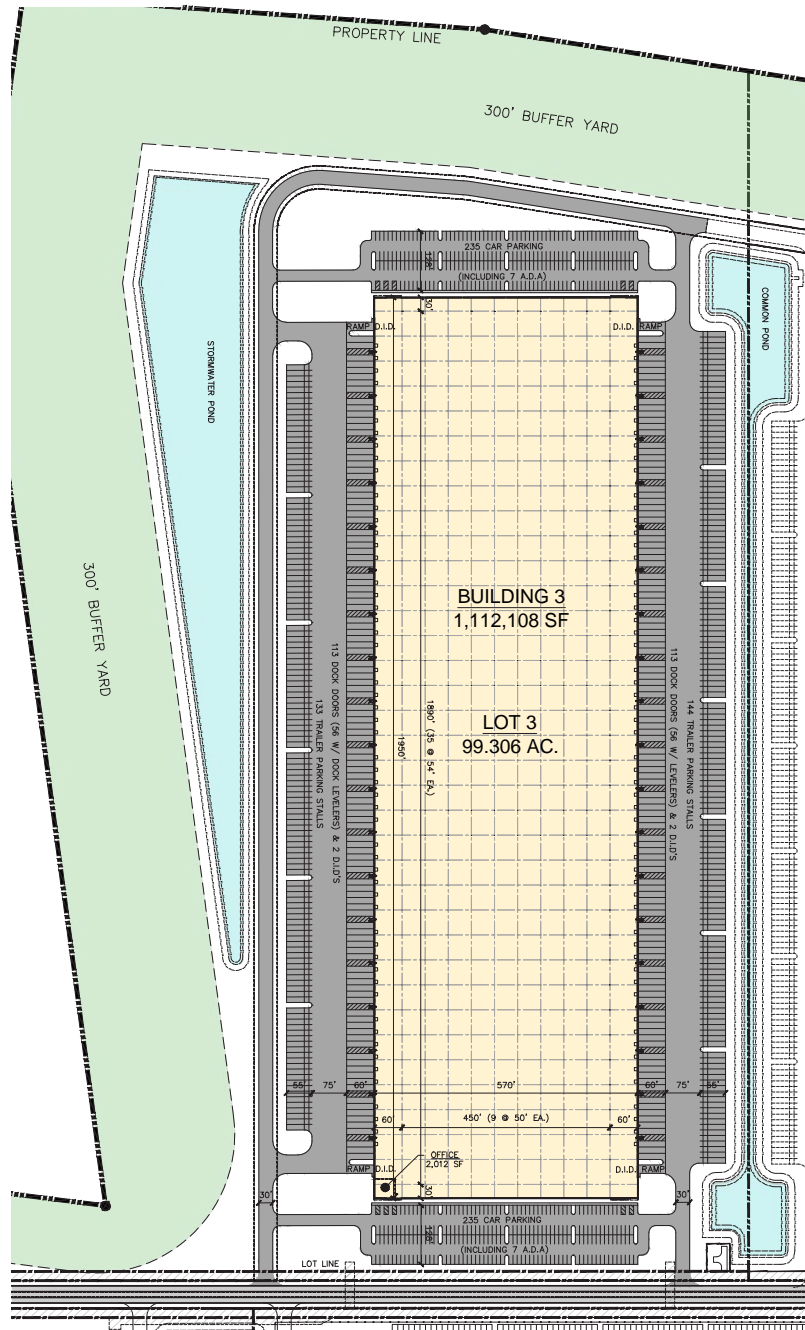

<b>Total building SF</b>	+/- 1,112,108 SF
<b>Available SF</b>	350,000 - 1,112,108 SF
<b>Building dimensions</b>	1950' x 570'
<b>Column spacing</b>	54' X 50'
<b>Speed bay</b>	60'
<b>Truck court depth</b>	190'
<b>Clear height</b>	40'
<b>Trailer parks</b>	277
<b>Auto parks</b>	240
<b>Dock high doors</b>	226
<b>Levelers</b>	112 with 40,000 lb capacity
<b>Drive in doors</b>	4
<b>Sprinkler</b>	ESFR
<b>Power</b>	4,000 amps/480v 3 phase
<b>Slab</b>	7" unreinforced
<b>Warehouse lighting</b>	25 FC LEDs @ 36"
<b>Office SF</b>	2,012 SF spec office
<b>Warehouse finish</b>	White box

# Park Configuration Options - Option A

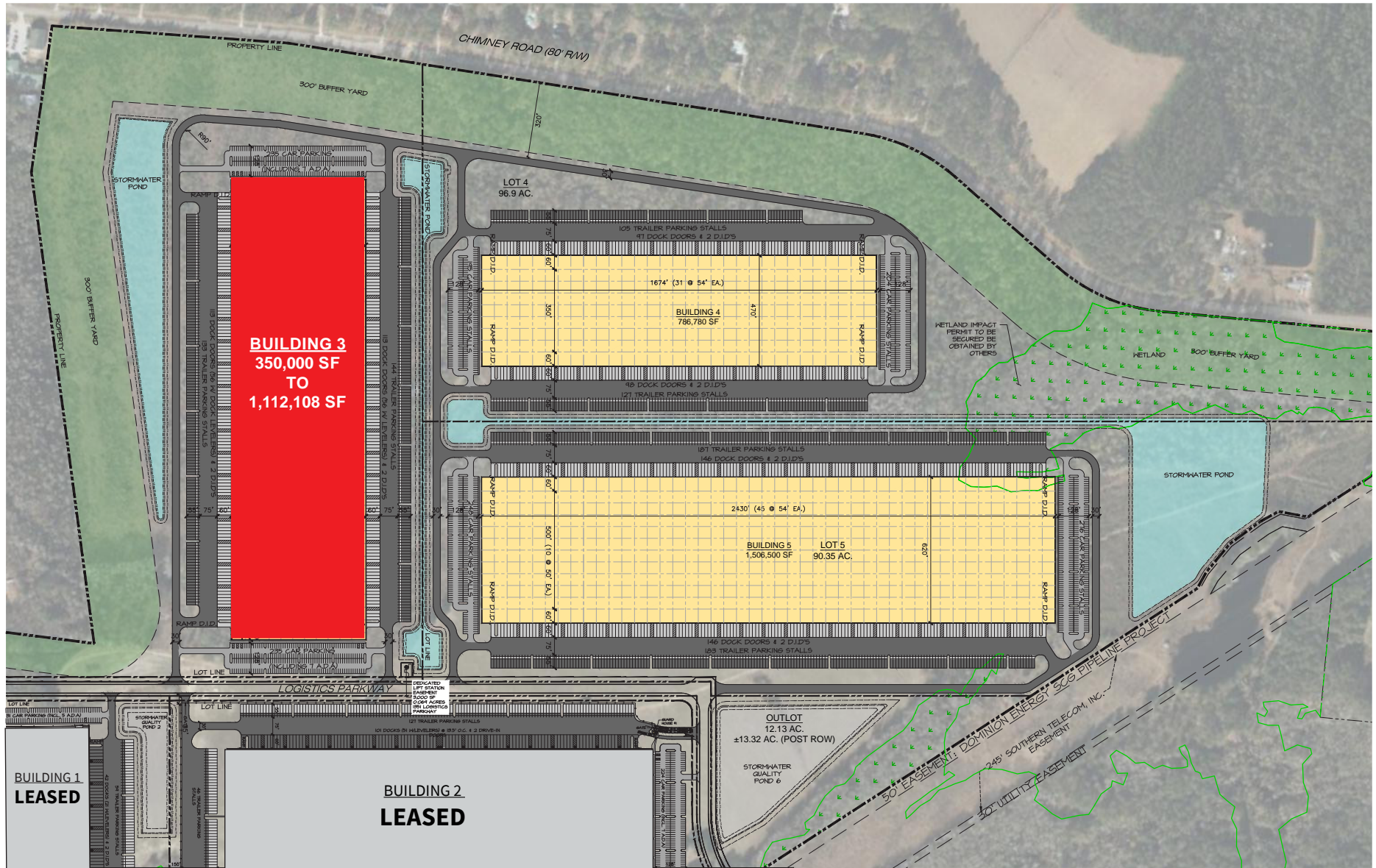



# Park Configuration Options - Option B

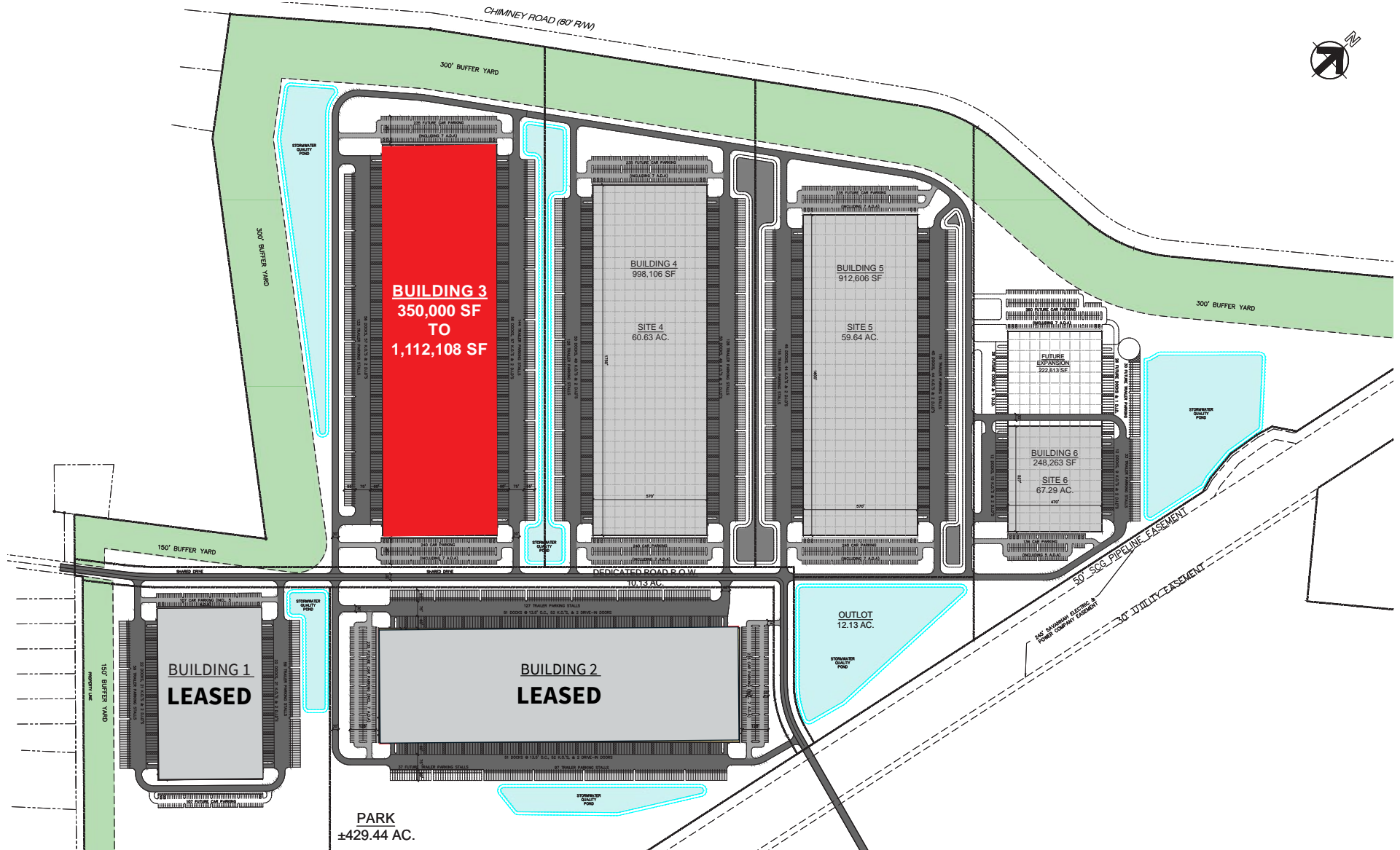

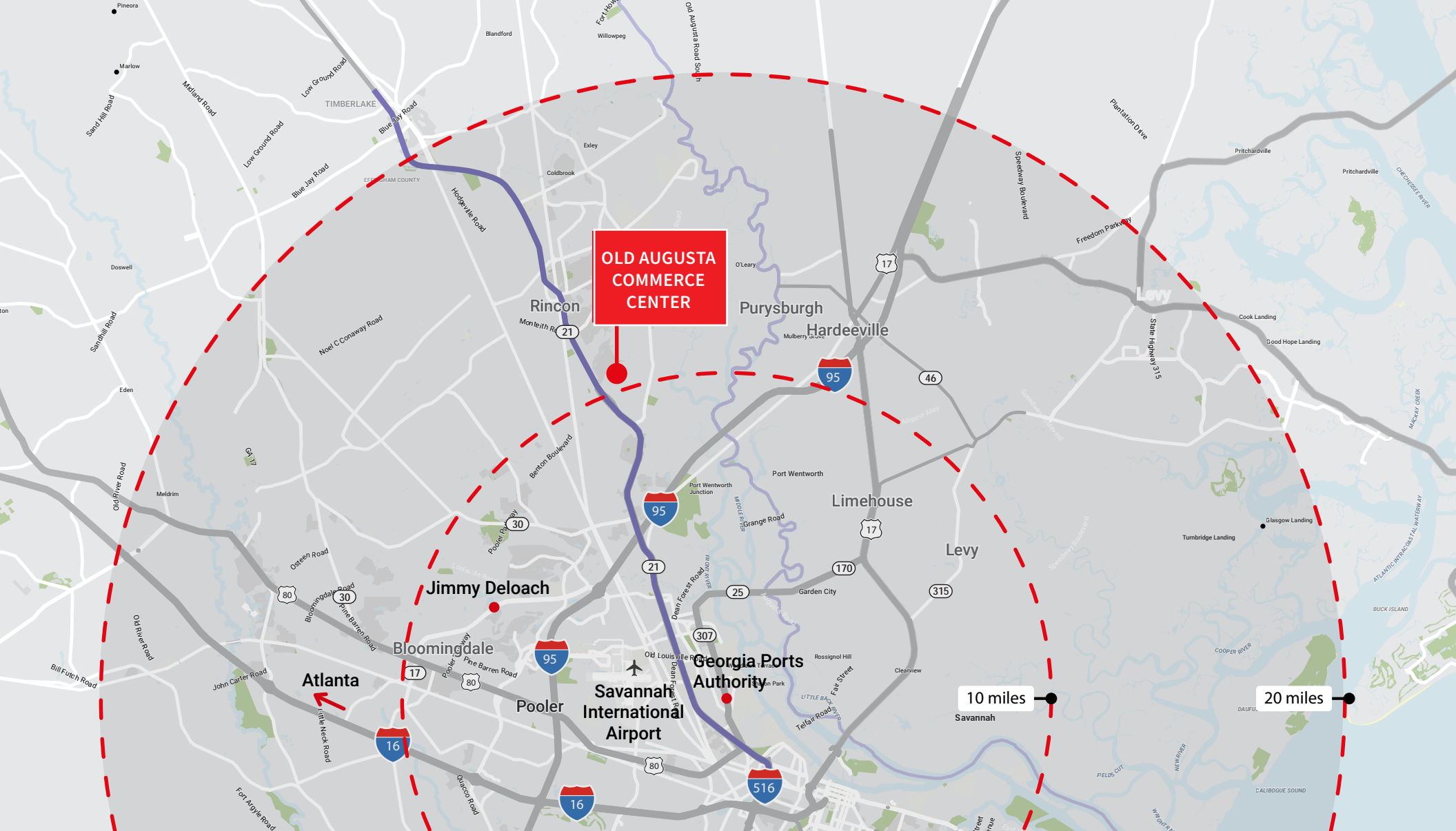

**240**  
miles from  
Atlanta



**7**  
miles from  
Jimmy Deloach  
Parkway



**10.8**  
miles from  
Georgia Ports  
Authority



**14.3**  
miles from  
I-16



**5**  
miles from  
I-95

Effingham County, Georgia offers the ideal location for **Old Augusta Commerce Center**, providing a strategic advantage for your business operations while fostering an environment where your workforce can flourish.



**+300,000**  
in labor force located  
within **45 minutes**



Median age  
**36.2**

**20,300+** of Effingham County's workforce leaves the county, providing an excellent opportunity to attract and capture local workers.

Little to no union presence within Effingham county's existing industry base.

*Source: JobsEQ, ESRI, 2020*



*View Effingham County's  
Economic profile  
in full here.*





# Neighboring Tenants





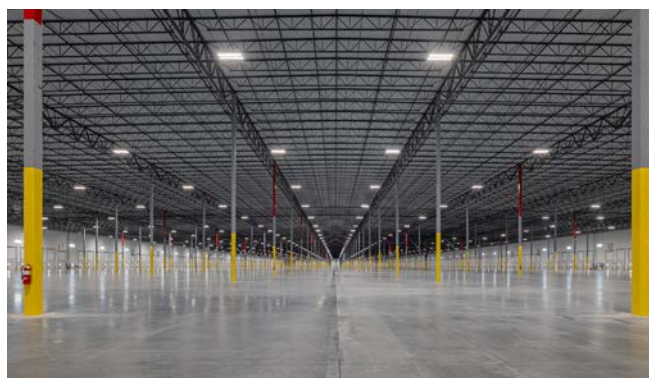

**Bennett Rudder, SIOR**  
Executive Managing Director  
JLL  
+1 912 250 4595  
bennett.rudder@jll.com

**Ryan Hoyt, SIOR**  
Executive Managing Director  
JLL  
+1 404 995 2090  
ryan.hoyt@jll.com

**Chris Tomasulo, SIOR**  
Vice Chairman  
JLL  
+1 404 995 2462  
chris.tomasulo@jll.com

**Lindsey Wilmot**  
Vice President  
JLL  
+1 912 663 9394  
lindsey.wilmot@jll.com



**Matt Neumann**  
Vice President - Leasing  
Becknell Industrial  
+1 708 571 0561  
mneumann@becknellindustrial.com

Although information has been obtained from sources deemed reliable, JLL does not make any guarantees, warranties or representations, express or implied, as to the completeness or accuracy as to the information contained herein. Any projections, opinions, assumptions or estimates used are for example only. There may be differences between projected and actual results, and those differences may be material. JLL does not accept any liability for any loss or damage suffered by any party resulting from reliance on this information. If the recipient of this information has signed a confidentiality agreement with JLL regarding this matter, this information is subject to the terms of that agreement. ©2024. Jones Lang LaSalle IP, Inc. All rights reserved.