

FOR SUBLEASE
41,185 SF



EASTPORT INDUSTRIAL PARK

EASTPORT IV, 5623 EASTPORT BLVD, HENRICO, VA 23231

CLASS A INDUSTRIAL - CROSS DOCK



**CUSHMAN &
WAKEFIELD**

THALHIMER

PROPERTY FEATURES

- FOR SUBLEASE** • **41,185 SF**
Suite 5623
- 4,958 SF Office
 - 9 docks with levelers
 - Cross dock
 - 27" clear height

Zoning:	M-2
Clear Height:	27' clear
Columns:	36' x 40'
Sprinkler:	ESFR
Lighting	LED



FOR SUBLEASE
Suite 5623 - 41,185 SF

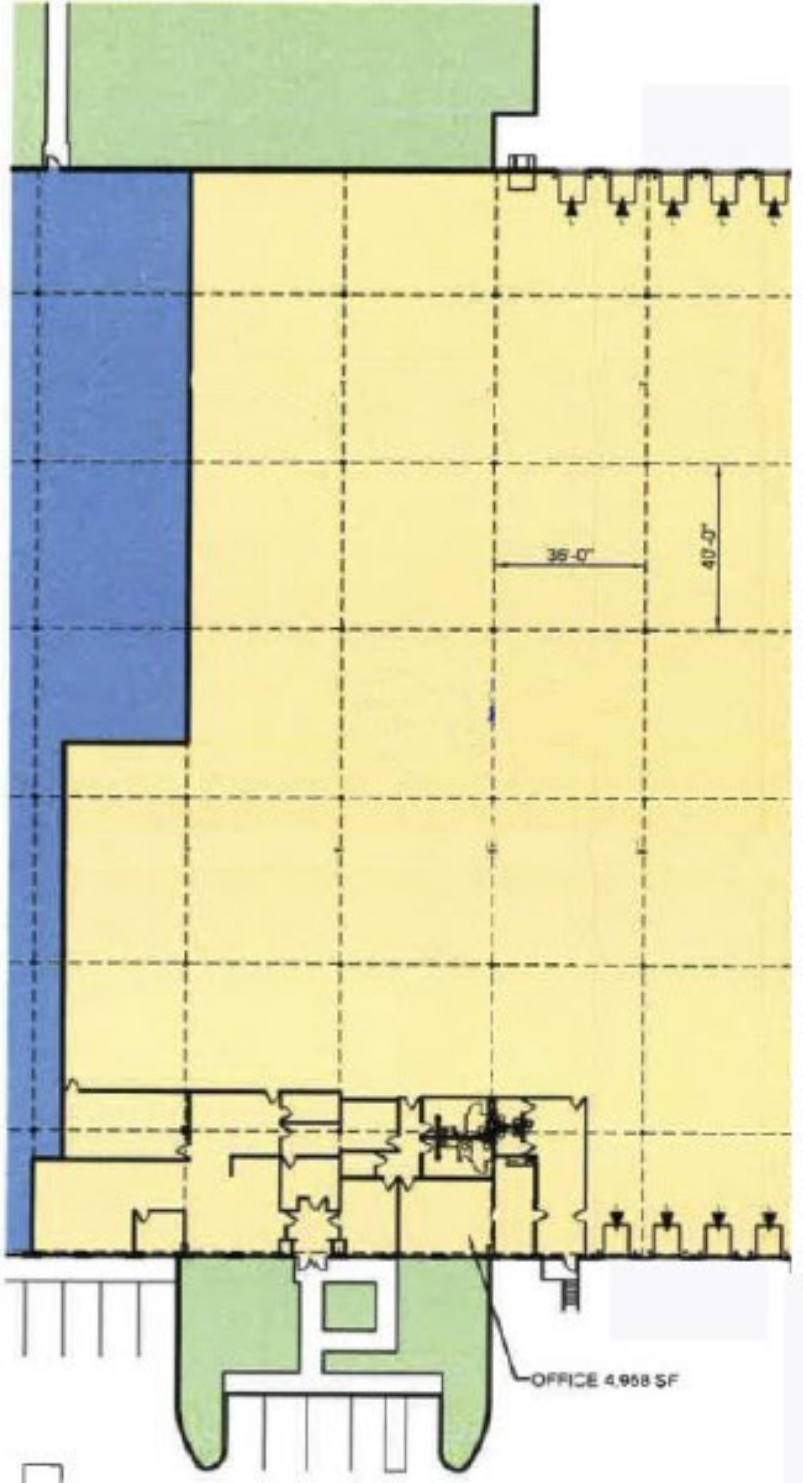

- LEGEND:**
- ▲ DOCK POSITION
 - ▲ DOCK POSITION W/LEVELER
 - △ FUTURE DOCK POSITION
 - ◆ DRIVE-IN DOOR
 - LAND

SITE PLAN
41,185 SF



LOCAL
ARIEAL

CONTACT INFORMATION

BRIAN FELTON

First Vice President

804 405 3369

brian.feltong@thalhimer.com



Thalhimer Center
11100 W. Broad Street
Glen Allen, VA 23060
thalhimer.com

Independently Owned and Operated / A Member of the Cushman & Wakefield Alliance

Cushman & Wakefield | Thalhimer © 2025. No warranty or representation, express or implied, is made to the accuracy or completeness of the information contained herein, and same is submitted subject to errors, omissions, change of price, rental or other conditions, withdrawal without notice, and to any special listing conditions imposed by the property owner(s). As applicable, we make no representation as to the condition of the property (or properties) in question.