

# FRANKLIN POINTE MEDICAL CENTER

26400 W. 12 MILE || SOUTHFIELD, MI

**\$2.00/SF**

Broker Bonus Commission  
for New Lease Signed



Institutionally Owned  
Medical Office Building



Abundant surface parking  
with easy access to multiple  
entrances



Exceptional location off  
Northwestern Highway  
and 12 Mile



Up to 15,946 SF continuous  
space available on the  
main floor



Generous Tenant  
Improvement Packages

**NEWMARK**

WADE LORIMER || 248-357-2508 || [wade.lorimer@nmrk.com](mailto:wade.lorimer@nmrk.com)

DANIEL CANVASSER || 248-350-8141 || [daniel.canvasser@nmrk.com](mailto:daniel.canvasser@nmrk.com)

JOHN EGAL || 248-871-2339 || [john.egal@nmrk.com](mailto:john.egal@nmrk.com)

# MAIN FLOOR

## AVAILABLE

- A** Suite 111-115 5,456 RSF

---

- B** Suite 117 1,210 RSF

---

- C** Suite 120 3,953 RSF

---

- D** Suite 140\* 7,647 RSF

---

- E** Suite 145\* 8,299 RSF

---

- F** Suite 150 7,174 RSF

---

- G** Suite 180 2,842 RSF

\* Suites 140 and 145 can be combined

## UNAVAILABLE

- A** Suite 110

---

- B** Suite 112

---

- C** Suite 160

---

- D** Suite 170

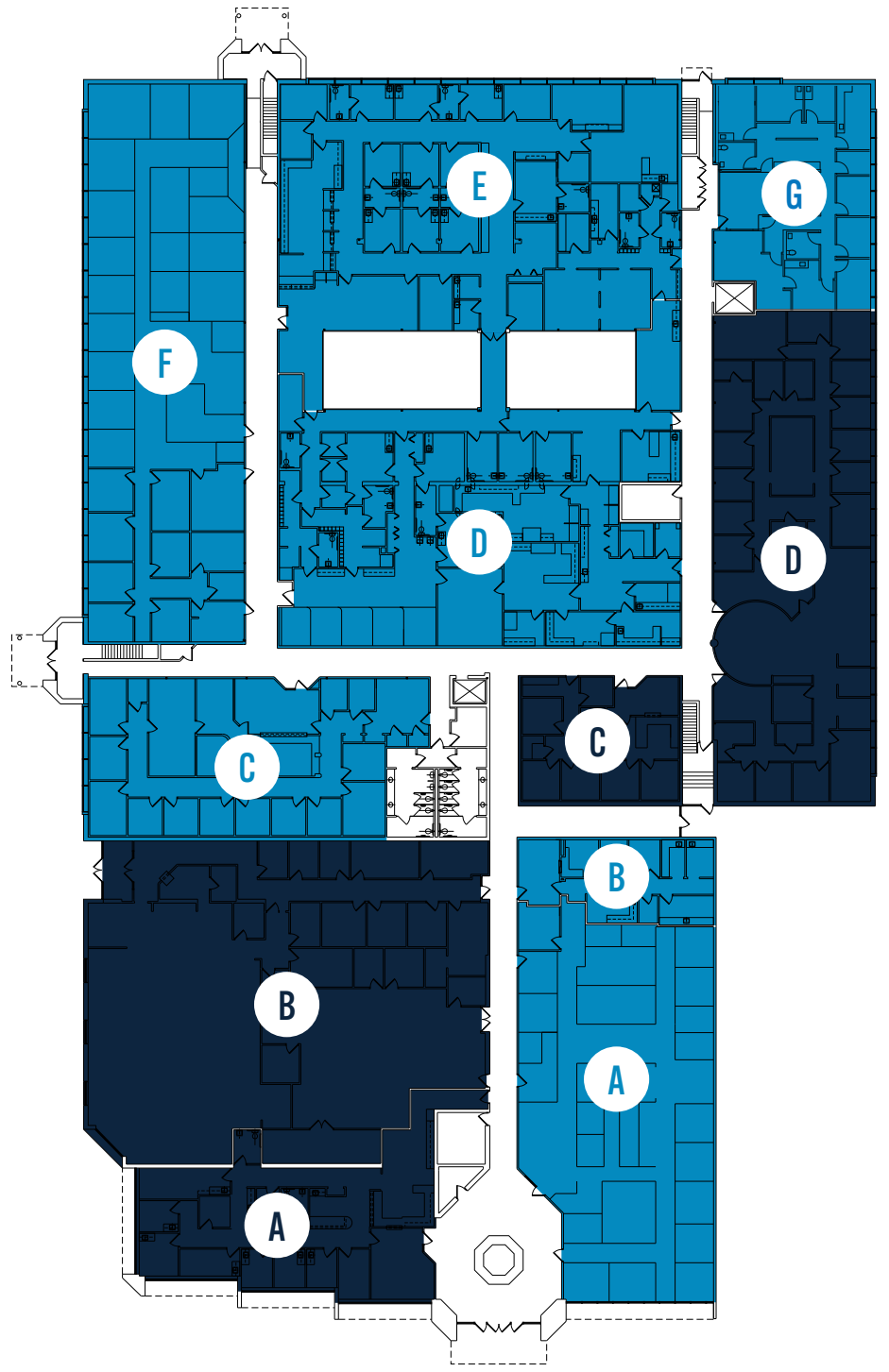

# LOWER FLOOR

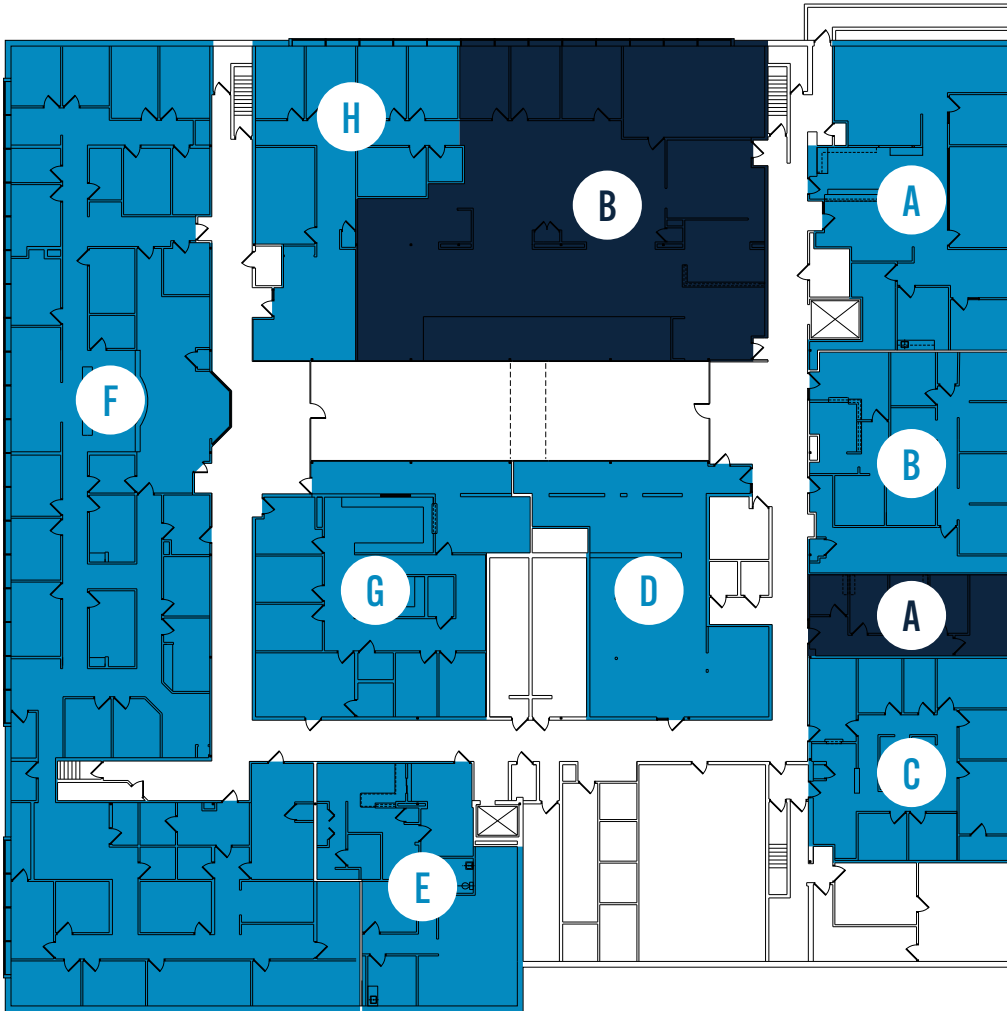

## AVAILABLE

<b>A</b>	Suite 5	2,732 RSF
<b>B</b>	Suite 10	2,223 RSF
<b>C</b>	Suite 20	2,025 RSF
<b>D</b>	Suite 30	2,052 RSF
<b>E</b>	Suite 40	1,912 RSF
<b>F</b>	Suite 60	10,658 RSF
<b>G</b>	Suite 70	2,911 RSF
<b>H</b>	Suite 80	2,278 RSF

## UNAVAILABLE

<b>A</b>	Suite 15
<b>B</b>	Suite 25

## BUILDING FEATURES

- 1,210 - 10,658 SF of Flexible Medical Office Suites Available
- Institutionally Owned Medical Office Building
- Abundant surface parking with easy access to multiple entrances
- Exceptional location off Northwestern Highway and 12 Mile
- Nearby easy Access to I-696, M-10, Telegraph Road and Southfield Freeway
- Newly renovated common area
- Generous Tenant Improvement Packages



Lobby



Corridor

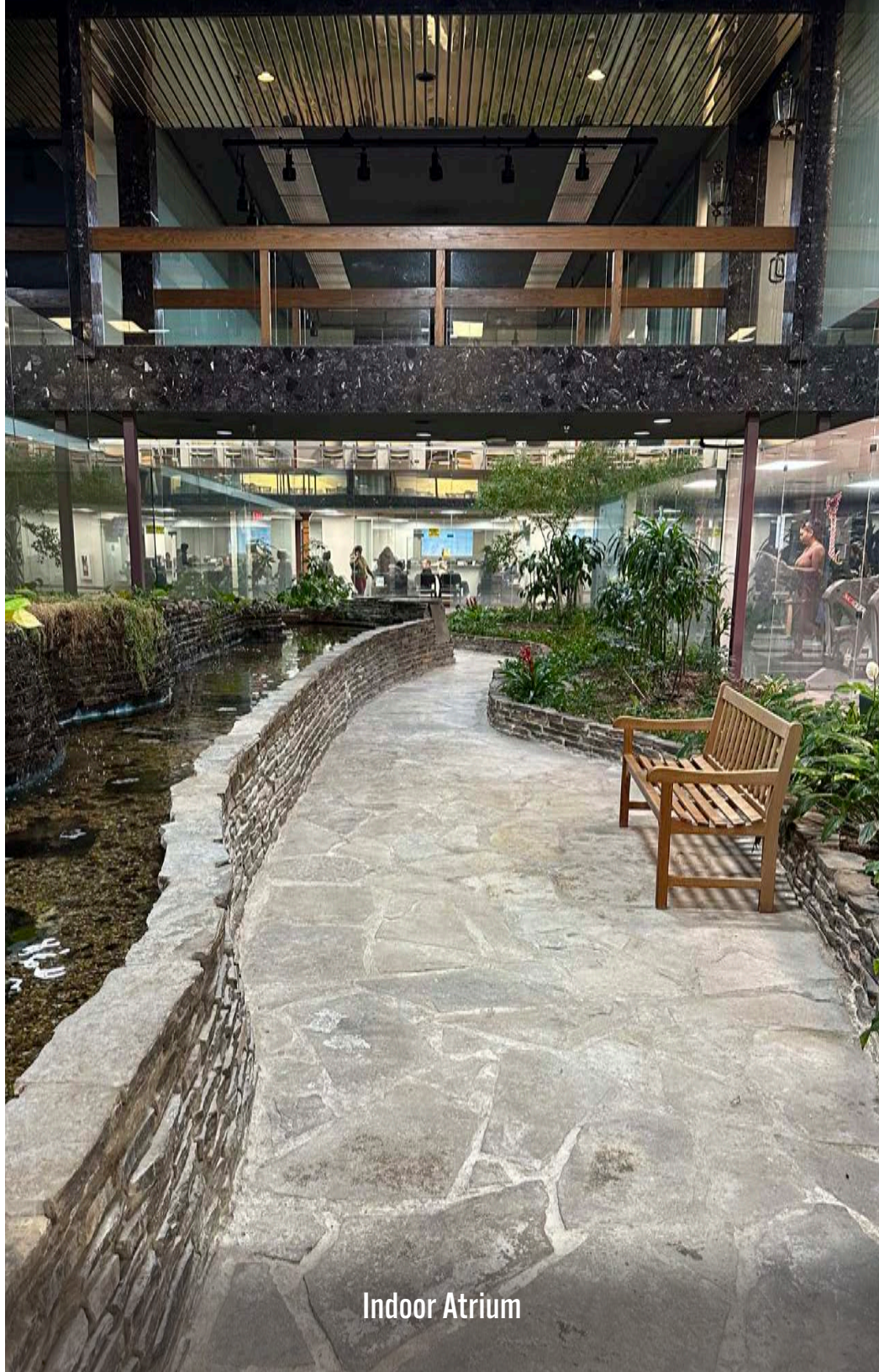

Indoor Atrium

# DEMOGRAPHICS



**191,058**  
Population



**81,534**  
Households



**\$93,272**  
Median Household Income



**\$357,992**  
Median Net Worth

**44.7**

Median Age



Apparel



Transportation



Health Care



Dining



Entertainment



Education

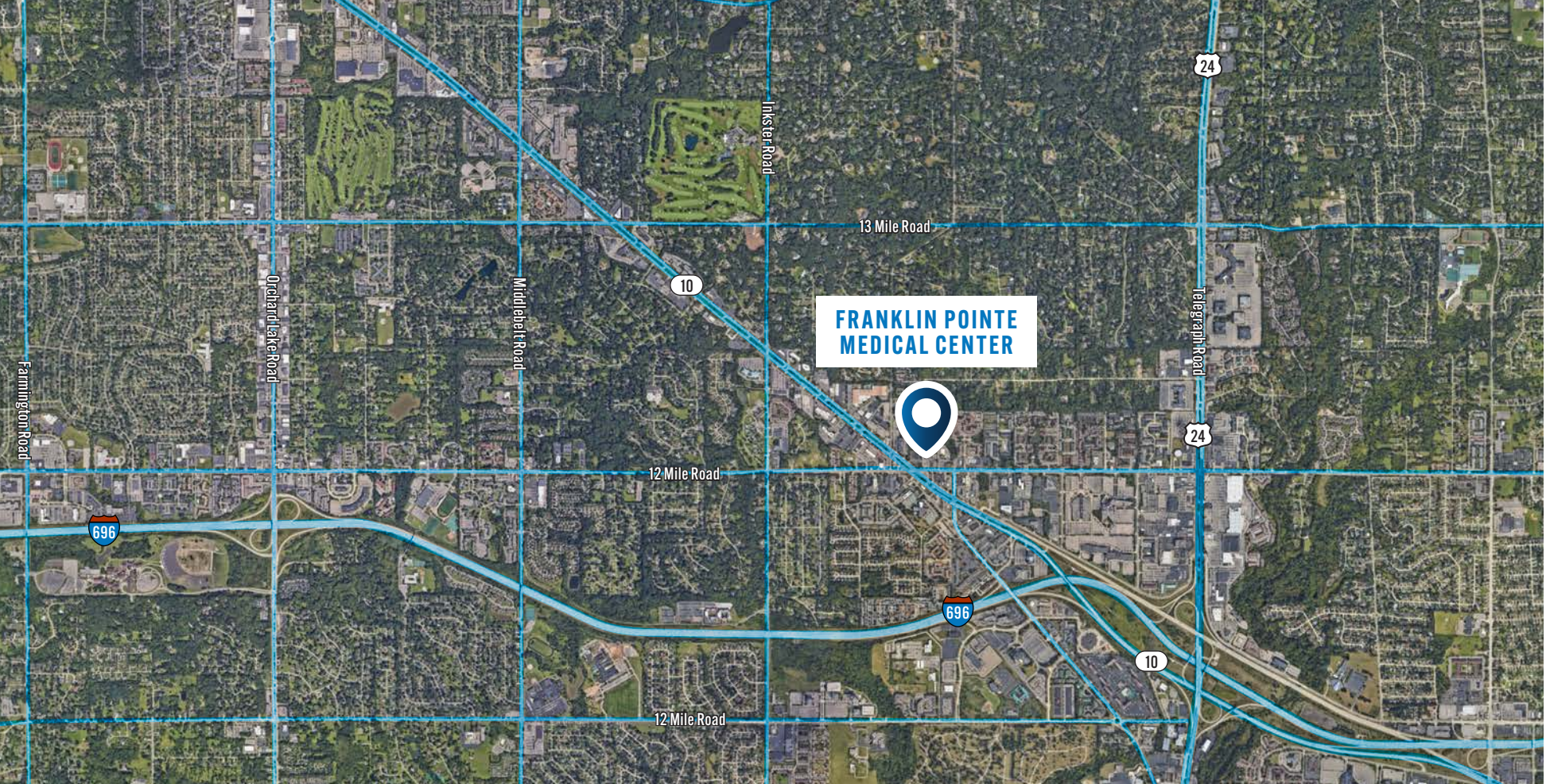
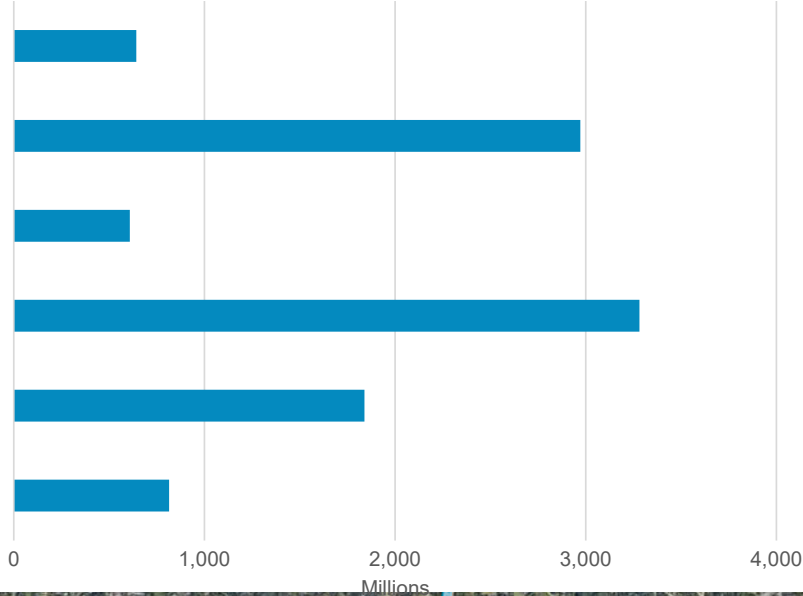



The information contained herein has been obtained from sources deemed reliable but has not been verified and no guarantee, warranty or representation, either express or implied, is made with respect to such information. Terms of sale or lease and availability are subject to change or withdrawal without notice.

**WADE LORIMER**  
248-357-2508  
wade.lorimer@nmrk.com

**DANIEL CANVASSER**  
248-350-8141  
daniel.canvasser@nmrk.com

**JOHN EAGAL**  
248-871-2339  
john.eagal@nmrk.com

**NEWMARK**