

sweeney

REAL ESTATE & APPRAISAL

LAND FOR DEVELOPMENT

NEW LONDON PRESERVE COVENTRY - RHODE ISLAND



One Turks Head Place, Suite 850 • Providence, Rhode Island 02903
T: 401.331.9300 • F: 401.331.9306 • www.sreari.com



JACKSON CAFFREY | [JCAFFREY@SREARI.COM](mailto:jcaffrey@sreari.com) | 401-331-9300 EXT. 212

NEW LONDON PRESERVE COVENTRY - RHODE ISLAND

DEMOGRAPHICS

Radius	Population	Average HH Income
3 Mile	46,040	\$97,383
5 Miles	98,311	\$106,910
10 Miles	276,632	\$105,346

MARKET AERIAL

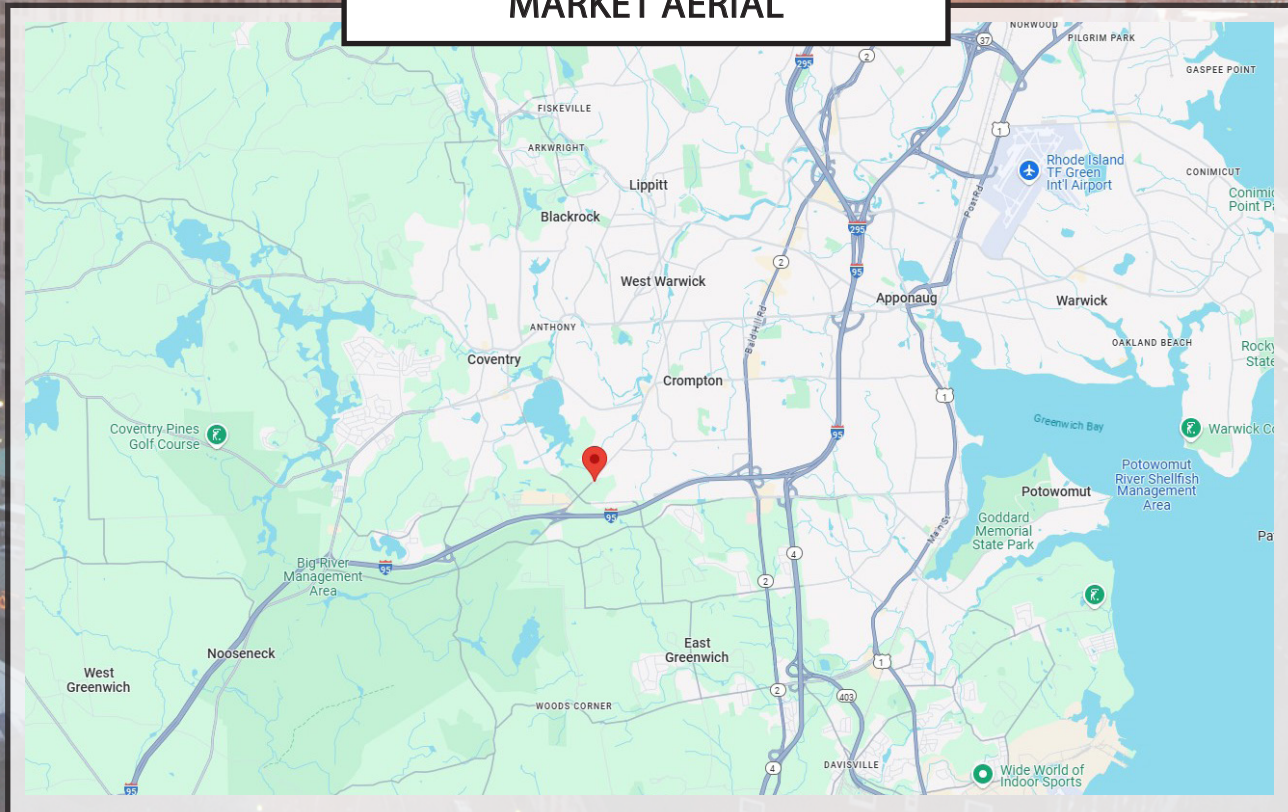

JACKSON CAFFREY | JCAFFREY@SREARI.COM | 401-331-9300 EXT. 212

NEW LONDON PRESERVE COVENTRY - RHODE ISLAND

PLAT 7, LOT 25 | PLAT 8, LOTS 2, 3 & 9 | PLAT 16, LOT 133

PROPERTY DETAILS

- 75 Single-Family Proposed Development Site with Multiple Approvals
- 53.88± Acres of Land
- Proposed Public Water & Sewer
- Two (2) Access Points via New London Turnpike & One (1) via Crompton Road
- Abuts East Greenwich Town Line
- Some Site Work Completed

CURRENT CONDITION



JACKSON CAFFREY | [JCAFFREY@SREARI.COM](mailto:jcaffrey@sreari.com) | 401-331-9300 EXT. 212

NEW LONDON PRESERVE COVENTRY - RHODE ISLAND

PROPOSED SUMMARY

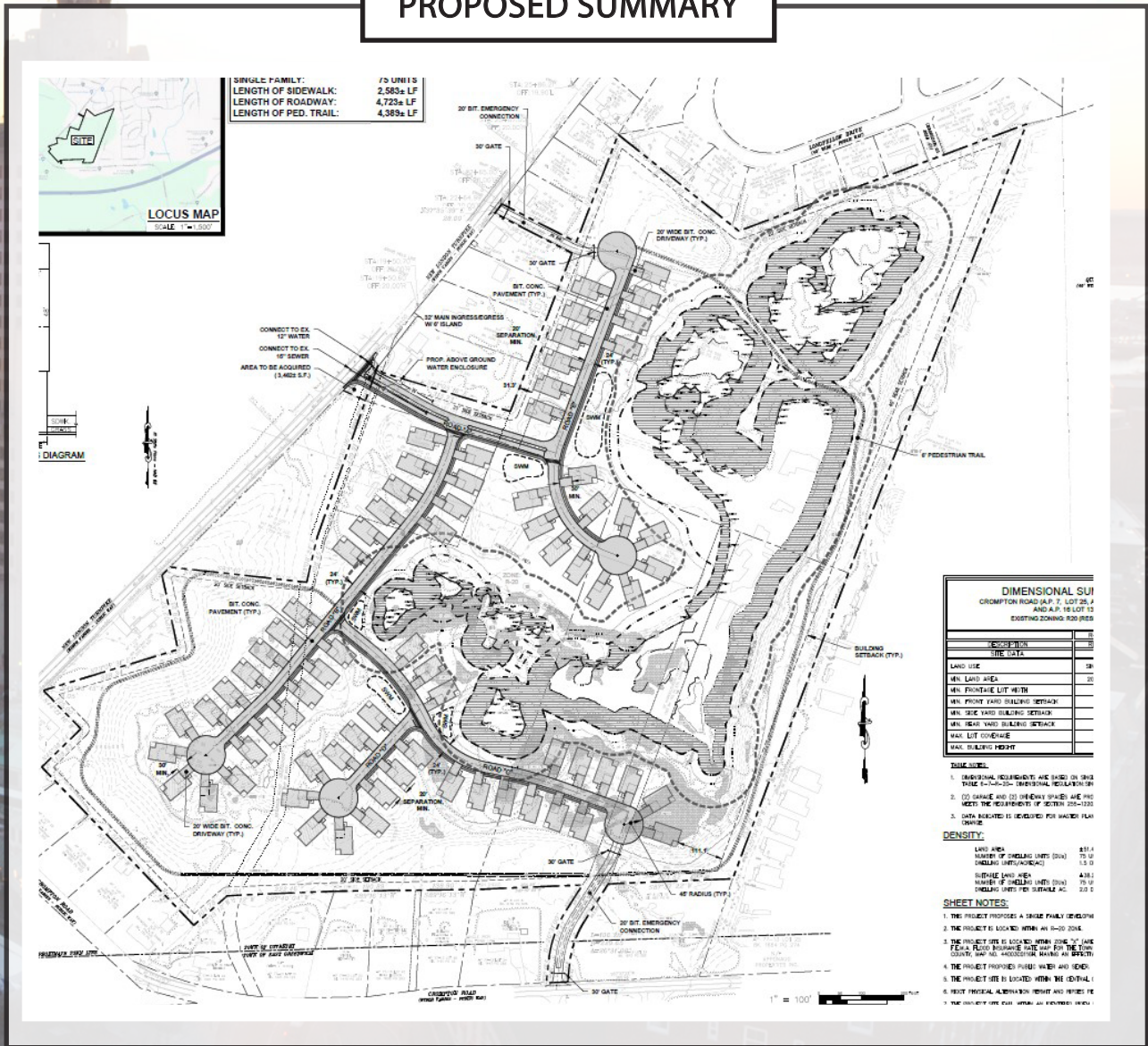

JACKSON CAFFREY | JCAFFREY@SREARI.COM | 401-331-9300 EXT. 212

All information furnished regarding property for sale, rental or financing is from sources deemed reliable. But no warranty or representation is made as to the accuracy thereof and same is submitted subject to errors, omissions, change or price, rental or other conditions, prior sale lease or financing or withdrawal without notice.