



FOR LEASE

Asking Rate:

\$28.00
PSF NNN

Contact us:

John Rowland

Brokerage | Arkansas
+1 501 804 2514
john.rowland@ar.colliers.com

Steven P. Lane

Managing Director | Arkansas
+1 479 366 6000
steve.lane@ar.colliers.com



Accelerating success.

3503 S 55th Street, Suite 200
Rogers, AR 72758
P: +1 479 636 9000
colliers.com/arkansas

800 SE Plaza

Bentonville, Arkansas

Property Amenities

- 2,900 to 5,847 square feet available
- 0.9 miles from Interstate 49
- Easy access to SE Walton Blvd
- Suitable for medical office or general office space
- Co-tenant include Northwest Arkansas Endodontic Specialists
- Constructed in 2019
- 1.5 miles from the new Walmart Home Office campus

Office space for lease in the heart of Bentonville, Arkansas. The building was constructed in 2019 with modern exterior finishes and anchored by Northwest Arkansas Endodontic Specialists. First generation shell space that can be divided into two suites. Adjacent to 49 West Apartments, SALT Health and direct access to the Razorback Greenway trail system. Area is filled with dense residential developments, retail and restaurants with an average annual household income of \$100,000+ within the immediate area.

Copyright © 2021 Colliers International.

Information herein has been obtained from sources deemed reliable, however its accuracy cannot be guaranteed. The user is required to conduct their own due diligence and verification.

PHOTOS



LOCATION

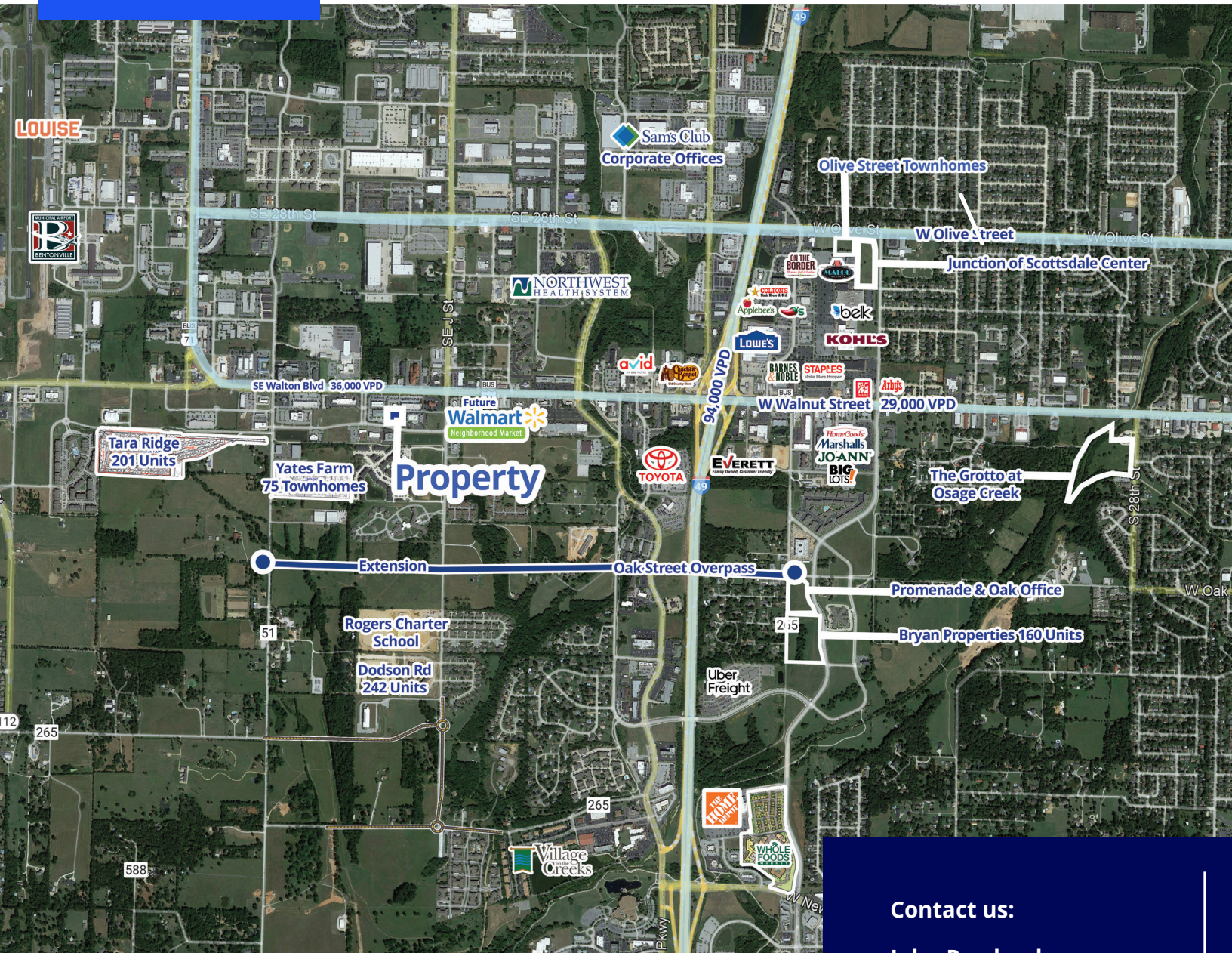

Demographics

	1 Mile	3 Mile	5 Mile
Population (2024)	4,095	54,084	136,194
Projected Population (2029)	4,723	60,770	150,343
Average HH Income (2024)	\$103,119	\$126,994	\$131,337
Proj. Average HH Income (2029)	\$110,788	\$141,764	\$147,203
Households (2024)	2,092	21,407	50,753

Copyright © 2021 Colliers International.

Information herein has been obtained from sources deemed reliable, however its accuracy cannot be guaranteed. The user is required to conduct their own due diligence and verification.

Contact us:

John Rowland

Brokerage | Arkansas
+1 501 804 2514
john.rowland@ar.colliers.com

Steven P. Lane

Managing Director | Arkansas
+1 479 366 6000
steve.lane@ar.colliers.com



3503 S 55th Street, Suite 200
Rogers, AR 72758
P: +1 479 636 9000
colliers.com/arkansas